



## 6 Bridge House Court Stone Row

, Skinningrove, TS13 4BF

**Offers in the region of £130,000**

A SPACIOUS GROUND FLOOR, MODERN BUILD ONE / TWO BEDROOM MAISONETTE SET WITHIN THIS RECENTLY BUILT DEVELOPMENT SET JUST OFF THE TRADITIONAL CENTRAL SQUARE OF SKINNINGROVE. THE PROPERTY COMES WITH ALLOCATED PARKING, AND IS WITHIN A MATTER OF MINUTES FROM THE BEACH AND NUMEROUS COUNTRYSIDE WALKS. THIS PROPERTY IS IDEAL FOR THE PURPOSES OF A SECOND HOME / HOLIDAY LET / INVESTMENT OR AS AN IMPRESSIVE AND SECURE HOME.

Beautifully presented throughout, the property has accommodation set over two storeys with in brief a spacious hall area ground floor single Bedroom, a downstairs .W.C. and a spacious Kitchen / Dining Room with a further double Bedroom, a Lounge and a Family Bathroom. The property is decorated to a good standard throughout.

- EXPECTED RENTAL INCOME OF £1,000 PER MONTH - Due to be listed for let imminently
- AN EVEN MORE LUCRATIVE INCOME AWAITS IF UTILISED AS AN AIR BNB / NIGHTLY RATE SET UP

### Viewing

Please contact our Progression Property Office on 01642 063352 if you wish to arrange a viewing appointment for this property or require further information.



2



2



1





Floor Plan

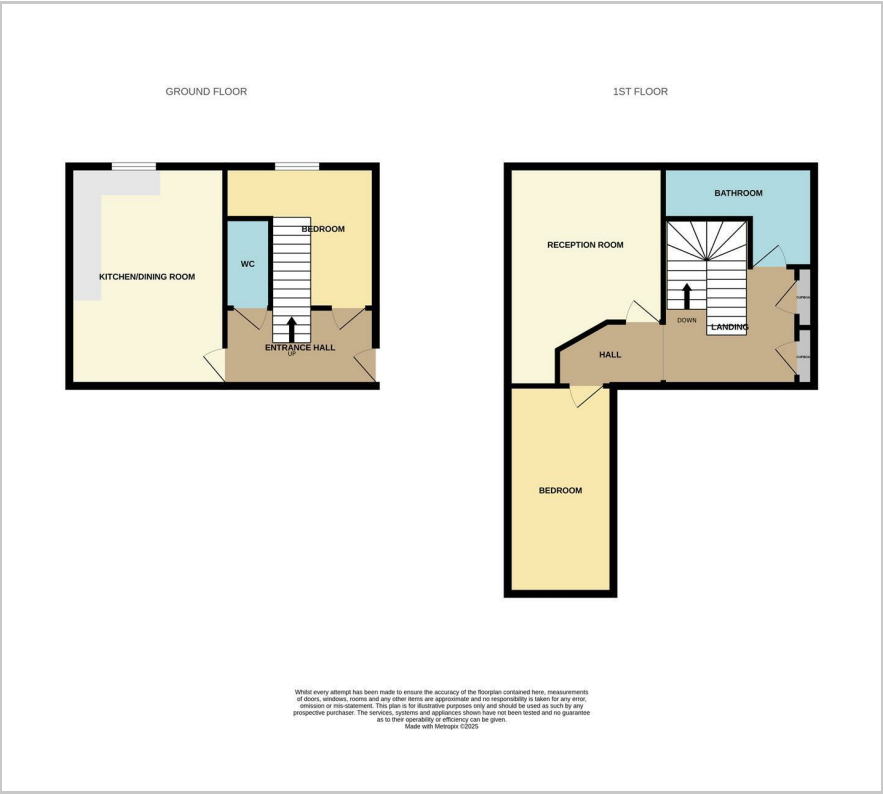

Area Map



Energy Efficiency Graph



These particulars, whilst believed to be accurate are set out as a general outline only for guidance and do not constitute any part of an offer or contract. Intending purchasers should not rely on them as statements of representation of fact, but must satisfy themselves by inspection or otherwise as to their accuracy. No person in this firms employment has the authority to make or give any representation or warranty in respect of the property.