



## 26 Longleat Avenue, Birmingham, B15 2EX

A simply STUNNING two bedroom apartment offering PANORAMIC City views. In the HEART of City Centre the property also benefits from NO UPWARDS CHAIN. \*\*Viewing recommended\*\* Property comprises of entrance hall, cloakroom, open plan kitchen lounge, kitchen area, two good sized bedrooms, en suite and shower room

**Offers In Excess Of £175,000**

# 26 Longleat Avenue

, Birmingham, B15 2EX



- BE PREPARED TO BE WOWED
- IDEAL INVESTMENT PROPERTY
- VIEWING ADVISED
- CALL TODAY
- TWO BEDROOMS
- CITY VIEWS
- NO UPWARD CHAIN
- TWO BATHROOMS
- ALLOCATED PARKING
- CURRENTLY RENT INCOME £13,200 P.A

ENTRANCE HALLWAY

BEDROOM ONE

EN SUITE

BEDROOM TWO

FAMILY BATHROOM

OPEN PLAN LOUNGE DINER

MODERN FITTED KITCHEN

LARGE BALCONY

FRONT ELEVATION

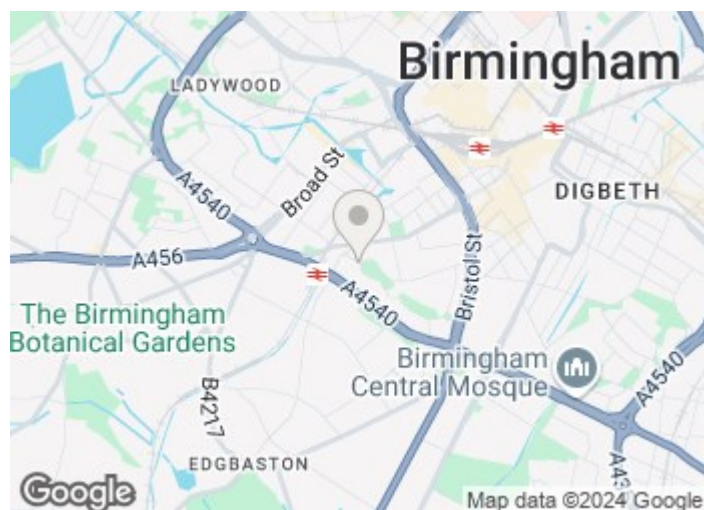

Directions



# Floor Plan

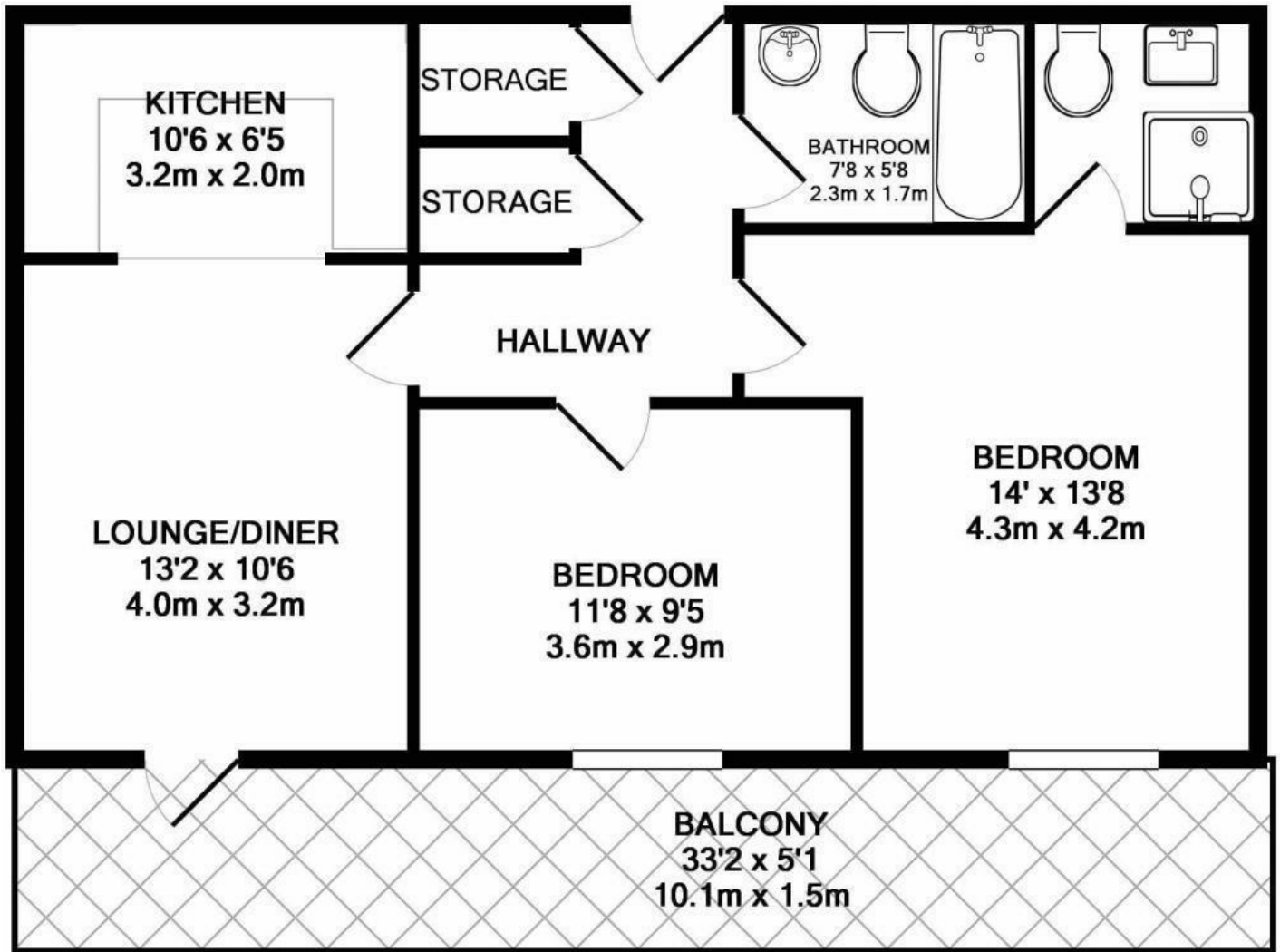

TOTAL APPROX. FLOOR AREA 642 SQ.FT. (59.7 SQ.M.)

Whilst every attempt has been made to ensure the accuracy of the floor plan contained here, measurements of doors, windows, rooms and any other items are approximate and no responsibility is taken for any error, omission, or mis-statement. This plan is for illustrative purposes only and should be used as such by any prospective purchaser. The services, systems and appliances shown have not been tested and no guarantee as to their operability or efficiency can be given

Made with Metropix ©2019

These particulars, whilst believed to be accurate are set out as a general outline only for guidance and do not constitute any part of an offer or contract. Intending purchasers should not rely on them as statements of representation of fact, but must satisfy themselves by inspection or otherwise as to their accuracy. No person in this firm's employment has the authority to make or give any representation or warranty in respect of the property.

