

32 St. James Road, Leicester, LE2 1HQ

Rent My Home proudly offer to the market for rent this **STYLISH STUDIO APARTMENT** located on St James Road, off London Road, Leicester, LE2. Available to view NOW, and move in from NOW, viewing is not to be missed on this stunning property!

This ground floor apartment briefly comprises of an open plan bedroom/lounge, a separate fitted kitchen with white appliances included and a stylish fitted bathroom suite with bathtub and overhead shower.

St. James Road is located close by to the popular London Road and Victoria Park areas as well as having great transport links into and out of Leicester City Centre and Leicester Train Station so is ideal for working professionals or students.

Rent £650.00pcm
Deposit £750.00

£625 PCM

32 St. James Road

, Leicester, LE2 1HQ



- *** STUNNING STUDIO APARTMENT ***
- Stylish Fitted Bathroom Suite
- Located Close to London Road and Victoria Park
- Available from NOW
- Spacious Open Plan Bedroom/Lounge
- Good Quality Heating Installed Throughout
- Public Transport Accessible
- Separate Fitted Kitchen with White Appliances
- Double Glazed Windows
- Viewing Highly Recommended

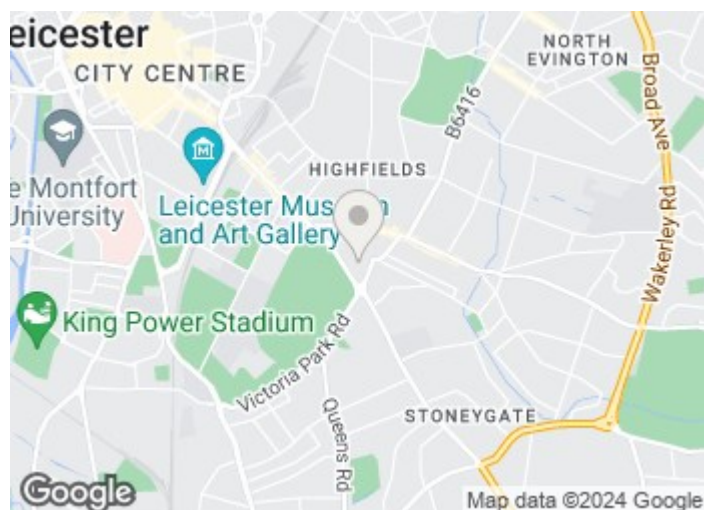

Directions



Ground Floor

Approx. 26.0 sq. metres (280.2 sq. feet)

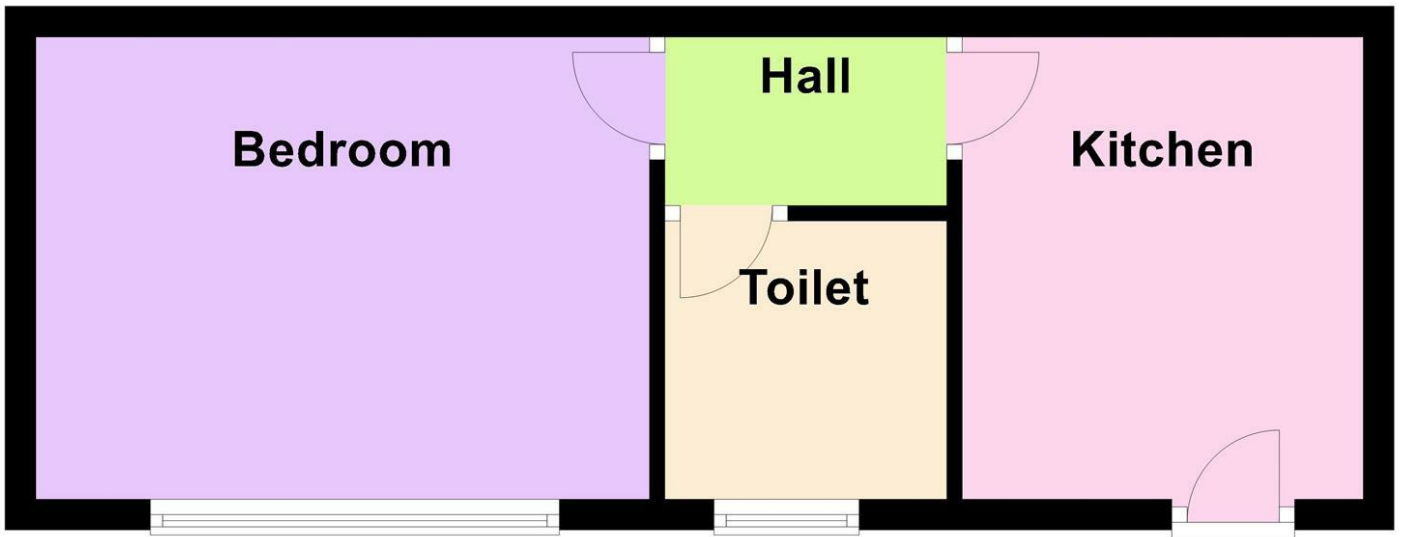

Total area: approx. 26.0 sq. metres (280.2 sq. feet)

These particulars, whilst believed to be accurate are set out as a general outline only for guidance and do not constitute any part of an offer or contract. Intending purchasers should not rely on them as statements of representation of fact, but must satisfy themselves by inspection or otherwise as to their accuracy. No person in this firm's employment has the authority to make or give any representation or warranty in respect of the property.

