



40 Westleigh Road, Leicester, LE3 0HH

Rent My Home proudly offer this spacious ONE BEDROOM APARTMENT located on Westleigh Road, Leicester, LE3. This property is available to view NOW, and move in from 1st July 2025, so call Rent My Home to arrange your booking today!

This first floor apartment briefly comprises of an entrance hallway, a large open plan lounge/kitchen, a spacious double bedroom and a stylish fitted bathroom suite with bathtub and overhead shower.

There will also be a fridge/freezer, a washing machine, an integrated electric oven with hob, a double bed with mattress and a built-in wardrobe offered within this property so will be part furnished throughout.

This apartment also benefits from high quality electric storage heaters, good quality external wall insulation and double glazed windows.

Internal viewing is not to be missed so call Rent My Home today on 0116 229 1021 for further information or to book your viewing! Virtual Tour available upon request.

£725 PCM

40 Westleigh Road

, Leicester, LE3 0HH



- *** ATTRACTIVE ONE BEDROOM APARTMENT ***
- Stylish Fitted Bathroom Suite
- On Street Parking Available
- Zero Deposit Option Available
- Large Open Plan Lounge/Kitchen
- High Quality Electric Storage Heaters Fitted
- Close to all Local Amenities
- Spacious Double Bedroom
- Double Glazed Windows
- Available from 1st July 2025

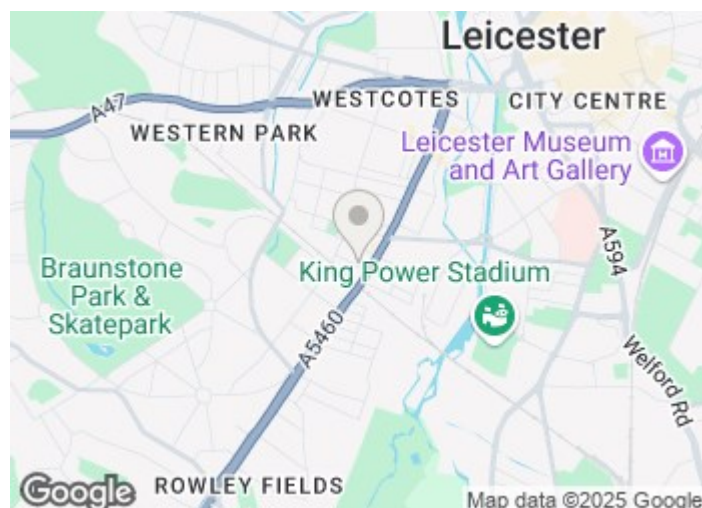

Directions



Floor Plan

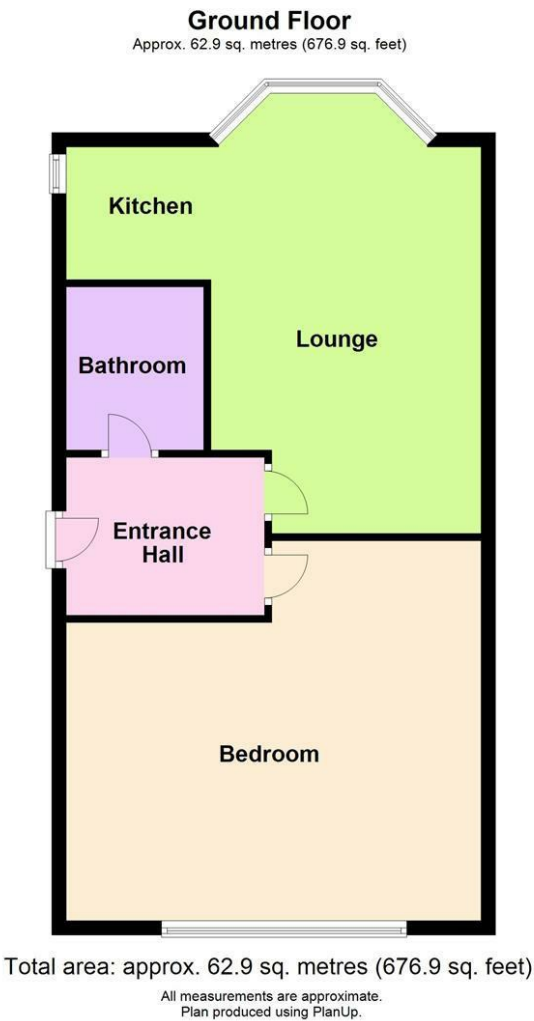

These particulars, whilst believed to be accurate are set out as a general outline only for guidance and do not constitute any part of an offer or contract. Intending purchasers should not rely on them as statements of representation of fact, but must satisfy themselves by inspection or otherwise as to their accuracy. No person in this firms employment has the authority to make or give any representation or warranty in respect of the property.

