

212a Narborough Road, Leicester, LE3 2AN

STUDIO FLAT to rent at the heart of Narborough Road.

This development of 6 studio apartments has recently been completed. This studio flat comprises a spacious open plan kitchen integrated with the living area and modern 3 piece shower room. The flats will be supplied with white goods (cooker/oven, fridge/ freezer, washer/ dryer) and furnishings. Located on the vibrant Narborough Road, the flat allows easy access to restaurants, pubs, local amenities and is within close proximity to the transport links that take you to the city center and the popular Fosse Park.

Available to move in straight away!

£625

212a Narborough Road

, Leicester, LE3 2AN

 0

 1

 1

 D

- Studio Flat
- Great Location
- Available Now



Directions



Floor Plan

Ground Floor
Approx. 35.8 sq. metres (385.0 sq. feet)

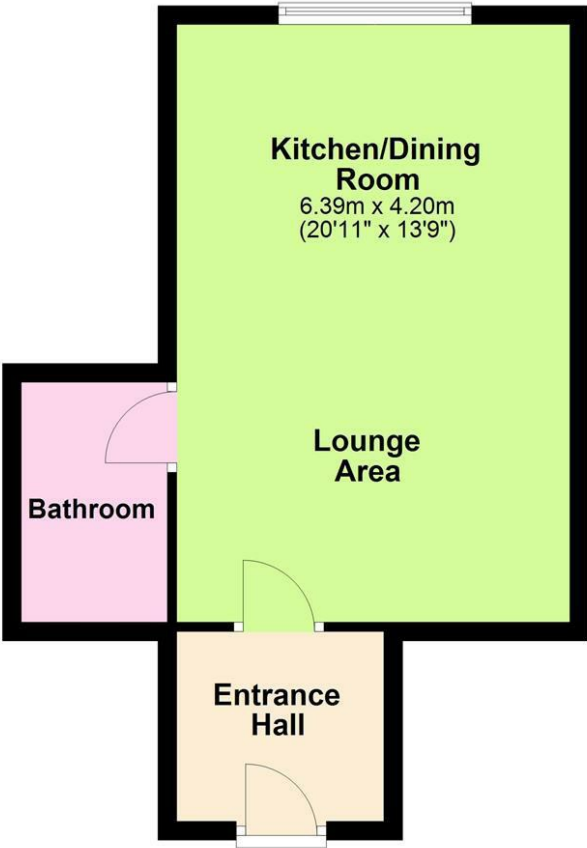

Total area: approx. 35.8 sq. metres (385.0 sq. feet)

These particulars, whilst believed to be accurate are set out as a general outline only for guidance and do not constitute any part of an offer or contract. Intending purchasers should not rely on them as statements of representation of fact, but must satisfy themselves by inspection or otherwise as to their accuracy. No person in this firms employment has the authority to make or give any representation or warranty in respect of the property.

