



## VM2 Salts Mill Road, Shipley, BD17 7DD

Spacious one bedroom apartment available on the market, located on Salts Mill Road, BD17.

The property comprises in brief, open plan lounge/kitchen with integrated fridge/ freezer, cooker oven and free standing washing machine, bedroom and shower room. The property benefits from a parking space located in a secure multi-storey car park, intercom entry phone system and beautiful communal gardens.

The award winning and popular 'Victoria Mills' complex is set alongside River Aire on the outskirts of Shipley, within easy access into the Town centre, Saltaire and Baildon and walking distance to the local train stations providing regular services into Leeds and Bradford.

NOTE. This is an unfurnished property; The furniture photos are for illustrative purposes only.

Available from 1st May 2025

**£700 PCM**

# VM2 Salts Mill Road

, Shipley, BD17 7DD



- SPACIOUS ONE BEDROOM APARTMENT
- MODERN STANDARD
- PARKING SPACE
- BEAUTIFUL COMMUNAL GARDENS
- CLOSE TO TRAIN STATION
- AVAILABLE FROM 1ST MAY 2025
- NOTE. This is an unfurnished property; The furniture photos are for illustrative purposes only.



Directions





Floor Plan

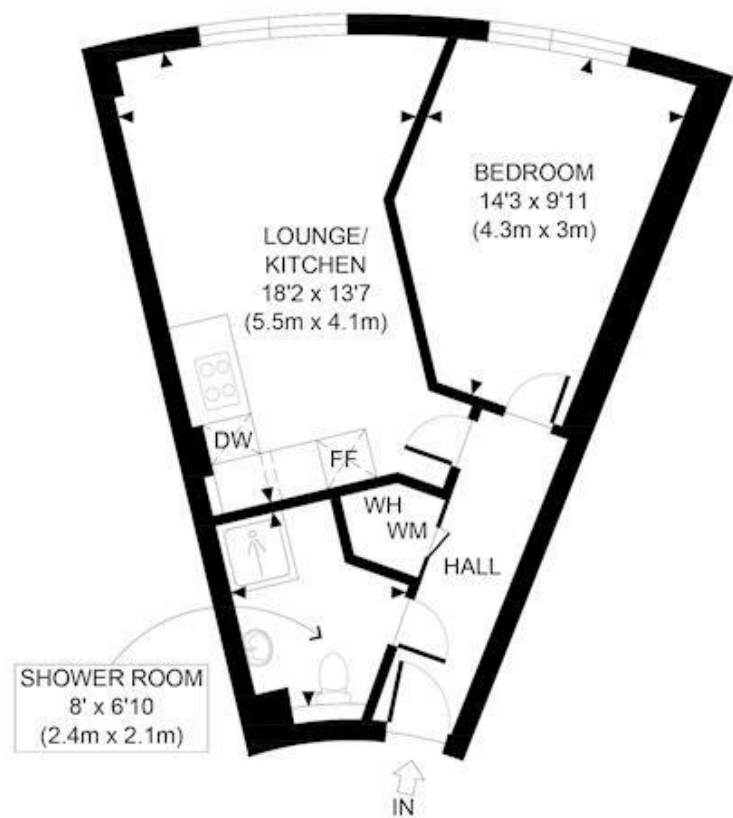

GROSS INTERNAL  
FLOOR AREA 432 SQ FT

<p>APPROX. GROSS INTERNAL FLOOR AREA 432 SQ FT / 40 SQM</p> <p>Disclaimer: Floor plan measurements are approximate and are for illustrative purposes only. While we do not doubt the floor plan accuracy and completeness, you or your advisors should conduct a careful, independent investigation of the property in respect of monetary valuation</p>	<p>Salts Mill Road</p> <p>date 05/07/21</p> <p>photoplan </p>
--	---

These particulars, whilst believed to be accurate are set out as a general outline only for guidance and do not constitute any part of an offer or contract. Intending purchasers should not rely on them as statements of representation of fact, but must satisfy themselves by inspection or otherwise as to their accuracy. No person in this firms employment has the authority to make or give any representation or warranty in respect of the property.

