



44 Broadlands, Desborough, Kettering, NN14 2TH





**£320,000**

Stuart Charles are delighted to offer for sale this rarely available THREE bedroom detached bungalow located a popular area of Desborough. Being situated walking distance to several local schools and shops an early viewing is recommended to avoid missing out on this home. The accommodation on offer comprises of a porch, a large open plan lounge diner, a kitchen, three piece bathroom and an inner hall that leads you to the three good size bedrooms. The third bedroom leads to the conservatory and the back of the garage which has been partial converted for storage. To the front there is a driveway leading to the garage and laid lawn with gated access to the rear. To the rear is a large wrap around garden with a mixture of laid lawn and established shrubs and bushes, all surrounded by timber fence surround. To the rear there is also a double garage with power and lights and an additional driveway. Call now to book a viewing!!

- LARGE PLOT
- COUNTRYSIDE ON YOUR DOORSTEP
- PRIVATE GARDEN
- CONSERVATORY
- GOOD TRANSPORT LINKS
- TWO GARAGES
- LOUNGE DINER
- CLOSE TO LOCAL AMENITIES
- SAUNA INCLUDED

#### **Entrance Porch**

Entered via a double glazed door to the front elevation, double glazed window to the side elevation, door to:

#### **Lounge/Diner**

18'4 x 12'3 (5.59m x 3.73m)

Double glazed windows to the front elevation, feature fire place, two radiators, doors to:

#### **Kitchen**

9'10 x 8'8 (3.00m x 2.64m)

Fitted to comprise a range of base and eye level units with a sink and drainer, free standing cooker, double electric oven, space for free standing fridge/freezer, space for washing machine, radiator, double glazed window to front.

#### **Inner Hall**

Doors to the bedrooms, bathroom and large airing cupboard.













### Bedroom One

11'7 x 10'10 (3.53m x 3.30m)

Double glazed window to the rear elevation, fitted wardrobes, radiator.

### Bedroom Two

11' x 9'5 (3.35m x 2.87m)

Double glazed window to the rear elevation, radiator.

### Bedroom Three

8'7 x 7' (2.62m x 2.13m)

### Conservatory

11'5 x 8' (3.48m x 2.44m)

Brick built base, power and lights, radiator, double glazed windows and French doors to side.









## Bathroom

6'5 x 6'4 (1.96m x 1.93m)

Fitted to comprise a three piece suite featuring a low level bath, low level pedestal, low level wash hand basin, radiator, double glazed window to side elevation.

## Outside

















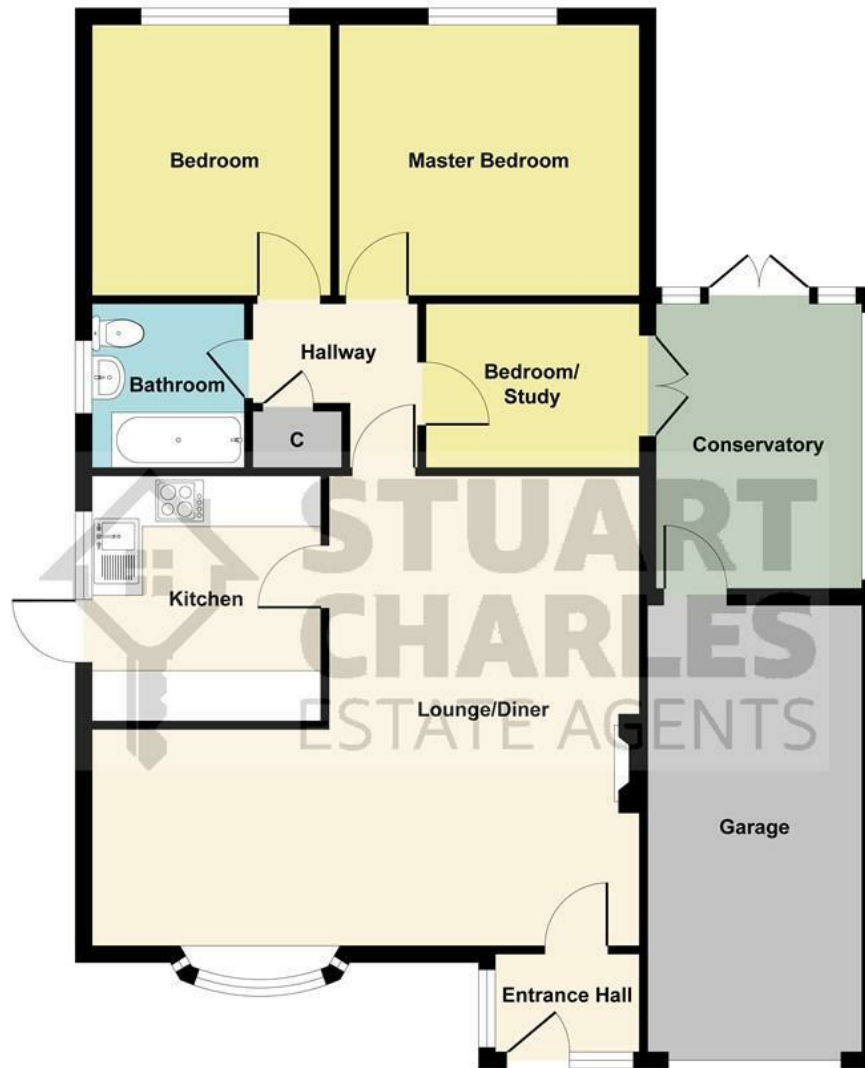

Floor Plan

Produced by Elements Property

Illustration for identification purposes only, measurements are approximate, not to scale.



