

Property ref: 46802

Eldon Lodge, Reading, RG1 4NH

£1,150 PCM

HASLAMs
Lettings



An impressive, unfurnished, newly redecorated one bedroom apartment situated within a grade II listed building in the Eldon Square Conservation Area.

Reading Borough Council tax band B.

Water supply: Mains

Drainage info: Mains

Electricity supply: Mains

Gas supply: Mains

Broadband/Mobile Info: Connections available. For an indication of specific speeds and supply of Broadband and Mobile, we advise applicants go to the Ofcom website Broadband and Mobile Coverage Checker.

- Double bedroom with large built-in wardrobe
- Newly redecorated, well fitted kitchen with integrated appliances
- Full bathroom suite including separate shower; Large linen/ storage cupboard
- Allocated parking; Impressive communal areas and secure electric gated access
- Gas central heating; EPC rating D
- Unfurnished; Managed by HASLAMs

Available Now

*Fees For Assured Shorthold Tenancies: when you rent a property from us you will be required to pay a sum equivalent to one weeks' rent for a holding deposit. Upon successful application, this amount will be off set against your first months' rent. You will also be required to pay a security deposit equivalent to 5 weeks' rent which will be held and protected in line with Deposit legislation. For more information about our fees please visit: www.haslamss.net
Fees for all other tenancies (Non Housing Act Tenancies / Company Lets): when you rent a property from us we will charge you a one-off fee per property. This charge is the equivalent of 15 days of the monthly rental charge (+VAT) with a minimum fee of £450 (inc.VAT) up to a maximum of £650 (inc.VAT). Other fees may apply depending on your circumstances.

0118 960 1055

lettings@haslamss.net www.haslamss.net

Haslamss Estate Agents Ltd, 159 Friar Street, Reading, Berkshire, RG1 1HE



Kings Road, Reading, RG1

Approximate Area = 504 sq ft / 46.8 sq m

For identification only - Not to scale

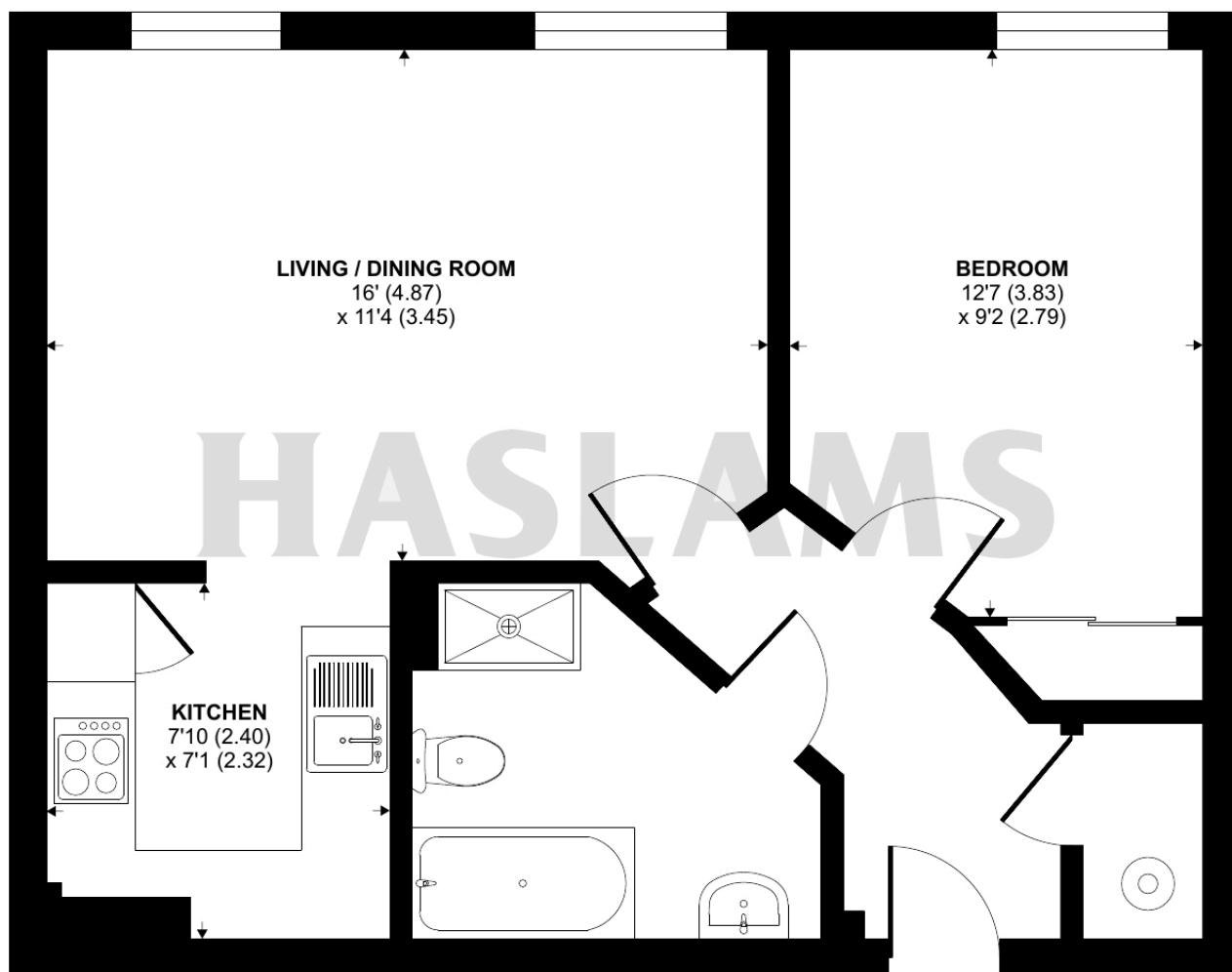
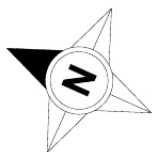
**SECOND FLOOR**

Floor plan produced in accordance with RICS Property Measurement 2nd Edition, Incorporating International Property Measurement Standards (IPMS2 Residential). © n̄che.com 2025. Produced for Haslams. REF: 1360399