

Property ref: 146346

Kings Oak Court, Reading, RG1 4PX

£1,500 PCM

HASLAM'S
Lettings



A very well presented two bedroom ground floor apartment is situated in a sought after development in the centre of Reading. Located within a short walk of the River Kennet providing pleasant riverside walks to the Oracle development and the vibrant town centre with its mainline station.

Reading Borough Council tax band D.

Available 18/08/2025

- Two double bedrooms
- Living room overlooking communal garden
- Fitted kitchen with appliances
- Allocated parking; EPC rating C
- Family bathroom; Electric heating
- Furnished; Managed by LANDLORD

*Fees For Assured Shorthold Tenancies: when you rent a property from us you will be required to pay a sum equivalent to one weeks' rent for a holding deposit. Upon successful application, this amount will be off set against your first months' rent. You will also be required to pay a security deposit equivalent to 5 weeks' rent which will be held and protected in line with Deposit legislation. For more information about our fees please visit: www.haslams.net
Fees for all other tenancies (Non Housing Act Tenancies / Company Lets): when you rent a property from us we will charge you a one-off fee per property. This charge is the equivalent of 15 days of the monthly rental charge (+VAT) with a minimum fee of £450 (inc.VAT) up to a maximum of £650 (inc.VAT). Other fees may apply depending on your circumstances.

0118 960 1055

lettings@haslams.net www.haslams.net

Haslams Estate Agents Ltd, 159 Friar Street, Reading, Berkshire, RG1 1HE

Water supply: Mains

Drainage info: Mains

Electricity supply: Mains

Broadband/Mobile Info: Connections available. For an indication of specific speeds and supply of Broadband and Mobile, we advise applicants go to the Ofcom website Broadband and Mobile Coverage Checker.





Queens Road, Reading, RG1

Approximate Area = 507 sq ft / 47.1 sq m

For identification only - Not to scale

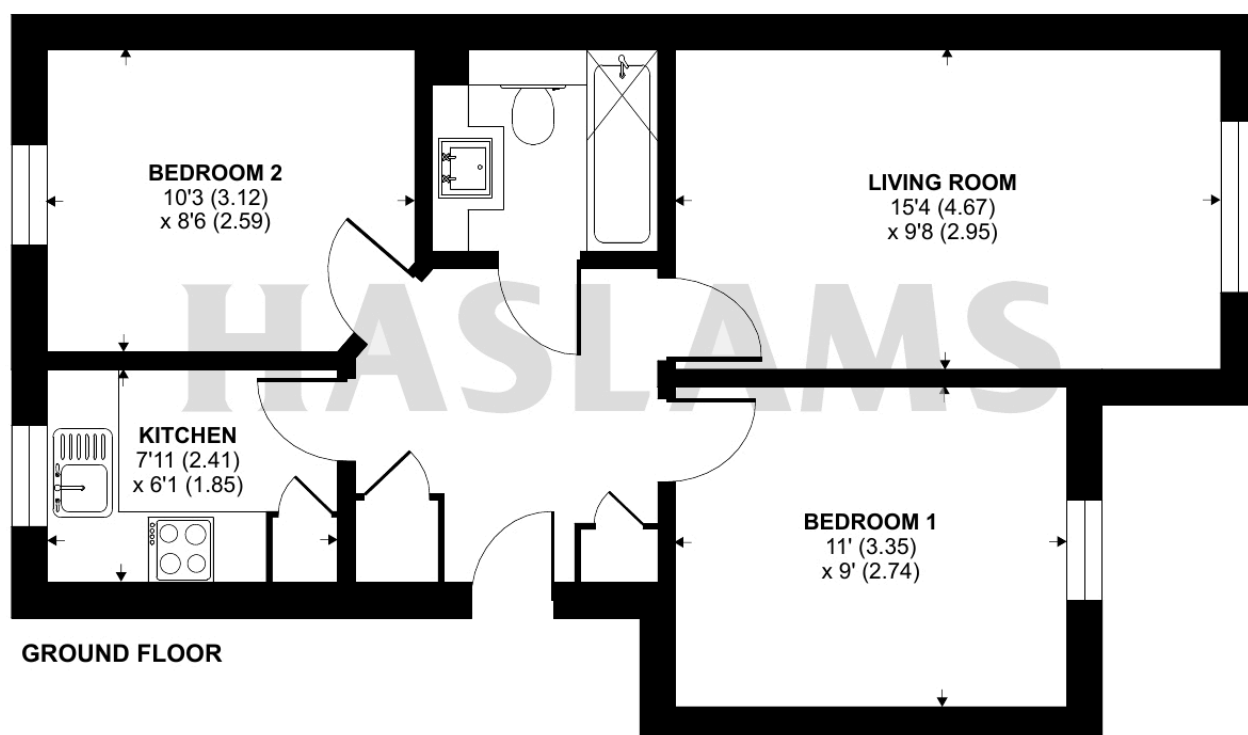

Floor plan produced in accordance with RICS Property Measurement Standards incorporating International Property Measurement Standards (IPMS2 Residential). © n1cheom 2022. Produced for Haslams. REF: 890180