

Property ref: 624

Upcross Gardens, Reading, RG1 6HY

£1,400 PCM

HASLAMs
Lettings



A well planned and spacious two bedroom, second floor apartment located within the Upcross Gardens development on the western outskirts of Reading town centre.
Reading Borough Council tax band C.
Water supply: Mains
Drainage info: Mains
Electricity supply: Mains
Gas supply: Mains
Broadband/Mobile Info: Connections available. For an indication of specific speeds and supply of Broadband and Mobile, we advise applicants go to the Ofcom website Broadband and Mobile Coverage Checker.

- Spacious open-plan living area; Gas central heating
- Kitchen with a comprehensive range of integrated appliances
- Master bedroom which has a built-in wardrobe and en-suite shower room
- Further double bedroom; Family shower room
- Allocated undercroft parking; EPC Rating C
- Furnished; Managed by HASLAMs

Available 08/07/2025

*Fees For Assured Shorthold Tenancies: when you rent a property from us you will be required to pay a sum equivalent to one weeks' rent for a holding deposit. Upon successful application, this amount will be off set against your first months' rent. You will also be required to pay a security deposit equivalent to 5 weeks' rent which will be held and protected in line with Deposit legislation. For more information about our fees please visit: www.haslams.net
Fees for all other tenancies (Non Housing Act Tenancies / Company Lets): when you rent a property from us we will charge you a one-off fee per property. This charge is the equivalent of 15 days of the monthly rental charge (+VAT) with a minimum fee of £450 (inc.VAT) up to a maximum of £650 (inc.VAT). Other fees may apply depending on your circumstances.

0118 960 1055

lettings@haslams.net www.haslams.net

Haslams Estate Agents Ltd, 159 Friar Street, Reading, Berkshire, RG1 1HE



Second Floor

Approx. 67.7 sq. metres (728.4 sq. feet)

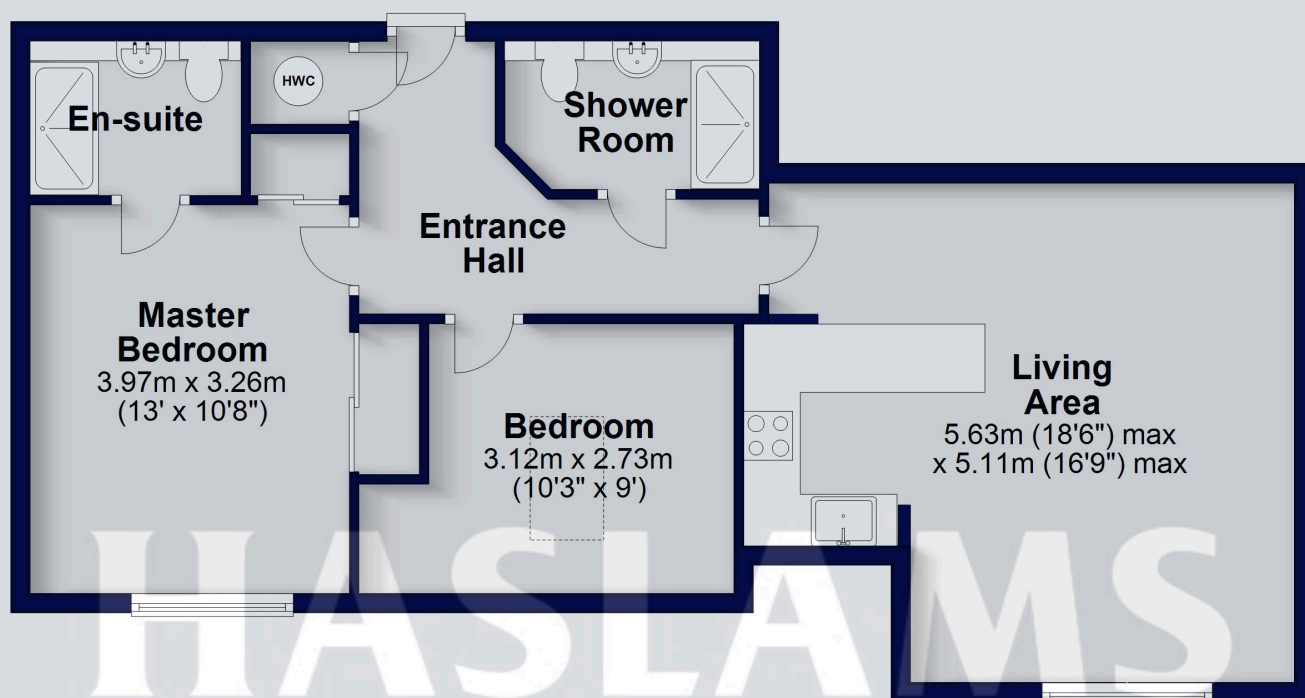

Total area: approx. 67.7 sq. metres (728.4 sq. feet)

This floorplan is for illustrative purposes only and is not to scale. The total area includes all the areas shown.

Plan produced using PlanUp.