

Property ref: 119328

Hunsaker, Reading, RG1 7AU

£1,200 PCM

HASLAM'S
Lettings



A contemporary one bedroom apartment situated on the tenth floor within an impressive town centre development, which occupies a central location close to Reading railway station and The Oracle. Reading Borough Council tax band C.

Water supply: Mains

Drainage info: Mains

Electricity supply: Mains

Gas supply: Mains

Broadband/Mobile Info: Connections available. For an indication of specific speeds and supply of Broadband and Mobile, we advise applicants go to the Ofcom website Broadband and Mobile Coverage Checker.

- Open plan living room/kitchen; Wood floors to living areas
- Modern fitted kitchen with integrated appliances
- Double bedroom with built-in wardrobes; No parking
- Bathroom with independent shower over the bath; EPC rating C
- Gas central heating; Communal gardens; On-site concierge
- Furnished; Managed by HASLAM'S

Available 11/07/2025

*Fees For Assured Shorthold Tenancies: when you rent a property from us you will be required to pay a sum equivalent to one weeks' rent for a holding deposit. Upon successful application, this amount will be off set against your first months' rent. You will also be required to pay a security deposit equivalent to 5 weeks' rent which will be held and protected in line with Deposit legislation. For more information about our fees please visit: www.haslams.net
Fees for all other tenancies (Non Housing Act Tenancies / Company Lets): when you rent a property from us we will charge you a one-off fee per property. This charge is the equivalent of 15 days of the monthly rental charge (+VAT) with a minimum fee of £450 (inc.VAT) up to a maximum of £650 (inc.VAT). Other fees may apply depending on your circumstances.

0118 960 1055

lettings@haslams.net www.haslams.net

Haslams Estate Agents Ltd, 159 Friar Street, Reading, Berkshire, RG1 1HE



Tenth Floor

Approx. 49.6 sq. metres (534.4 sq. feet)

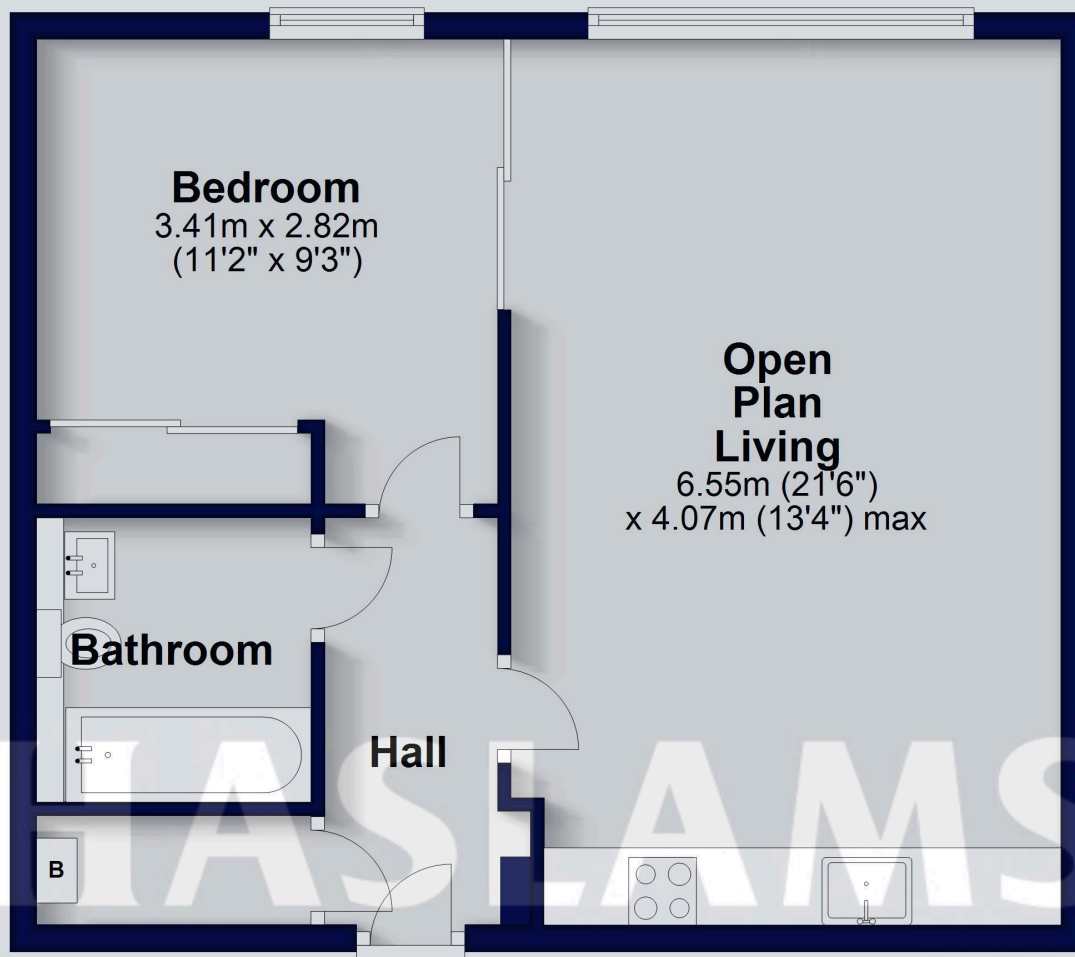

Total area: approx. 49.6 sq. metres (534.4 sq. feet)

This floorplan is for illustrative purposes only and is not to scale. The total area includes all the areas shown.

Plan produced using PlanUp.