

Property ref: 24138

London Road, Reading, RG1 5AU

£880 PCM

HASLAM'S
Lettings



A studio apartment enjoying the advantage of a private front door; this property occupies the ground floor of an attractive period building, professionally converted to provide a number of individual self-contained apartments.

Reading Borough Council Tax Band A.

Water supply: Mains

Drainage info: Mains

Electricity supply: Mains

Broadband/Mobile Info: Connections available. For an indication of specific speeds and supply of Broadband and Mobile, we advise applicants go to the Ofcom website Broadband and Mobile Coverage Checker.

- Open plan living/bedroom accommodation; Furnished
- Well fitted kitchen area including appliances
- Separate bathroom
- Electric heating; Double glazing
- Off road parking
- Furnished; EPC Rating: E

Available 14/05/2025

*Fees For Assured Shorthold Tenancies: when you rent a property from us you will be required to pay a sum equivalent to one weeks' rent for a holding deposit. Upon successful application, this amount will be off set against your first months' rent. You will also be required to pay a security deposit equivalent to 5 weeks' rent which will be held and protected in line with Deposit legislation. For more information about our fees please visit: www.haslams.net
Fees for all other tenancies (Non Housing Act Tenancies / Company Lets): when you rent a property from us we will charge you a one-off fee per property. This charge is the equivalent of 15 days of the monthly rental charge (+VAT) with a minimum fee of £450 (inc.VAT) up to a maximum of £650 (inc.VAT). Other fees may apply depending on your circumstances.

0118 960 1055

lettings@haslams.net www.haslams.net

Haslams Estate Agents Ltd, 159 Friar Street, Reading, Berkshire, RG1 1HE



Ground Floor

Approx. 21.4 sq. metres (230.8 sq. feet)

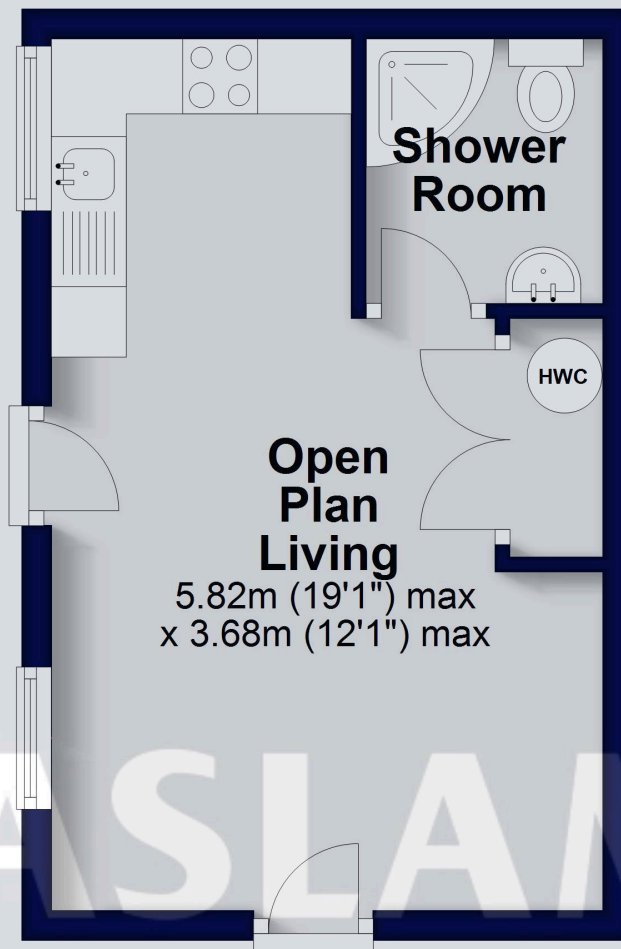

Total area: approx. 21.4 sq. metres (230.8 sq. feet)

This floorplan is for illustrative purposes only and is not to scale.

The total area includes all the areas shown.

Plan produced using PlanUp.