

Property ref: 152020

**South Street,  
Reading, RG1 4RA**

**£950 PCM**

**HASLAMs**  
Lettings



A one bedroom ground floor apartment located just a few minutes' walk from Reading town centre. This unfurnished property benefits from off road parking.

Reading Borough Council tax band B.

Water supply: Mains

Drainage info: Mains

Electricity supply: Mains

Broadband/Mobile Info: Connections available. For an indication of specific speeds and supply of Broadband and Mobile, we advise applicants go to the Ofcom website Broadband and Mobile Coverage Checker.

- One double bedroom
- Kitchen with appliances
- Electric heating; EPC rating E
- Off road parking
- Unfurnished
- Managed by LANDLORD

**Available 16/05/2025**

\*Fees For Assured Shorthold Tenancies: when you rent a property from us you will be required to pay a sum equivalent to one weeks' rent for a holding deposit. Upon successful application, this amount will be off set against your first months' rent. You will also be required to pay a security deposit equivalent to 5 weeks' rent which will be held and protected in line with Deposit legislation. For more information about our fees please visit: [www.haslamss.net](http://www.haslamss.net)  
Fees for all other tenancies (Non Housing Act Tenancies / Company Lets): when you rent a property from us we will charge you a one-off fee per property. This charge is the equivalent of 15 days of the monthly rental charge (+VAT) with a minimum fee of £450 (inc.VAT) up to a maximum of £650 (inc.VAT). Other fees may apply depending on your circumstances.

**0118 960 1055**

**[lettings@haslamss.net](mailto:lettings@haslamss.net) [www.haslamss.net](http://www.haslamss.net)**

**Haslamss Estate Agents Ltd, 159 Friar Street, Reading, Berkshire, RG1 1HE**



## South Street, Reading, RG1

Approximate Area = 376 sq ft / 34.9 sq m

For identification only - Not to scale

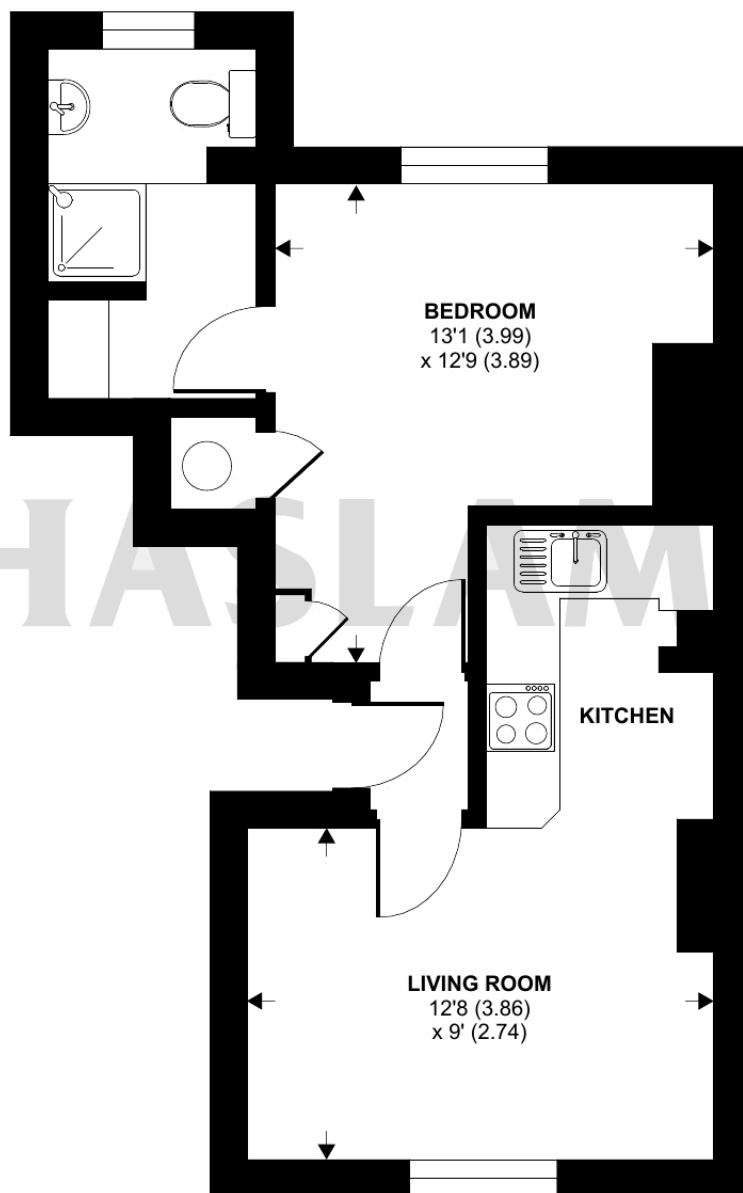

**GROUND FLOOR**



Floor plan produced in accordance with RICS Property Measurement 2nd Edition, Incorporating International Property Measurement Standards (IPMS2 Residential). © nichecom 2025. Produced for Haslamss. REF: 1280672