

Property ref: 1125

## Merchants Place, Reading, RG1 1EG

**£1,400 PCM**

**HASLAMs**  
Lettings



A modern two bedroom town centre apartment finished to a high standard and located just a short walk from Reading station. Reading Borough Council tax band C.  
Water supply: Mains  
Drainage info: Mains  
Electricity supply: Mains  
Broadband/Mobile Info: Connections available. For an indication of specific speeds and supply of Broadband and Mobile, we advise applicants go to the Ofcom website Broadband and Mobile Coverage Checker.

**Available 09/05/2025**

- Master double bedroom with en-suite shower room
- Open-plan living room with balcony; No parking
- Kitchen with integrated appliances; Additional £40pcm sundry for water
- Further double bedroom and shower room; Electric heating
- Sixth floor position; EPC Rating B
- Furnished; Managed by HASLAMs

\*Fees For Assured Shorthold Tenancies: when you rent a property from us you will be required to pay a sum equivalent to one weeks' rent for a holding deposit. Upon successful application, this amount will be off set against your first months' rent. You will also be required to pay a security deposit equivalent to 5 weeks' rent which will be held and protected in line with Deposit legislation. For more information about our fees please visit: [www.haslamss.net](http://www.haslamss.net)  
Fees for all other tenancies (Non Housing Act Tenancies / Company Lets): when you rent a property from us we will charge you a one-off fee per property. This charge is the equivalent of 15 days of the monthly rental charge (+VAT) with a minimum fee of £450 (inc.VAT) up to a maximum of £650 (inc.VAT). Other fees may apply depending on your circumstances.

**0118 960 1055**

**[lettings@haslamss.net](mailto:lettings@haslamss.net) [www.haslamss.net](http://www.haslamss.net)**

**Haslamss Estate Agents Ltd, 159 Friar Street, Reading, Berkshire, RG1 1HE**





## Sixth Floor

Approx. 62.8 sq. metres (675.7 sq. feet)

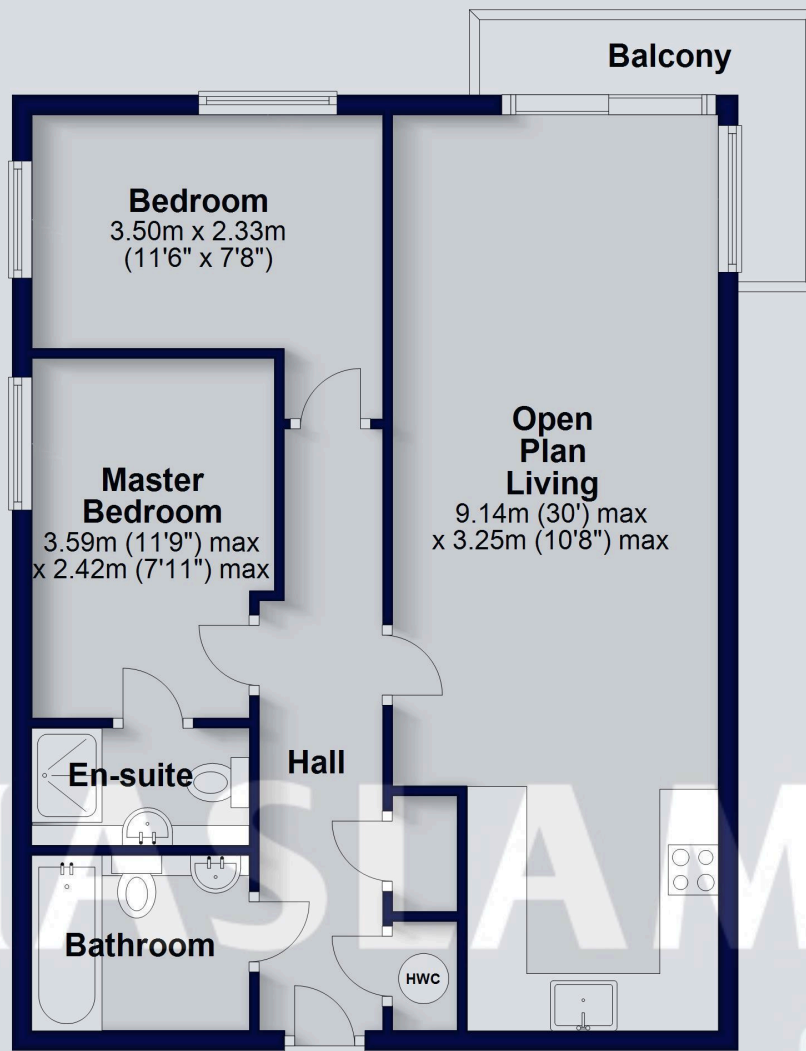

Total area: approx. 62.8 sq. metres (675.7 sq. feet)

This floorplan is for illustrative purposes only and is not to scale. The total area includes all the areas shown.

Plan produced using PlanUp.