

Property ref: 143383

Canal Way, Reading, RG1 3HY

£950 PCM

HASLAM'S
Lettings



This unique modern spacious ground floor studio apartment can be found just by the River Kennet with a short walk in to Reading town centre.

Reading Borough Council Tax Band A.

Water supply: Mains

Drainage info: Mains

Electricity supply: Mains

Broadband/Mobile Info: Connections available. For an indication of specific speeds and supply of Broadband and Mobile, we advise applicants go to the Ofcom website Broadband and Mobile Coverage Checker.

Available Now

- Studio apartment; Private parking space available for additional £50 per month
- Small fitted kitchen
- Bathroom with shower over the bath
- Electric underfloor heating
- EPC rating C; Additional £200 per month sundry to include water, electric & heating; Additional £20 per month for Wi-Fi
- Furnished; Managed by HASLAM'S

*Fees For Assured Shorthold Tenancies: when you rent a property from us you will be required to pay a sum equivalent to one weeks' rent for a holding deposit. Upon successful application, this amount will be off set against your first months' rent. You will also be required to pay a security deposit equivalent to 5 weeks' rent which will be held and protected in line with Deposit legislation. For more information about our fees please visit: www.haslams.net
Fees for all other tenancies (Non Housing Act Tenancies / Company Lets): when you rent a property from us we will charge you a one-off fee per property. This charge is the equivalent of 15 days of the monthly rental charge (+VAT) with a minimum fee of £450 (inc.VAT) up to a maximum of £650 (inc.VAT). Other fees may apply depending on your circumstances.

0118 960 1055

lettings@haslams.net www.haslams.net

Haslams Estate Agents Ltd, 159 Friar Street, Reading, Berkshire, RG1 1HE

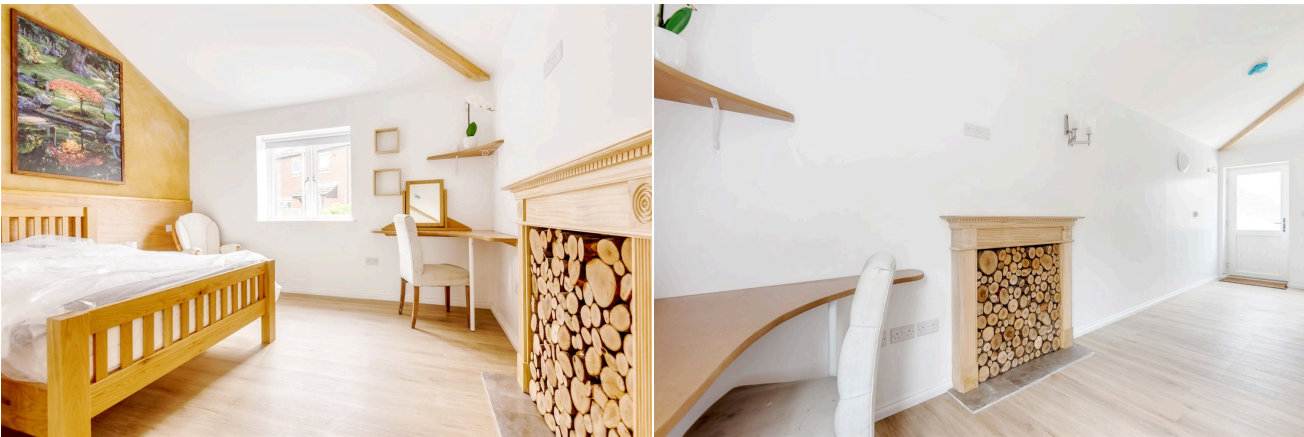

Canal Way, Reading, RG1

Approximate Area = 247 sq ft / 22.9 sq m

For identification only - Not to scale

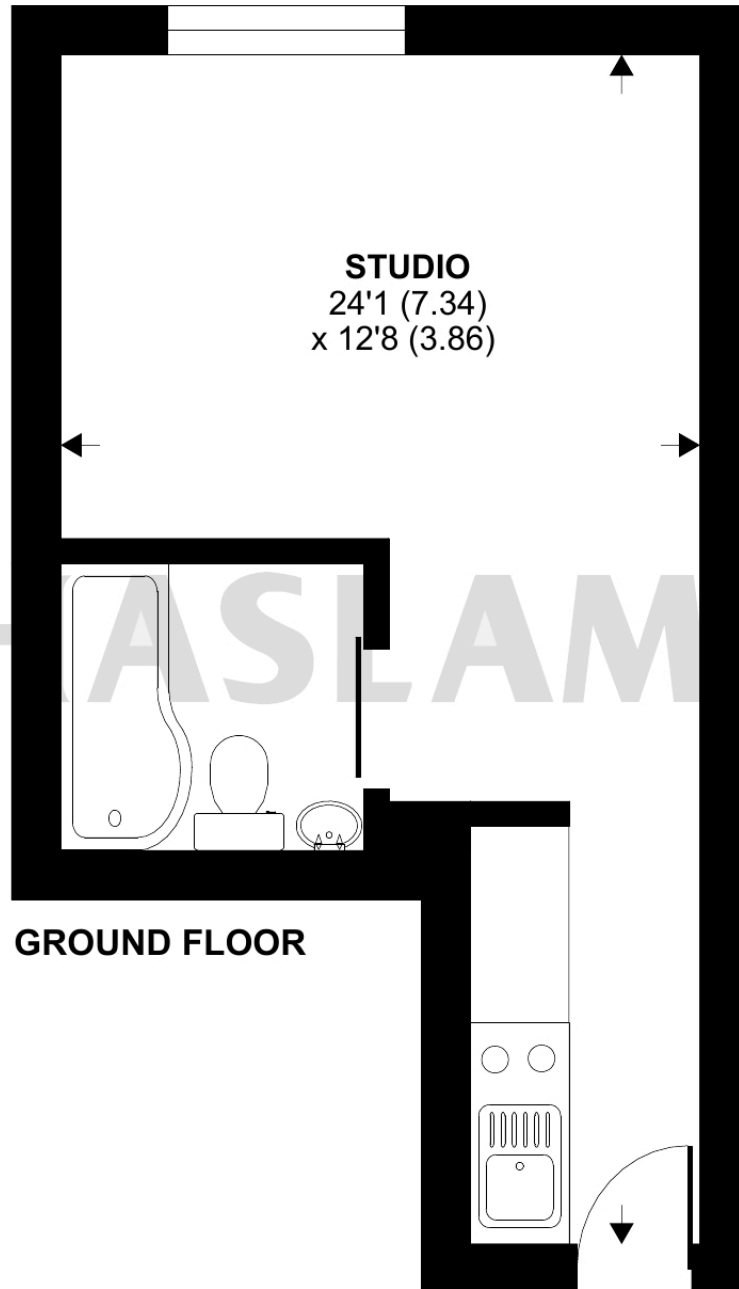

GROUND FLOOR



**Certified
Property
Measurer**

Floor plan produced in accordance with RICS Property Measurement Standards incorporating International Property Measurement Standards (IPMS2 Residential). © n1cheom 2022.
Produced for Haslamss. REF: 845310