

Property ref: 119878

**Watlington Street,  
Reading, RG1 4RQ****£1,500 PCM****HASLAM'S**  
Lettings

A well presented three double bedroom terraced home situated within a stones throw of the Royal Berkshire Hospital. The property benefits from two reception rooms, fitted kitchen, modern bathroom and courtyard garden to the rear. This property would be ideal for professionals.  
Reading Borough Council Tax Band C.

**Available Now**

- Three double bedrooms
- Fitted kitchen; Gas central heating
- Close proximity to Reading mainline station
- Courtyard garden; Unfurnished
- Parking permit; EPC rating D
- Unfurnished; Managed by HASLAM'S

\*Fees For Assured Shorthold Tenancies: when you rent a property from us you will be required to pay a sum equivalent to one weeks' rent for a holding deposit. Upon successful application, this amount will be off set against your first months' rent. You will also be required to pay a security deposit equivalent to 5 weeks' rent which will be held and protected in line with Deposit legislation. For more information about our fees please visit: [www.haslams.net](http://www.haslams.net)  
Fees for all other tenancies (Non Housing Act Tenancies / Company Lets): when you rent a property from us we will charge you a one-off fee per property. This charge is the equivalent of 15 days of the monthly rental charge (+VAT) with a minimum fee of £450 (inc.VAT) up to a maximum of £650 (inc.VAT). Other fees may apply depending on your circumstances.

**0118 960 1055****[lettings@haslams.net](mailto:lettings@haslams.net) [www.haslams.net](http://www.haslams.net)****Haslams Estate Agents Ltd, 159 Friar Street, Reading, Berkshire, RG1 1HE**



Water supply: Mains

Drainage info: Mains

Electricity supply: Mains

Gas supply: Mains

Broadband/Mobile Info: Connections available. For an indication of specific speeds and supply of Broadband and Mobile, we advise applicants go to the Ofcom website Broadband and Mobile Coverage Checker.





# Watlington Street, Reading, RG1

Approximate Area = 788 sq ft / 73.2 sq m

For identification only - Not to scale

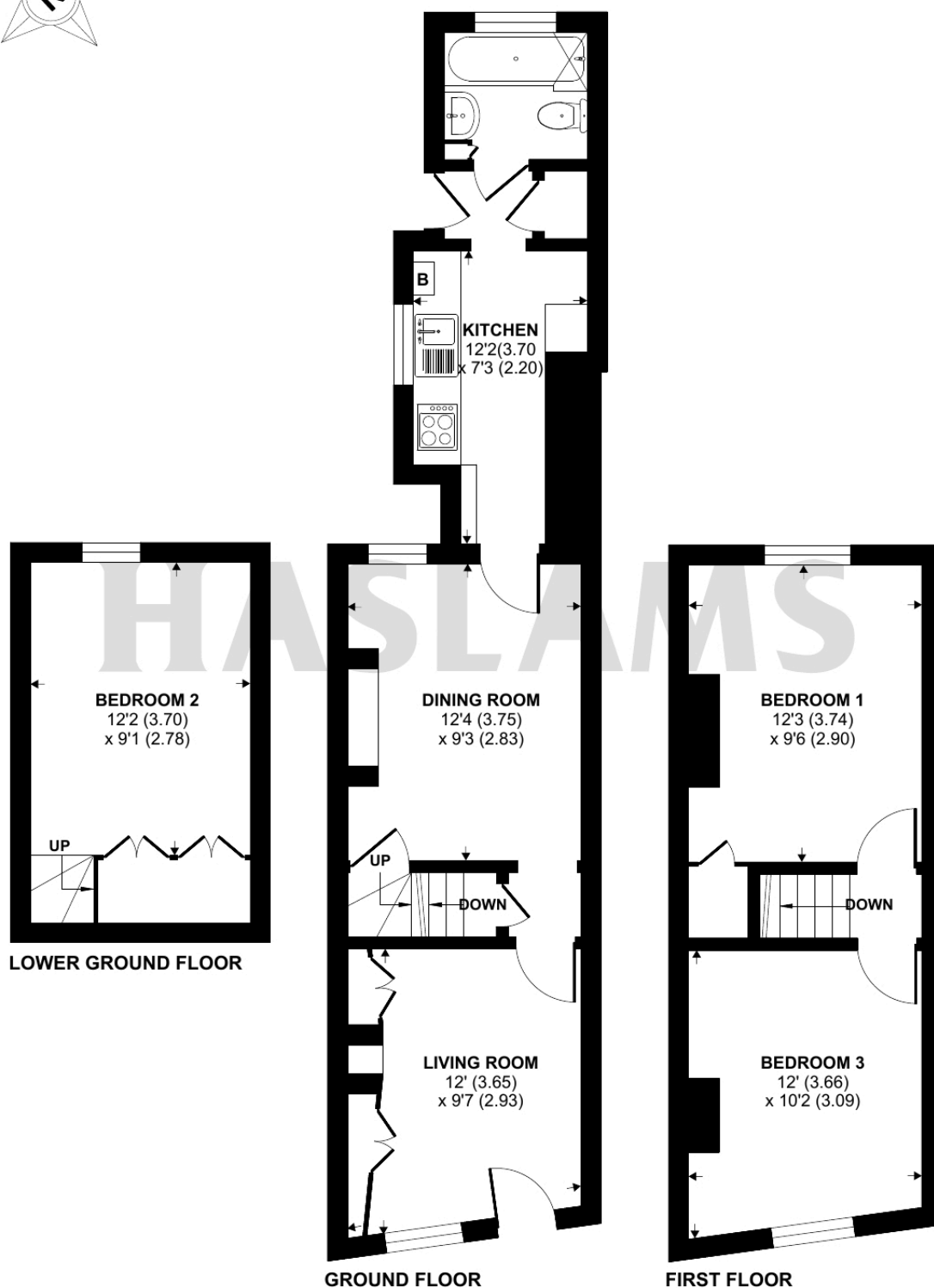

Floor plan produced in accordance with RICS Property Measurement 2nd Edition, Incorporating International Property Measurement Standards (IPMS2 Residential). © nñchecom 2025. Produced for Haslamss. REF: 1285026