

Property ref: 106056

Conquest Court, Reading, RG1 4EF

£1,450 PCM

HASLAM'S
Lettings



A two bedroom first floor apartment in a highly desirable conservation area within close proximity of Reading town centre. The property benefits from easy access to the mainline train station, regular bus routes, major transport links, local shops and amenities. The accommodation is in good decorative order, bright and airy due to the high ceilings and comprises; entrance hall, living / dining room, fitted kitchen, two bedrooms and a three piece bathroom. Additional features include a balcony, pine wooden flooring, gas central heating and double glazing.

Reading Borough Council Tax Band C.

Available 09/08/2024

- Two double bedrooms; Within the Eldon Square conservation area
- Fully fitted kitchen with appliances
- Close to Reading mainline station
- Gas central heating; No parking
- EPC rating D; Furnished
- Managed by HASLAM'S

*Fees For Assured Shorthold Tenancies: when you rent a property from us you will be required to pay a sum equivalent to one weeks' rent for a holding deposit. Upon successful application, this amount will be off set against your first months' rent. You will also be required to pay a security deposit equivalent to 5 weeks' rent which will be held and protected in line with Deposit legislation. For more information about our fees please visit: www.haslams.net
Fees for all other tenancies (Non Housing Act Tenancies / Company Lets): when you rent a property from us we will charge you a one-off fee per property. This charge is the equivalent of 15 days of the monthly rental charge (+VAT) with a minimum fee of £450 (inc.VAT) up to a maximum of £650 (inc.VAT). Other fees may apply depending on your circumstances.

0118 960 1055

lettings@haslams.net www.haslams.net

Haslams Estate Agents Ltd, 159 Friar Street, Reading, Berkshire, RG1 1HE

Water supply: Mains

Drainage info: Mains

Electricity supply: Mains

Gas supply: Mains

Broadband/Mobile Info: Connections available. For an indication of specific speeds and supply of Broadband and Mobile, we advise applicants go to the Ofcom website 'Broadband and Mobile Coverage Checker'.



Ground Floor

Approx. 67.8 sq. metres (729.6 sq. feet)

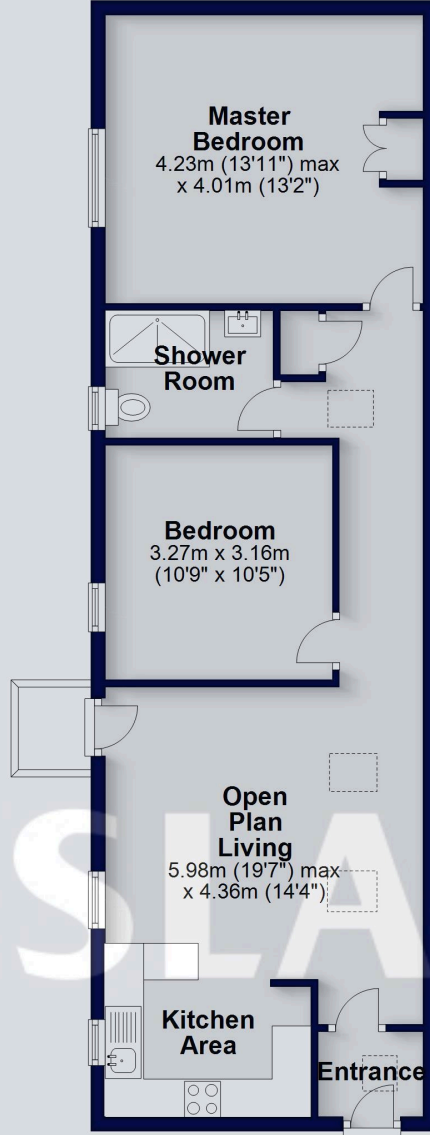

Total area: approx. 67.8 sq. metres (729.6 sq. feet)

This floorplan is for illustrative purposes only and is not to scale. The total area includes all the areas shown.
Plan produced using PlanUp.

HASLAMSS .net