

Property ref: 162504

Weldale Street, Reading, RG1 7BX

£1,300 PCM

HASLAM'S
Lettings



A modern, purpose built, second floor one bedroom apartment built by Luckmore Developments in the heart of Reading. Just minutes from the mainline station, with journey times into London within half an hour. A huge variety of shops, restaurants and leisure activities lay on the doorstep.

Reading Borough Council- Tax Band B

No Parking

No Pets

Available Now

- One bedroom apartment with private balcony
- Fully fitted kitchen with appliances
- Five minute walk to Reading mainline station
- EPC Rating B
- Furnished
- Managed by HASLAM'S

*Fees For Assured Shorthold Tenancies: when you rent a property from us you will be required to pay a sum equivalent to one weeks' rent for a holding deposit. Upon successful application, this amount will be off set against your first months' rent. You will also be required to pay a security deposit equivalent to 5 weeks' rent which will be held and protected in line with Deposit legislation. For more information about our fees please visit: www.haslams.net
Fees for all other tenancies (Non Housing Act Tenancies / Company Lets): when you rent a property from us we will charge you a one-off fee per property. This charge is the equivalent of 15 days of the monthly rental charge (+VAT) with a minimum fee of £450 (inc.VAT) up to a maximum of £650 (inc.VAT). Other fees may apply depending on your circumstances.

0118 960 1055

lettings@haslams.net www.haslams.net

Haslams Estate Agents Ltd, 159 Friar Street, Reading, Berkshire, RG1 1HE

Heating Type (Gas, Elec, communal boiler etc.): Gas

Water supply: Mains

Drainage info: Mains

Electricity supply: Mains

Gas supply: Mains

Broadband/Mobile Info: Connections available. For an indication of specific speeds and supply of Broadband and Mobile, we advise applicants go to the Ofcom website 'Broadband and Mobile Coverage Checker'.



Weldale Street, Reading, RG1

Approximate Area = 318 sq ft / 29.5 sq m

For identification only - Not to scale

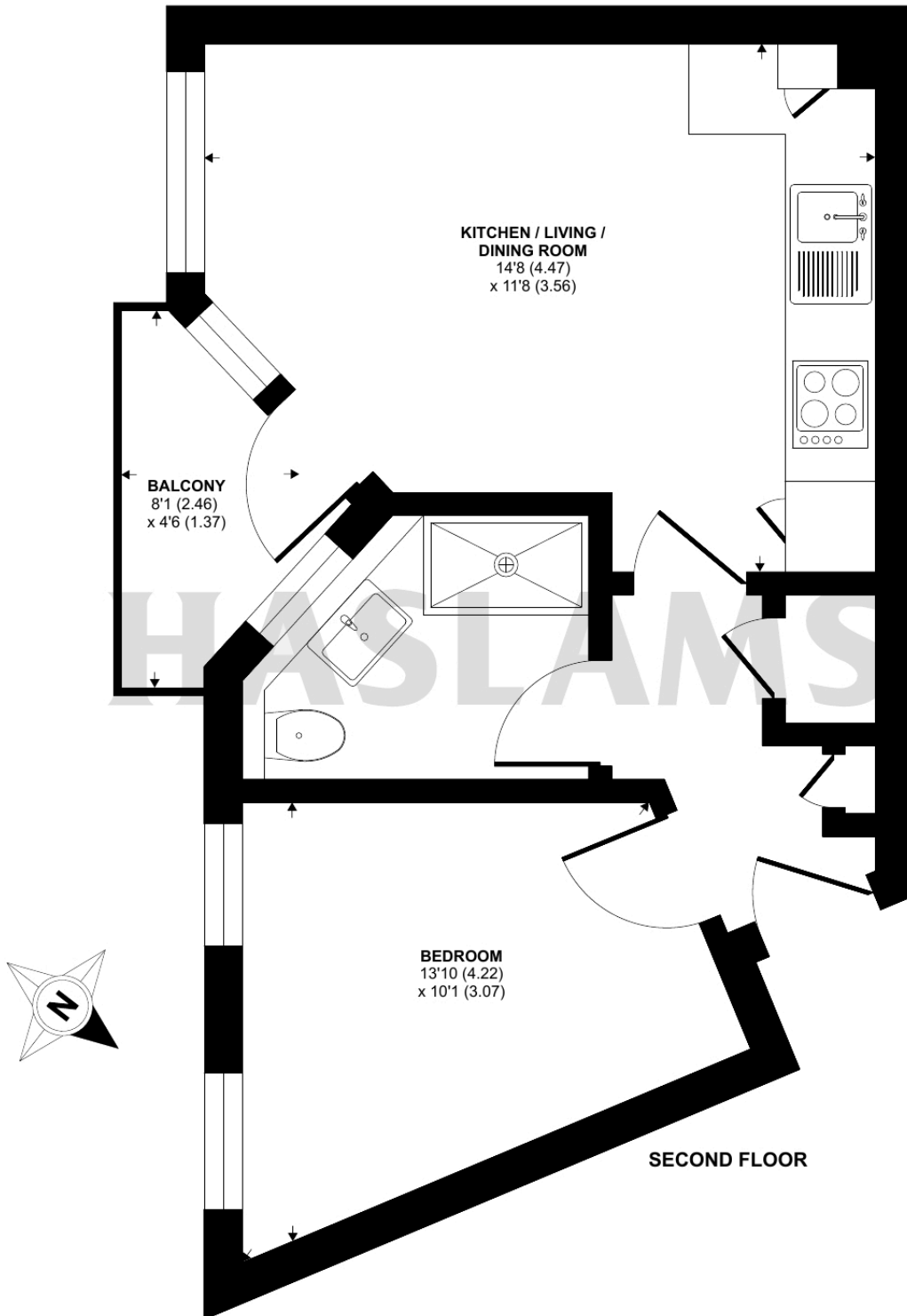

Floor plan produced in accordance with RICS Property Measurement Standards incorporating International Property Measurement Standards (IPMS2 Residential). © n1cheom 2024. Produced for Haslam's. REF: 1141095