



Manor Park, Pawlett  
£360,000



- Detached, family home!
- Four well proportioned bedrooms!
- Surprising outlook & views!
- Solar panels!
- Modern finish throughout!
- Three reception rooms & kitchen!
- Good sized rear garden!
- Garage & double driveway!
- Oil central heating!
- Modern double glazing throughout!

**Hall**

**Living Room**

4.09m (max) x 4.07m

**Dining Room**

2.45m x 2.80m

**Conservatory**

2.83m (max) x 3.00m (max)

**Kitchen**

3.65m x 2.81m

**Utility**

**WC**

**Stairs & Landing**

**Bedroom 1**

4.12m (max) x 3.50m

**En-Suite Wet Room**

1.73m x 1.60

**Bedroom 2**

2.65m x 4.15m

**Bedroom 3**

3.08m (max) x 3.46m

**Bedroom 4**

2.64m (max) x 2.66m (max)

**Family Bathroom**

2.10m x 1.89m

**Garage**

2.55m x 5.39m





Presenting this well presented, detached, family home with a surprising outlook and views!

The property itself has a modern finish throughout and comprises a hall. A generously sized living room with under-stairs storage and dual aspect light including a bay window. A dining room with French doors to the conservatory, which in turn has French doors leading out onto the rear garden patio. A modern kitchen giving ample worktop & unit space, under-unit lighting and appliances. A utility with storage, space for appliances and rear door. A WC with toilet and basin with vanity storage.



Stairs lead up to the landing. The master bedroom is a good sized double with airing cupboard and ensuite wet room hosting a shower and basin with vanity storage. The second bedroom is a good sized double with dual aspect light. The third bedroom is another double in size, overlooking the rear. The fourth bedroom, used as a study currently, overlooks the rear also. The modern family bathroom hosts a bath with shower attachment, toilet and basin with vanity storage.

There is a garage with power and light and a double driveway to the front.

The front garden is low maintenance being gravel with some plants whilst the fully enclosed, rear garden hosts lawn, patio, borders with plants and a shed.

The property benefits from oil central heating, solar panels and modern double glazing throughout.

Manor Park is found in Pawlett, north of Bridgwater, and the property is only a short walk away from a primary school, Pawlett Pavilion, play area and rural walks. The M5 is a short drive away, linking to Bristol, Exeter and beyond.

Tenure: Freehold  
EPC: E  
Council tax band: E



## Floor Plan

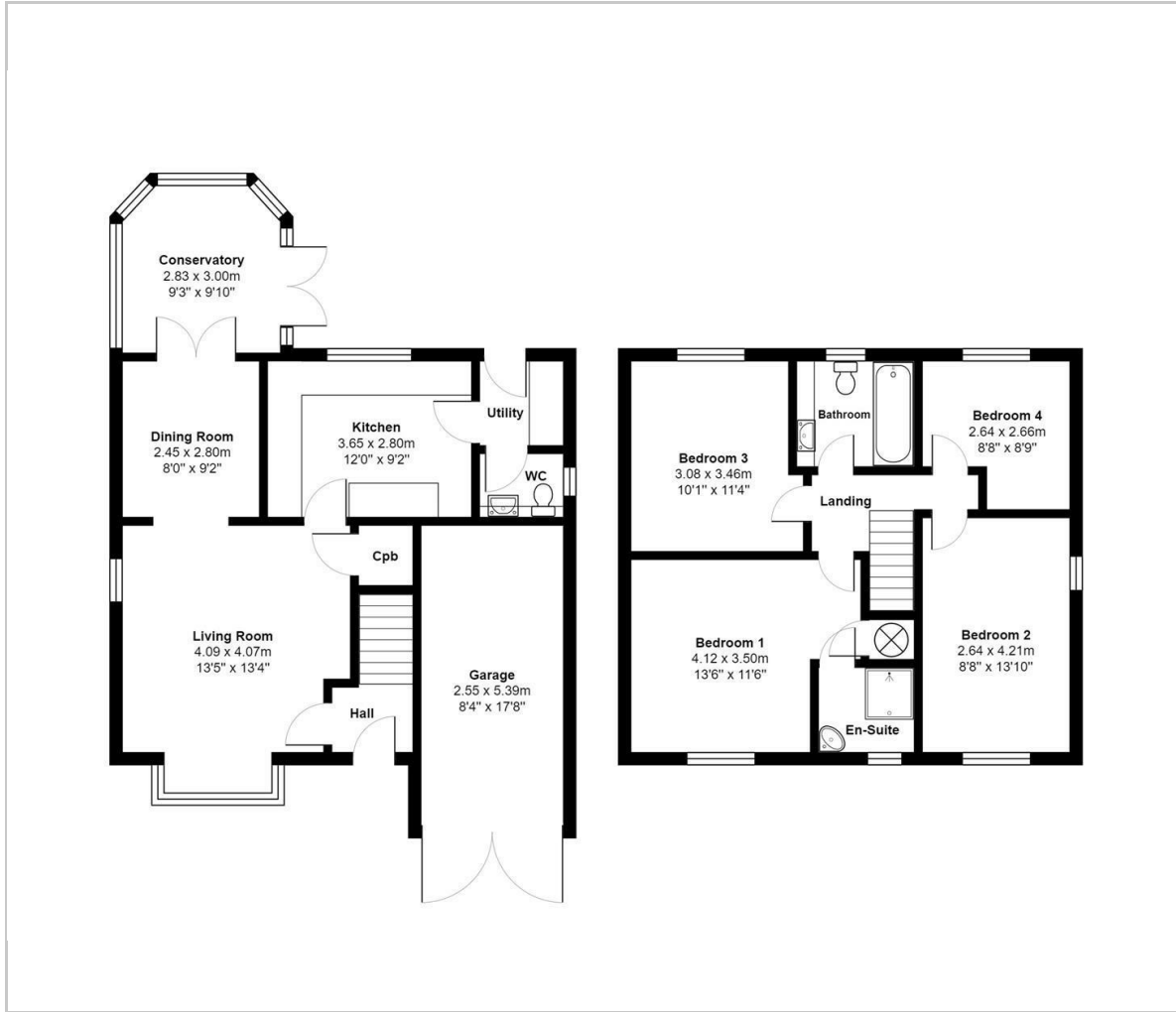

## Viewing

Please contact our Sales Office on 01278 554333 if you wish to arrange a viewing appointment for this property or require further information.

## Area Map



## Energy Efficiency Graph

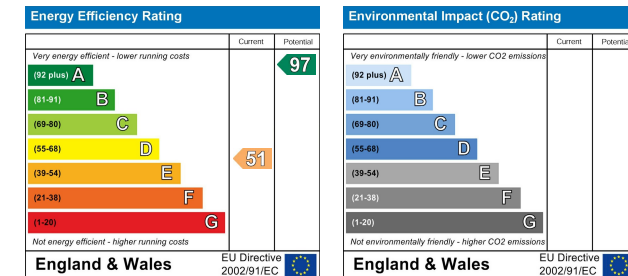

These particulars, whilst believed to be accurate are set out as a general outline only for guidance and do not constitute any part of an offer or contract. Intending purchasers should not rely on them as statements of representation of fact, but must satisfy themselves by inspection or otherwise as to their accuracy. No person in this firm's employment has the authority to make or give any representation or warranty in respect of the property.

4 Moravia Close, Somerset, TA6 3SN

Tel: 01278 554333 Email: corbett@sykesmoore.co.uk <http://www.sykesmoore.co.uk/>