



**** Traditional Mid Terrace ** Two Reception Rooms ** Two Double Bedrooms ****

A mid terrace home offering UPVC double glazed and gas centrally heated accommodation. The home offers a lounge on the front aspect, separate dining room and kitchen across the rear elevation.

The first floor has two double bedrooms and rear bathroom. Outside is a shared entry leading to the rear garden. Internal viewing by appointment only.

The Accommodation

Offered for sale with no upward chain this traditional mid terrace home offering UPVC double glazed and gas centrally heated accommodation ideal for the first time buyer or investor.

The home opens with a front UPVC door leading to the lounge with meter cupboard and radiator and door into the dining room with a useful below stair storage cupboard, radiator and window to the rear aspect.

The kitchen along the rear aspect has a selection of units and freestanding appliance spaces with door and windows facing the rear garden.

The first floor has two double bedrooms, the larger across the front elevation, the second bedroom having a built-in cupboard housing the gas fired combination boiler. The bathroom offers a WC, hand wash basin and bath with thermostatic shower above, radiator and window to the rear aspect.

Outside there is a shared entry to the rear garden.

Property construction: Standard

Parking: None

Electricity supply: Mains

Water supply: Mains

Sewerage: Mains

Heating: Mains Gas

Council Tax Band: A

Local Authority: East Staffordshire Borough Council

Broadband type: TBC - See Ofcom link for speed:

<https://checker.ofcom.org.uk/> Mobile signal/coverage:

See Ofcom link <https://checker.ofcom.org.uk/>

Useful Websites:

www.gov.uk/government/organisations/environment-agency

Please ensure you have viewed the agent's full PDF branded brochure for full information regarding the property and not rely on third party website information supplied before actioning the purchase process.

The property information provided by Nicholas Humphrey Estate Agents is based on enquiries made of the vendor and from information available in the public domain. If there is any point on which you require further clarification, please contact the office and we will be pleased to check the information for you. Please note if your enquiry is of a legal or structural nature, we advise you to seek advice from a qualified professional in their relevant field. The home is within the towns selective license area for the purpose of rental, and the landlord will require a licence at their expense, following an inspection.

Draft details awaiting vendor approval and subject to change





Ground Floor

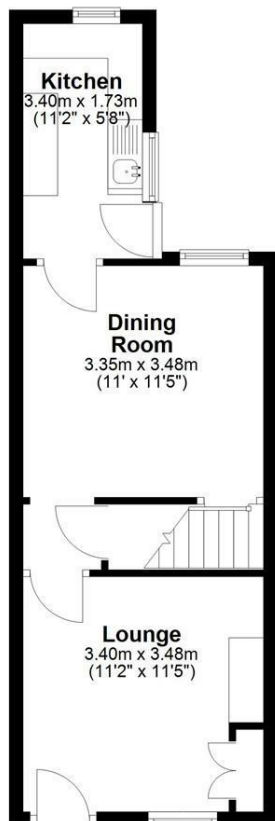

First Floor



NICHOLAS HUMPHREYS. This Floorplan is for illustrative purposes only and while reasonable efforts have been made to ensure its accuracy, it is not to scale and measurements should not be relied upon. For display and layout purpose only used by NICHOLAS HUMPHREYS, as a general indication of the layout. It does not form any part of any contract or warranty.
Plan produced using PlanUp.

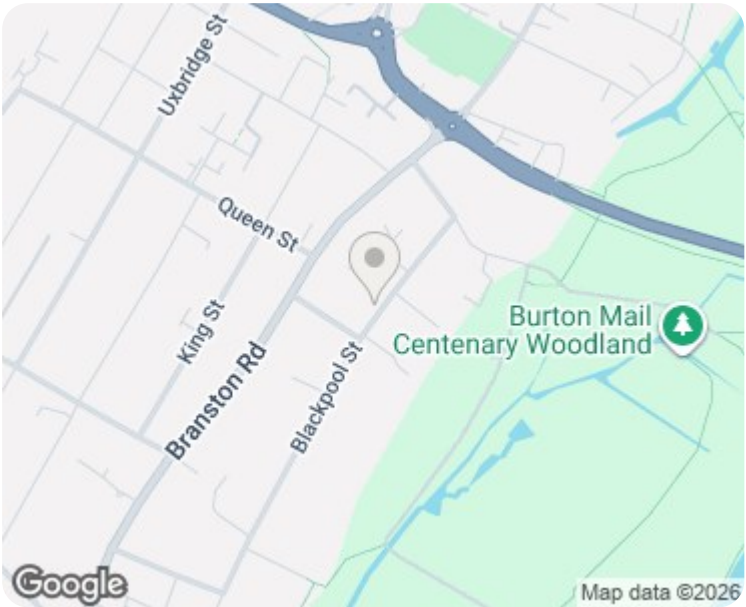
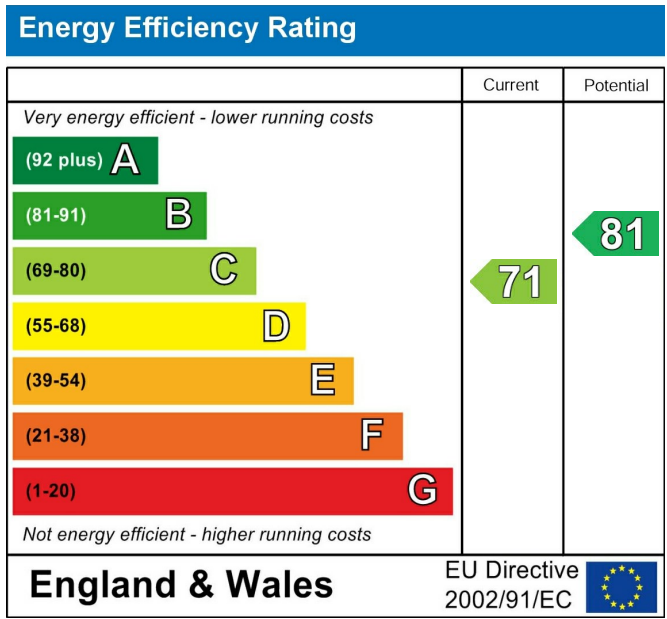

Council Tax Band A Freehold

Services. If & where stated in the details main's water, gas and electricity are understood to be available to the property, none of these have been tested or investigated for connection, nor any of the appliances attached thereto, have been tested by Nicholas Humphreys, who gives no warranties as to their condition or working order.

Floor Plans. To be used as an illustrative purpose only and while reasonable efforts have been made to ensure its accuracy, it is not to scale and measurements should not be relied upon. The company displays the floor plan as a general indication of layout and it does not form any part of any contract or warranty and provides an approximate guide to layout.

Money Laundering. Under the Protecting Against Money Laundering and Proceeds of Crime Act 2002, we must point out that any successful purchasers proceeding with the purchase will be asked for identification ie: Passport, Driving Licence, and recent Utility Bill. This evidence will be required prior to solicitors being instructed in the purchase of a property.

Survey. We advise all buyers to undertake their own investigations into the condition of the property and surroundings by an independent survey. We the Agent do not conduct a survey of the property and cannot advise on structural defects or materials used. Independent advice is required before exchange and completion.

Agent Note. Whilst every care has been taken in preparation of these details, they are for guidance purpose only. All measurements are approximate, and whilst every care has been taken for accuracy, their accuracy should not be relied upon. Buyers are advised to recheck measurements and inspect the property before exchange of contracts to confirm they are satisfied with the condition of the property and surroundings before completion of the purchase. New development sites are increasingly implementing an on-site annual management charge, all sale of property could be subject to this charge, to be verified & confirmed by your acting solicitor/ conveyancer before exchange of contracts.

Selective License Areas. The Council's Selective Licensing Scheme requires all landlords who privately rent out properties within the designated areas to obtain a licence from the council. Within Burton on Trent the following streets have been designated: Blackpool Street, Branstons Road, Broadway Street, Goodman Street, King Street, Queen Street, Shobnall Street, Uxbridge Street & Waterloo Street. A license fee for application will be payable and work to the home maybe required. Full information: <https://www.eaststaffsbc.gov.uk/housing-and-property/landlords/selective-licensing-scheme>