



42 Fellowes Road

PE2 8DS

Offers in the region of £120,000





## 42 Fellowes Road

PE2 8DS

Located On Fellowes Road, Fletton, we are pleased to offer this two bedroom ground floor apartment with parking space. This apartment is close to local amenities & is within walking distance of Peterborough city centre & train station.

This two bedroom ground floor apartment is ideal for a first time buyer or as an investment property. Featuring two bedrooms, lounge/diner, kitchen & bathroom. The apartment also consists of two storage cupboards upon entering the property.

Directly at the front of the property you have an allocated parking space for one vehicle.

Tenure: Leasehold  
Council Tax Band: A





Entrance Hall:

Lounge:

12'0" x 12'1" (3.67m x 3.70m)

Kitchen:

5'4" x 10'2" (1.63m x 3.10m)

Bedroom one:

11'2" (max) x 8'11" (max) (3.42m (max)  
x 2.72m (max))

Bedroom Two:

8'7" x 6'1" (2.64m x 1.87m)

Bathroom:

5'4" (max) x 8'2" (max) (1.65m (max) x  
2.49m (max))



Floor Plan

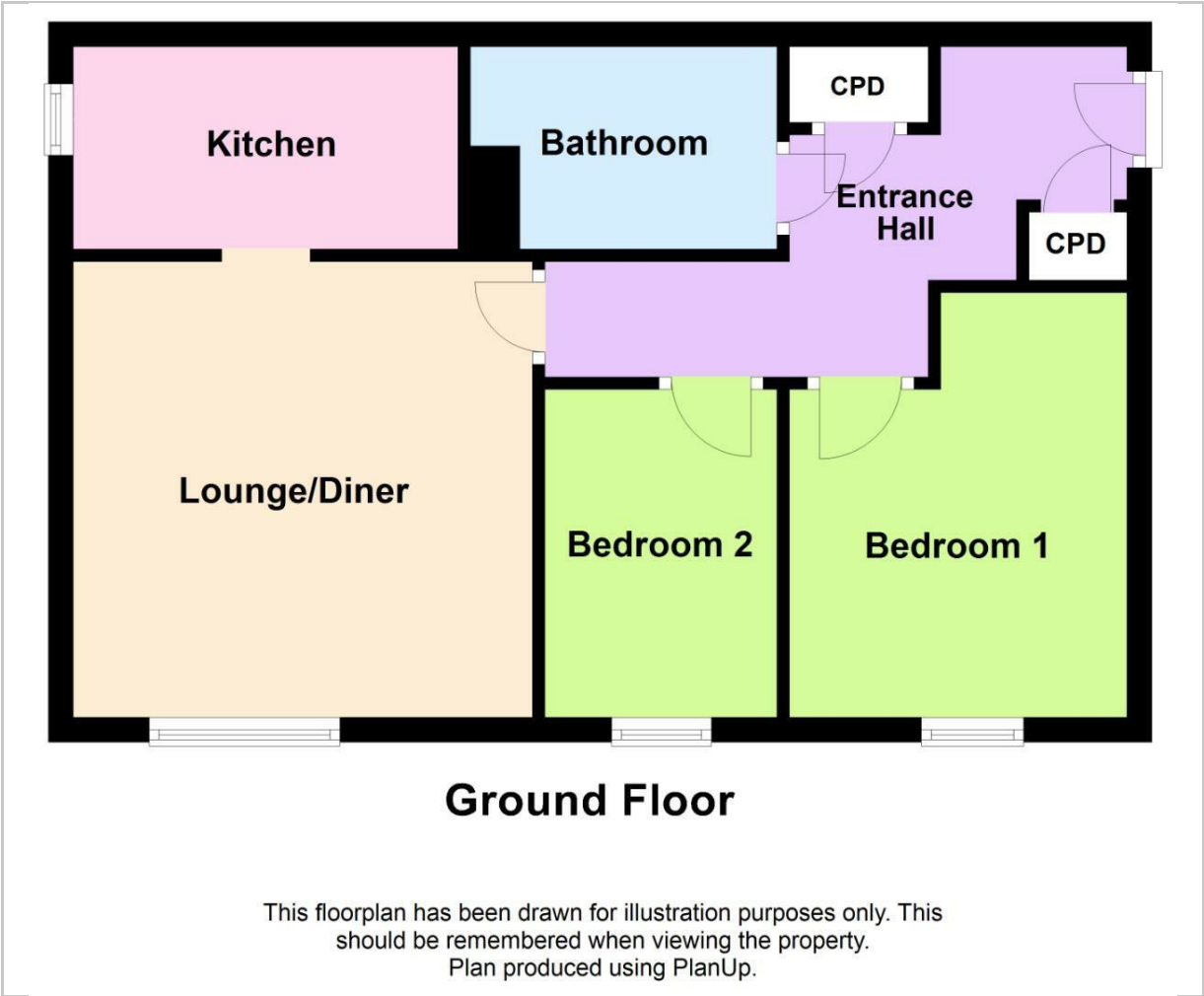

Viewing

Please contact our Peterborough Office on 01733 834727 if you wish to arrange a viewing appointment for this property or require further information.

These particulars, whilst believed to be accurate are set out as a general outline only for guidance and do not constitute any part of an offer or contract. Intending purchasers should not rely on them as statements of representation of fact, but must satisfy themselves by inspection or otherwise as to their accuracy. No person in this firms employment has the authority to make or give any representation or warranty in respect of the property.



381 Eastfield Road,  
Peterborough, PE1 4RA  
T: 01733 834727  
E: peterborough@firminandco.co.uk

Area Map



Energy Efficiency Graph

