

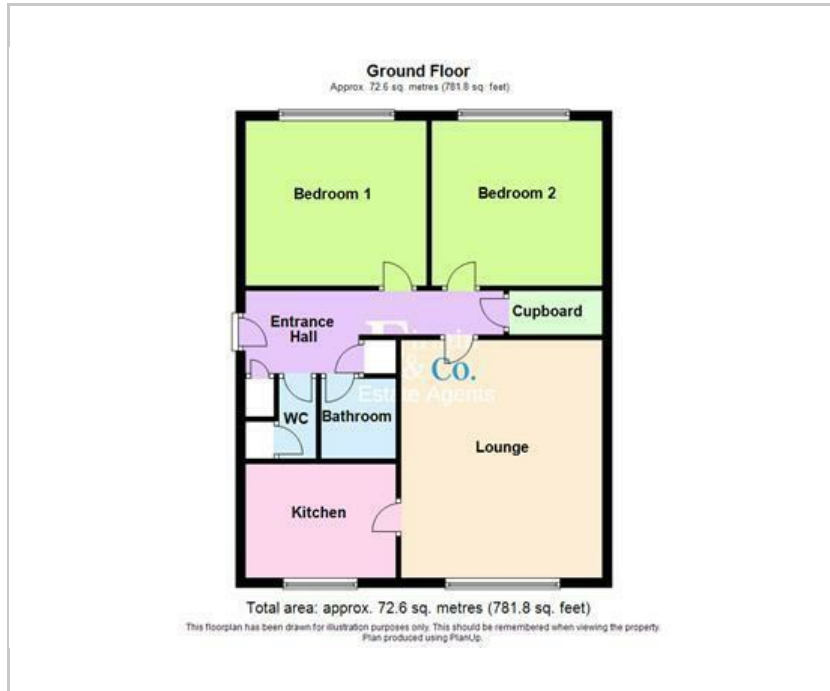

18 Osric Court, Eastfield PE1 5LW
Offers in the region of £140,000

Floor Plan



Accommodation

Very well proportioned apartment in Osric Court, Peterborough. Ideal for a first time buy or investment property.

This property comprises of;

Communal stairwell, intercom system, entrance hall with storage cupboard, lounge leading through to the kitchen, two double bedrooms, bathroom and separate w/c.

This property benefits from a gated car park and key fob security gates throughout the site. Situated within easy reach of Peterborough city centre and major transport links.

Tenure: Leasehold 90 years remaining
Ground Rent: £10 pa
Annual Service Charge: £1803.83
Council Tax Band: A

Entrance Hall

Lounge 16'6" x 13'11" (5.03m x 4.25m)

Kitchen 10'5" x 7'10" (3.18m x 2.41m)

Bedroom One 12'6" x 11'5" (3.82m x 3.49m)

Bedroom Two 11'9" x 11'5" (3.60m x 3.50m)

Bathroom

W/C



Area Map

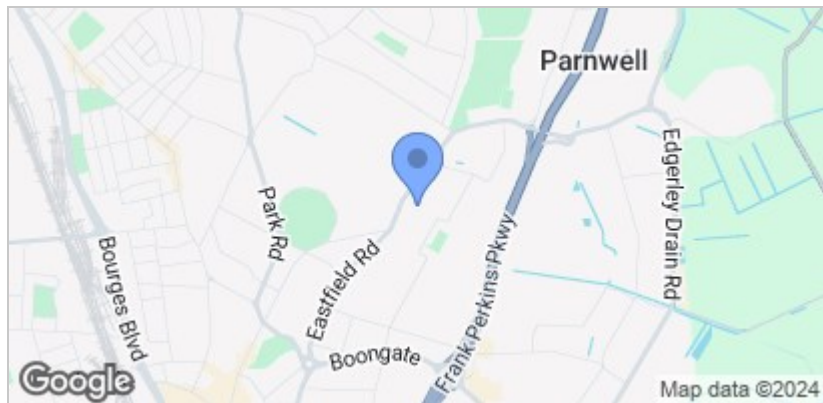

Viewing

Please contact our Peterborough Office on 01733 834727 if you wish to arrange a viewing appointment for this property or require further information.

Energy Efficiency Graph

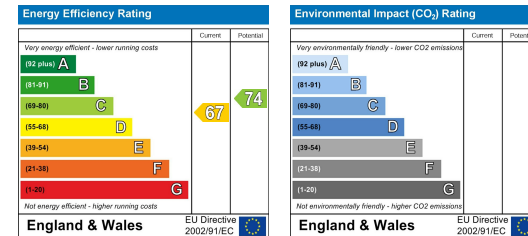

These particulars, whilst believed to be accurate are set out as a general outline only for guidance and do not constitute any part of an offer or contract. Intending purchasers should not rely on them as statements of representation of fact, but must satisfy themselves by inspection or otherwise as to their accuracy. No person in this firm's employment has the authority to make or give any representation or warranty in respect of the property.



381 Eastfield Road,
Peterborough, PE1 4RA
T: 01733 834727
E: peterborough@firminandco.co.uk