

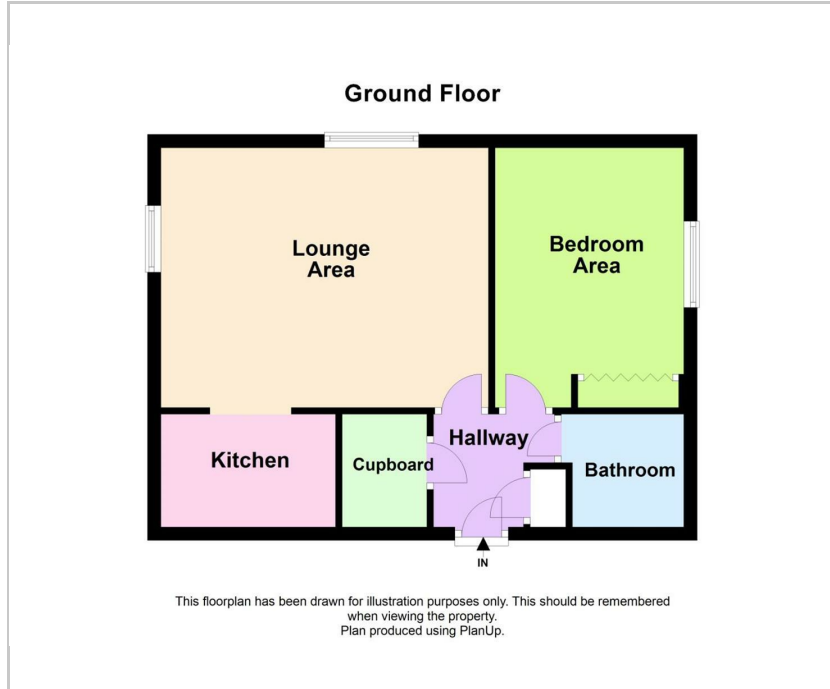

44 Heritage Court Eastfield Road, PE1 4RB
£50,000



Floor Plan



Accommodation

Offering no upward chain and situated in this over 55's development is this well presented, top floor apartment within Heritage Court, which is conveniently close to local amenities with transport links to the City Centre nearby, the development benefits from communal facilities that include a large sitting room, laundry facilities and gardens/grounds, with stairs and a lift facilities to the second floor and in brief the property comprises, entrance hall with a built in storage cupboard and a built in airing cupboard, from here door leads into a spacious lounge/diner with dual aspect windows, with a kitchen off, comprising a range of wall and floor level units with worktop surfaces with tiled splashbacks, with stainless steel sink unit with storage under, space for cooker & fridge/freezer. Double bedroom off the hallway which benefits from a double wardrobe with a window overlooking the communal gardens, finishing off the accommodation is a three piece bathroom. Outside to the front, there is communal parking and communal gardens which are mainly laid to lawn with a patio area and mature shrubs.

Property Information:
Tenure: Leasehold - 61 years remaining
Annual Service Charge: £3038.28
Council Tax Band: A

Entrance Hall:
Storage Cupboard: 1.71m x 1.27m (5'7" x 4'2")
Lounge/Diner: 3.89m x 4.90m (12'9" x 16'1")
Kitchen: 1.70m x 2.59m (5'7" x 8'6")
Bedroom: 3.89m x 2.82m (12'9" x 9'3")
Bathroom:



Area Map



Viewing

Please contact our Peterborough Office on 01733 834727 if you wish to arrange a viewing appointment for this property or require further information.

Energy Efficiency Graph

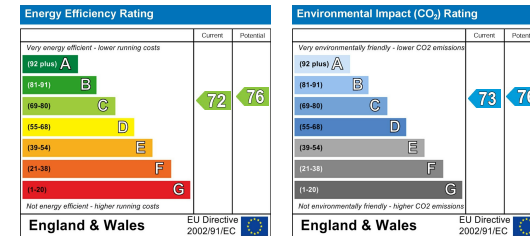

These particulars, whilst believed to be accurate are set out as a general outline only for guidance and do not constitute any part of an offer or contract. Intending purchasers should not rely on them as statements of representation of fact, but must satisfy themselves by inspection or otherwise as to their accuracy. No person in this firm's employment has the authority to make or give any representation or warranty in respect of the property.



381 Eastfield Road,
Peterborough, PE1 4RA
T: 01733 834727
E: peterborough@firminandco.co.uk