



Tappers Barn Tabbits Hill Lane

Harmans Cross, Corfe Castle, BH20 5HZ

Guide price £725,000



Tappers Barn Tabbits Hill Lane

Harmans Cross, Corfe Castle, BH20 5HZ

Guide price £725,000



* VENDORS SUITED * This 20th century detached cottage is located within a rural setting close to the village of Harmans Cross which sits in between the popular seaside town of Swanage and the historic village of Corfe Castle. The property has been extended over the years to offer substantial accommodation throughout which now includes the possibility to Airbnb.

As you enter the property you are greeted with the beautiful kitchen/diner. Double french doors lead out on to the substantial rear garden with views overlooking the Purbeck hills. The kitchen area benefits from a range of wall mounted and base units with work surface over. Integrated appliances include an oven with electric hob and extractor fan and dishwasher. There is space for a fridge/freezer. The lounge offers a warm feel with a beautiful feature Purbeck stone fireplace with log burner and beamed ceilings. There are three bath/shower rooms within the property. Off of the kitchen is a shower room/utility. It has space for a washing machine and tumble dryer as well as an enclosed shower cubicle, WC and wash hand basin. There are three double bedrooms. The master bedroom is located on the first floor and benefits from an en-suite bathroom. The bathroom benefits from a bath with hand held shower attachment, WC, wash hand basin. There is also a storage cupboard within the bathroom.

In 2022 the garage was converted to a third bedroom, entrance lobby and shower room. It is predominantly used as an Airbnb benefiting from it's own entrance with the owners making regular income from visitors to the area. The bedroom looks out on to the rear garden whilst the shower room has been finished to a high standard and benefits from a shower cubicle, WC and wash hand basin with built in vanity unit.

Externally, to the front is a gravel driveway providing off road parking. To the rear is a beautiful rear garden with views over the Purbeck countryside. Enclosed via a timber fence the garden also benefits from a laid lawn, flower and shrub borders and a stone paved patio. There is access down the side which leads to a covered storage area.

Tenure: Freehold

Council Tax Band: E

Services include mains water & electricity, oil central heating and septic tank drainage.

The rural village of Harmans Cross is located in between the seaside resort of Swanage and the historic village of Corfe Castle. The popular railway serves Corfe Castle to Swanage. The popular beaches stretch for miles along the Jurassic coast. The town of Wareham is approximately 8 miles away and Wareham train station is ideal for commuters looking to travel to London.

Copyright: - All photos, videos, and drone footage are copyrighted by Stour Estates. All rights reserved.

Any redistribution or reproduction of part or all of the contents in any form is prohibited other than the following:

1. You may print or download to local hard disk extracts for your personal and non-commercial use.
2. You may copy the content to individual third parties for their personal use, but only if you acknowledge Stour Estates as the source of the material.

You may not, except with our express written permission, distribute or commercially exploit the content. Nor may you transmit it or store it on any other website or another form of the electronic retrieval system.

Tel: 01202 287847



Road Map



Hybrid Map



Terrain Map



Floor Plan

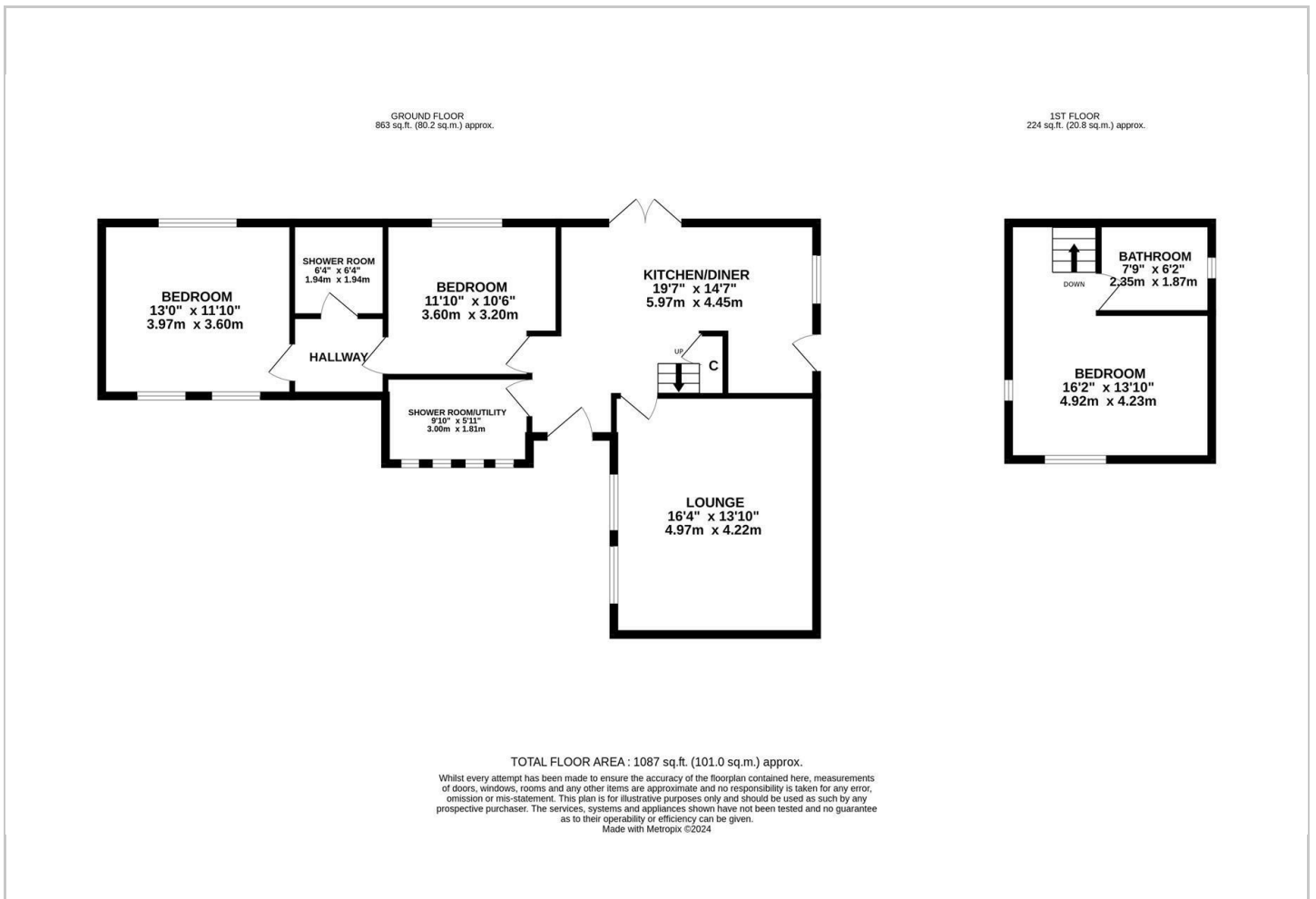

Viewing

Please contact our Stour Estates Office on 01202 287847 if you wish to arrange a viewing appointment for this property or require further information.

Energy Efficiency Graph

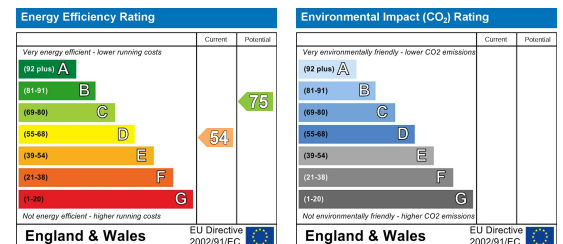

These particulars, whilst believed to be accurate are set out as a general outline only for guidance and do not constitute any part of an offer or contract. Intending purchasers should not rely on them as statements of representation of fact, but must satisfy themselves by inspection or otherwise as to their accuracy. No person in this firm's employment has the authority to make or give any representation or warranty in respect of the property.