



# 11 Marquis Way

Bearwood, Bournemouth, BH11 9TL

**Offers in excess of £275,000**



# 11 Marquis Way

Bearwood, Bournemouth, BH11 9TL

**Offers in excess of £275,000**



A well presented two bedroom end of terrace house, situated in the popular residential area of Bearwood. The accommodation comprises an entrance hall with the kitchen located at the front of the property. The kitchen benefits from a range of wall mounted cupboards and base units with work surface over. The kitchen houses space for utilities such as an oven, fridge/freezer and washing machine. The lounge is located at the rear of the property and has sliding double glazed patio doors leading on to the sunny, low maintenance rear garden. There is also an under stairs storage cupboard.

The first floor comprises of two bedrooms. The landing area benefits from an airing cupboard housing the hot water tank. There is also access to the loft via a hatch. The master bedroom is a double room with the second bedroom benefiting from a built in wardrobe and storage cupboards. The bathroom has part tiled walls and benefits from a bath with shower over, WC, wash basin with vanity unit and heated towel rail.

Externally the rear garden is low maintenance with a slabbed patio area and shed. There is access at the side of the garden which leads on to a path. At the front there is a driveway providing off road parking and a laid lawn.

The property is located in the popular residential area of Bearwood, BH11. Local shopping facilities are within close proximity along with bus routes servicing Bournemouth & Poole. A range of both primary and secondary schools are within the local area.

Copyright: - All photos, videos, and drone footage are copyrighted by Stour Estates. All rights reserved.

Any redistribution or reproduction of part or all of the contents in any form is prohibited other than the following:

1. You may print or download to local hard disk extracts for your personal and non-commercial use.
2. You may copy the content to individual third parties for their personal use, but only if you acknowledge Stour Estates as the source of the material.

You may not, except with our express written permission, distribute or commercially exploit the content. Nor may you transmit it or store it on any other website or another form of the electronic retrieval system.





## Road Map

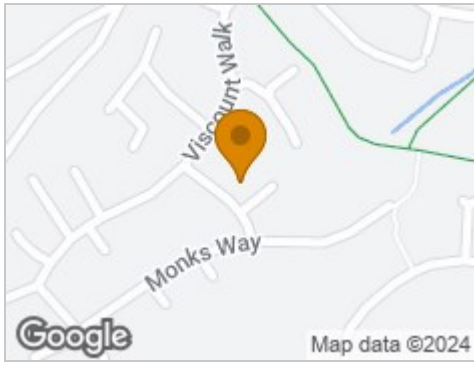

## Hybrid Map



## Terrain Map

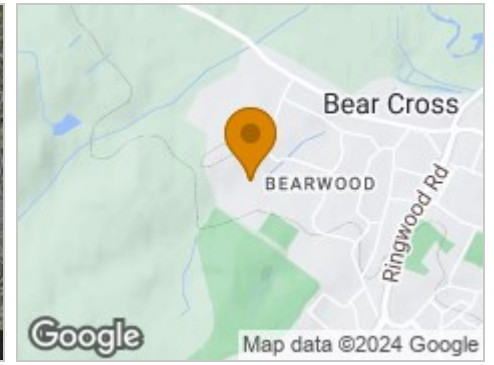

## Floor Plan

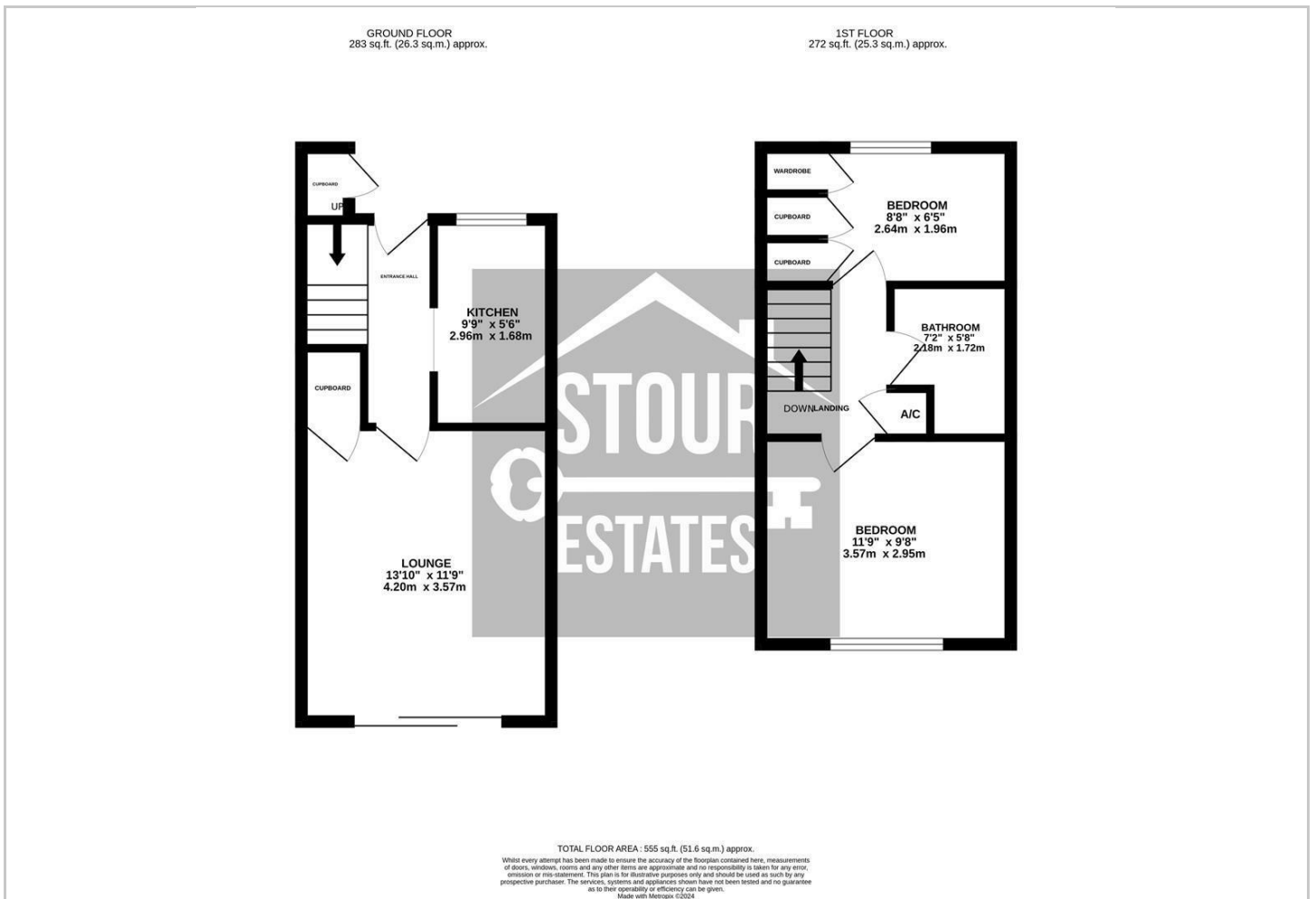

## Viewing

Please contact our Stour Estates Office on 01202 287847 if you wish to arrange a viewing appointment for this property or require further information.

## Energy Efficiency Graph

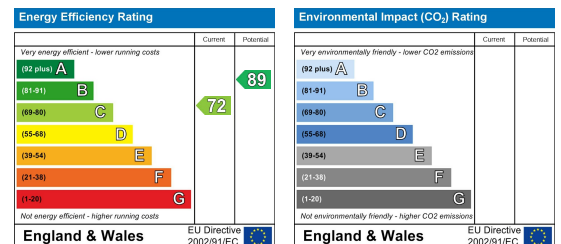

These particulars, whilst believed to be accurate are set out as a general outline only for guidance and do not constitute any part of an offer or contract. Intending purchasers should not rely on them as statements of representation of fact, but must satisfy themselves by inspection or otherwise as to their accuracy. No person in this firm's employment has the authority to make or give any representation or warranty in respect of the property.