



Ground Floor, Greenford Avenue | Southall | UB1 2AF

£365,000

Hiltons Estates present this spectacular 3 bedroom ground floor Maisonette accommodated by a Share of Freehold. NO SERVICE CHARGE and NO GROUND RENT. This property benefits from 3 bedrooms, a fully fitted kitchen with access to a private garden and a family bathroom. There is a allocated parking space. An excellent opportunity for new Homeowners, Commuters and INVESTORS! Located on the doorstep of Southall Broadway and walking distance to local amenities, Shops, Schools and High Street Banks. Transport links such as Southall mainline railway station/Crossrail with direct trains to London Heathrow & Paddington. A brilliant Opportunity not to be missed! Call NOW for further details. Viewings Available.



GROUND FLOOR
710 sq.ft. (66.0 sq.m.) approx.

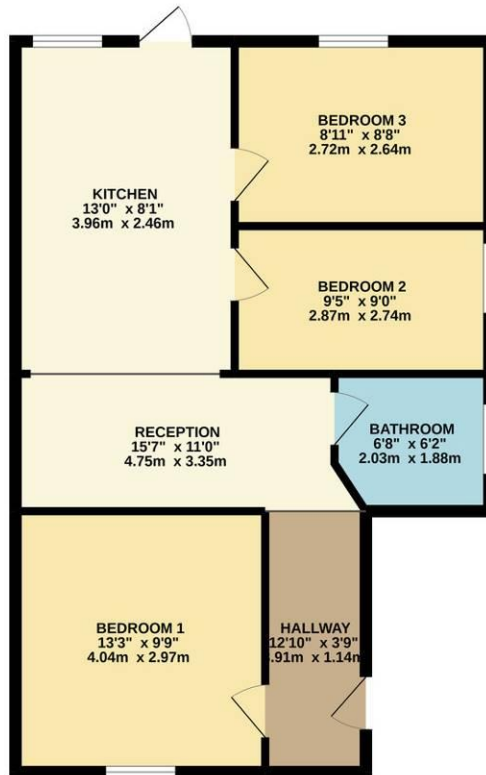

TOTAL FLOOR AREA : 710 sq ft. (66.0 sq.m.) approx.
 Whilst every attempt has been made to ensure the accuracy of the floorplan contained here, measurements of doors, windows, rooms and any other items are approximate and no responsibility is taken for any error, omission or mis-statement. This plan is for illustrative purposes only and should be used as such by any prospective purchaser. The services, systems and appliances shown have not been tested and no guarantee as to their operability or efficiency can be given.
 Made with Metropix ©2022

Contact Details

243 The Broadway

Southall

Middlesex

UB1 1NF

www.hiltons-estates.com

Rajneev@hiltons-estates.com

02085741999

Energy Efficiency Rating		Current	Potential
Very energy efficient - lower running costs			
(92-100)	A		
(81-91)	B		
(69-80)	C	74	74
(55-68)	D		
(39-54)	E		
(21-38)	F		
(1-20)	G		
Not energy efficient - higher running costs			
England, Scotland & Wales		EU Directive 2002/91/EC	

Agents Note: Whilst every care has been taken to prepare these sales particulars, they are for guidance purposes only. All measurements are approximate and for general guidance purposes only and whilst every care has been taken to ensure their accuracy, they should not be relied upon and potential buyers are advised to recheck the measurements