



10 Moira Road

Donisthorpe | DE12 7QE | Guide Price of £190,000 - £200,000

ROYSTON
& LUND

- Guide Price of £190,000 - £200,000
- Large West-Facing Garden
- Adjacent Dining Room
- Bathroom with Seperate Shower
- Freehold Property
- Two Bedroom Semi-Detached
- Living Room with Log Burner
- Kitchen with Integrated Electric Hob / Oven
- Short Walk to Donisthorpe Woodland Park
- EPC Rating - E / Council Tax Band - A





Guide Price £190,000 - £200,000

Stepping through the front door, the layout immediately feels welcoming. The accommodation begins with the first reception room, a dining room that flows naturally through to a cosy living room centred around a charming log burner.

Beyond this, you'll find the kitchen, fitted with neutral cabinets topped with solid wooden worktops and equipped with an integrated electric hob and oven, with space to accommodate a fridge, washing machine and dishwasher.

From here, side access leads out to the large west-facing garden, a sunny outdoor space laid to slabbed patio with a further paved area with conifers around the perimeter providing privacy. There's a small detached utility space and a workshop at the bottom of the garden.

Upstairs, two well-proportioned bedrooms are served by a contemporary bathroom with a separate walk-in shower. To the front of the property there's off-road parking for two vehicles.

This home is just a short walk from Donisthorpe Woodland Park, a 36-hectare former colliery site in the National Forest with mixed woodland and more than 3 km of surfaced paths linking into the Ashby Woulds Heritage Trail — popular for walking, cycling and family days out in nature.

For more information - https://reports.sprift.com/property-report/?access_report_id=4953580



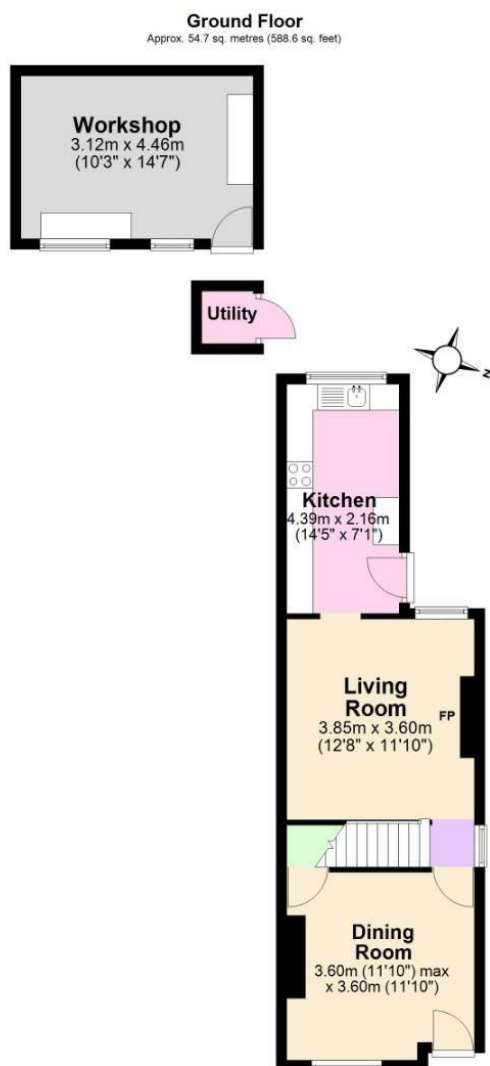

Total area: approx. 91.4 sq. metres (983.9 sq. feet)

These particulars, whilst believed to be accurate are set out as a general outline only for guidance and do not constitute any part of an offer or contract. Intending purchasers should not rely on them as statements of representation of fact, but must satisfy themselves by inspection or otherwise as to their accuracy. No person in this firm's employment has the authority to make or give any representation or warranty in respect of the property.



EPC

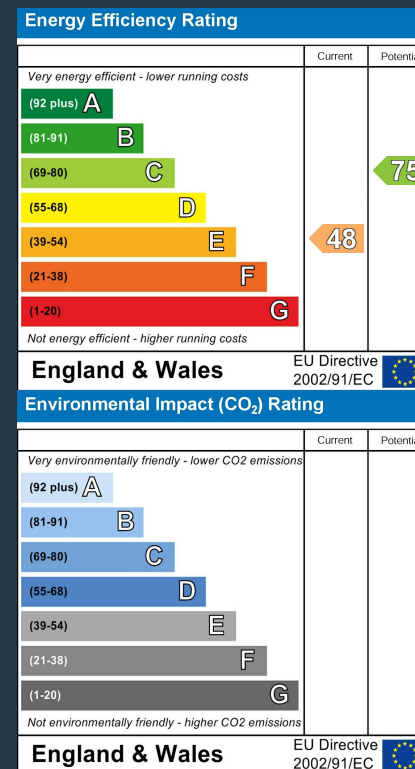

**ROYSTON
& LUND**