

STOUGHTON ROAD



STOUGHTON ROAD

GUILDFORD, SURREY, GU2 9PG

A bright, one double bedroom ground floor apartment within easy reach of Surrey Research Park and Guildford town centre.

Available: 15th December 2025

£1,050 PCM (Per Calendar Month)

Flat, 1 Bedroom, 1 Bathroom, 1 Reception,
Unfurnished

Key Features

- Neutrally decorated
- Close to local amenities
- One bedroom
- One bathroom
- One reception room
- Available December
- Council tax band A





THE PROPERTY

Description

With its own entrance to the side of the property this ground floor flat is in good condition having recently been updated.

The property forms part of a Victorian house, with the living room to the front of the property, benefitting from a useful storage cupboard. This leads onto a large double bedroom with fitted wardrobes. The white modern kitchen is in the middle of the property, with a 5 ring gas hob. The bathroom is located to the rear of the apartment with a shower over the bath.

The property has gas central heating and is double glazed.



Location

The apartment is close to the Worplesdon Road parade of shops, with pharmacy, newsagent, bakery and various takeaway restaurants. There are regular buses into Guildford where there is a main line train station as well as an abundance of shopping, restaurants and night life.

Available December

Holding fee £242

EPC Band D

Guildford Borough Council tax band A: £1592.00 (2025/26)



Stoughton Road, Guildford, GU2

Approximate Area = 497 sq ft / 46 sq m
For identification only - Not to scale

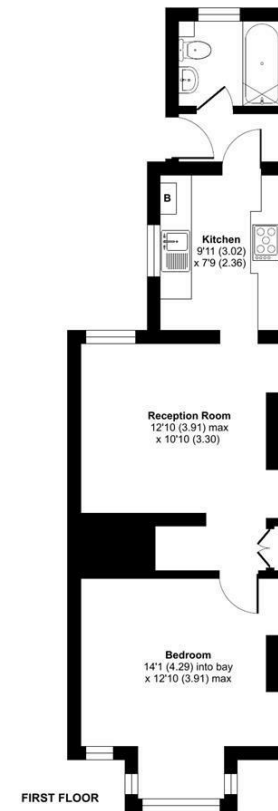

Floor plan produced in accordance with RICS Property Measurement Standards incorporating International Property Measurement Standards (IPMS2 Residential). © richcom 2022. Produced for Grantleys. REF: 816556

Guildford

Poyle House 24 Epsom Road
Guildford
Surrey
GU1 3LE

Tel: 01483 407600

