

# HAYDON PLACE





## HAYDON PLACE

SURREY, GU1 4LR

A fantastic two double bedroom, two bathroom town house in an excellent Guildford town centre location with off street parking.

---

Available: 28th June 2024

£1,900 PCM (Per Calendar Month)

House - Terraced - 2 Bedroom - 2 Bathroom - 1 Reception

### Key Features

- Guildford town centre
- Two bedrooms
- Available late June
- Off street parking
- Two bathrooms



## THE PROPERTY

### Description

The property has been built to a very high specification, including oak flooring, under floor heating on the ground floor and mood lighting system. On the ground floor is an open plan kitchen and living area fitted with Miele oven, hob, extractor, dishwasher, fridge & freezer. On the first floor is the master double bedroom with wood flooring, and ensuite shower room with automatic lighting. There is also a laundry room with Bosch washing machine and tumble dryer. The second floor includes a second double bedroom with carpet and a bathroom, also with automatic lighting. Outside to the front is off street parking for one car.





## Location

Haydon Place is located in the very heart of Guildford town centre, with the new Waitrose on your door step. Guildford High Street is a short walk away and provides a large selection of shops, nightlife and restaurants, also within walking distance is Guildford main line station with regular, fast trains to London Waterloo.

Available late June

Guildford Borough Council tax band D.

Holding deposit: £438

EPC rating C

NB The letting of this property is on behalf of a Connected Person to Grantley



NOT TO SCALE

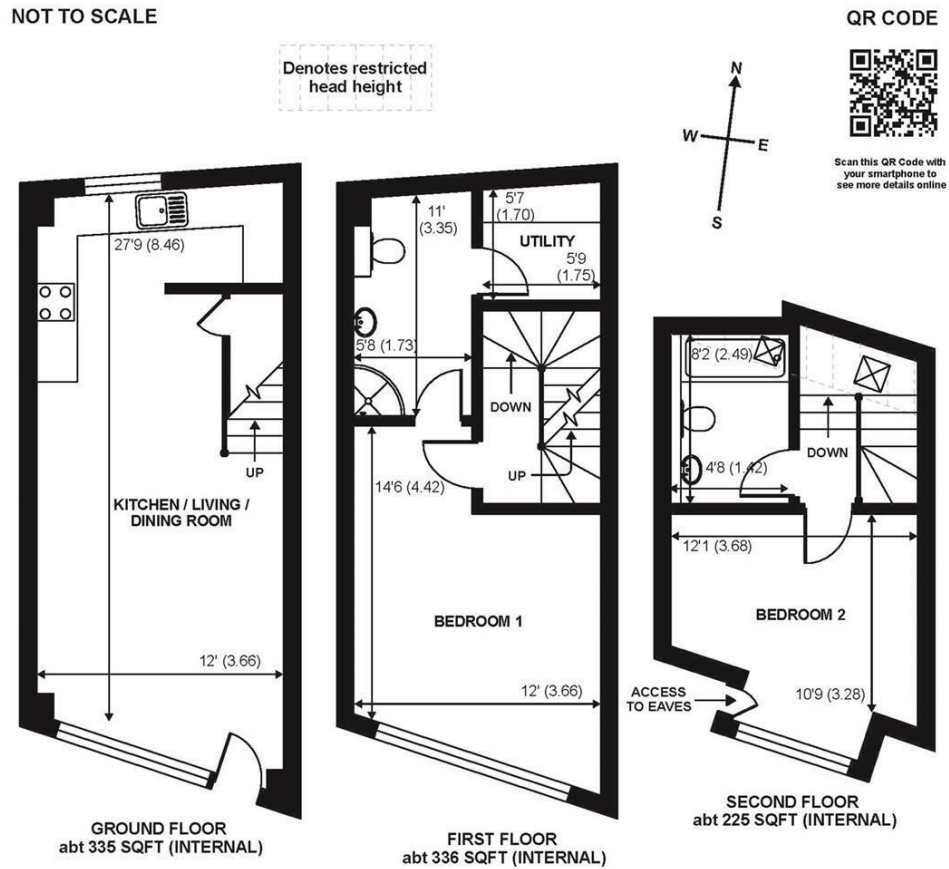

QR CODE



Scan this QR Code with your smartphone to see more details online

## Guildford

Poyle House 24 Epsom Road

Guildford

Surrey

GU1 3LE

Tel: 01483 407600

