



2A Bishops Road Sutton Coldfield, Birmingham, B73 6HX

Exceptional OPPORTUNITY to acquire this GORGEOUS DETACHED FAMILY HOME located a stones throw away from the heart of Sutton Coldfield town centre.

REQUIRES SOME REFURBISHMENT - including windows, carpets and flooring and decor.
Superb POTENTIAL to modernise/extend and UPLIFT IN VALUE.

The property benefits from a private driveway and integral double garage, providing ample off road parking, with the accommodation comprising of an entrance hall and guest WC, fitted kitchen with utility area, formal dining room, and a living room with french doors providing relaxing garden views and access, on the ground floor.

The first floor features a spacious landing area, REFITTED shower room, four double bedrooms, and an en-suite bathroom to the primary bedroom.

Guide price £500,000

2A Bishops Road

Sutton Coldfield, Birmingham, B73 6HX



- Detached Family Home
- Double Garage & Driveway
- Dining Room
- Huge Scope For Improvement/Extension
- Four Double Bedrooms
- Fitted Kitchen & Utility Area
- Refitted Family Shower Room
- Highly Sought After Central Location
- Lounge With French Patio Doors
- En-Suite Bathroom To Primary Bedroom

Entrance Hall

16'6" x 4'5" (5.04 x 1.37)

Kitchen

13'2" x 8'11" (4.02 x 2.74)

Dining Room

14'8" x 9'1" (4.49 x 2.78)

Lounge

14'7" x 13'1" (4.46 x 4.01)

Double Garage

19'4" x 14'11" (5.91 x 4.55)

Guest WC

7'6" x 5'10" (2.31 x 1.80)

Bedroom One

13'0" x 11'7" (3.98 x 3.54)

En-Suite

8'7" x 4'10" (2.64 x 1.49)

Bedroom Two

13'1" x 10'9" (4.00 x 3.28)

Bedroom Three

11'1" x 8'8" (3.40 x 2.65)

Bedroom Four

10'3" x 6'10" (3.13 x 2.10)

Family Bathroom

7'2" x 6'3" (2.20 x 1.92)



[Directions](#)

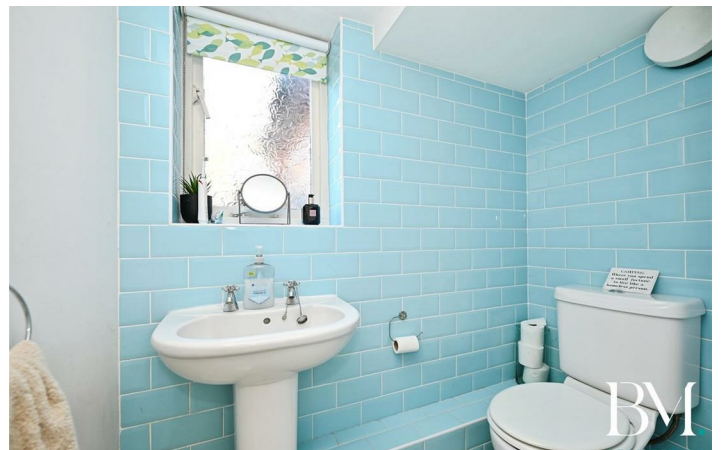

Floor Plan



Ground Floor
Floor area 95.9 sq.m. (1,032 sq.ft.)

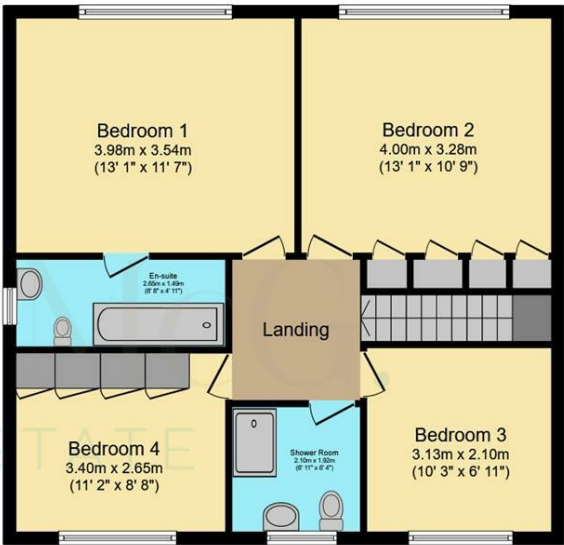

First Floor
Floor area 79.3 sq.m. (854 sq.ft.)

Total floor area: 175.2 sq.m. (1,886 sq.ft.)

This floor plan is for illustrative purposes only. It is not drawn to scale. Any measurements, floor areas (including any total floor area), openings and orientations are approximate. No details are guaranteed, they cannot be relied upon for any purpose and do not form any part of any agreement. No liability is taken for any error, omission or misstatement. A party must rely upon its own inspection(s). Powered by www.Propertybox.io

These particulars, whilst believed to be accurate are set out as a general outline only for guidance and do not constitute any part of an offer or contract. Intending purchasers should not rely on them as statements of representation of fact, but must satisfy themselves by inspection or otherwise as to their accuracy. No person in this firms employment has the authority to make or give any representation or warranty in respect of the property.

