



**DETACHED WAREHOUSE UNIT
ON A SELF-CONTAINED SITE TO LET
23,736 sq ft (2,205.11 sq m)**

**UNIT 2/3
LINK 20
BELLINGHAM WAY
AYLESFORD
KENT ME20 6SP**



DESCRIPTION

The property was constructed in 2001 and sits at the entrance to the estate. It is a self-contained industrial/warehouse unit of steel frame clear span construction with brick and metal cladding elevations, with office and staff amenities at ground and first floor. The unit benefits from a number of key features, including:

- 6.59m eaves rising to 10m at the apex
- 2 full height loading doors
- Secure yard
- Office accommodation
- Heating and lighting throughout
- 23 car parking spaces



2/3

ACCOMMODATION

Ground floor	21,738 sq ft	2,019.50 sq m
First floor	1,998 sq ft	185.61 sq m
Total	23,736 sq ft	2,205.11 sq m

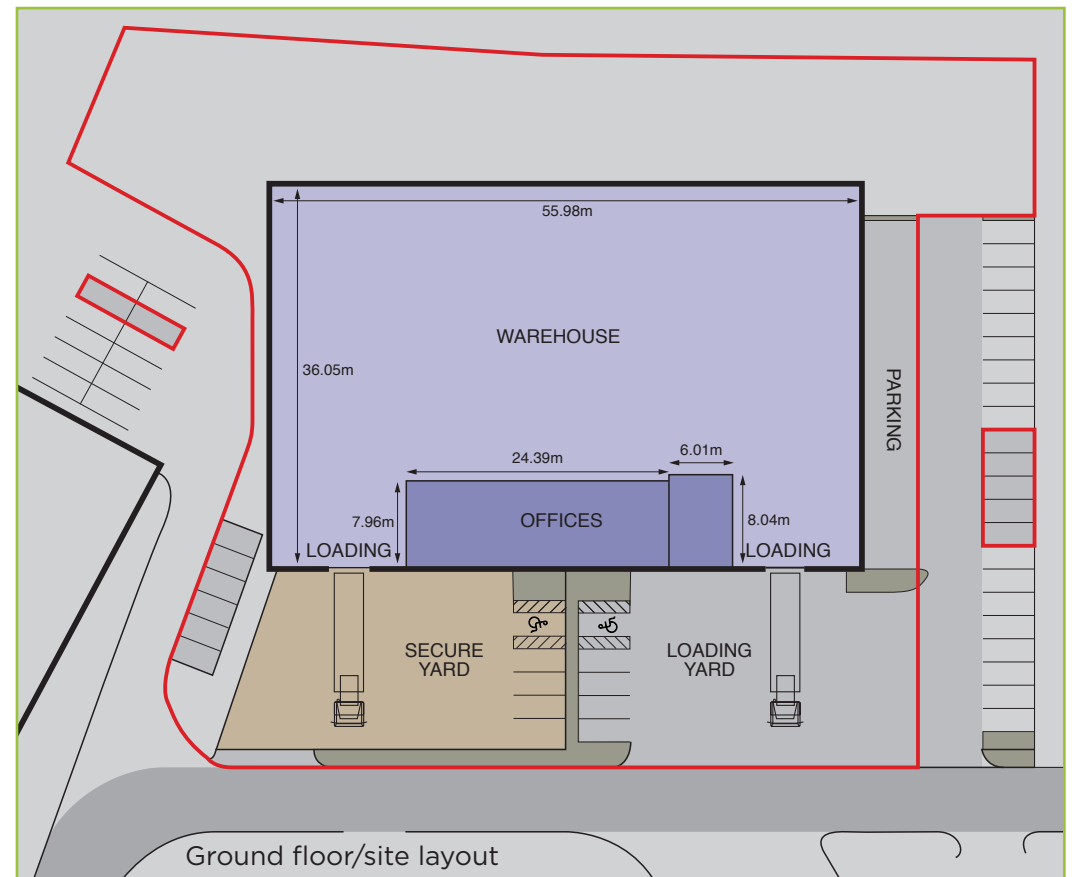

UNIT 2/3 • LINK 20 • BELLINGHAM WAY • AYLESFORD • KENT ME20 6SP



LOCATION

Link 20 sits within the established New Hythe Business Estate and within 1.5 miles of M20 junction 4 via the A228 which also links with the M2 junction 2. The estate supports excellent access to the well-established local and regional markets of Maidstone, the Medway Towns as well as the M25 and national motorway network, Channel Tunnel and Ports.

DRIVE TIMES

	mins	miles
New Hythe Station	3	1
M20 J4	6	1.5
Maidstone	16	7.7
M25 J3	22	15
Sevenoaks	31	13.4
Dartford Tunnel	31	21
Eurotunnel Terminal	44	37

Source: Google maps



Sat Nav ME20 6SP

TENURE

The property is available to let on a new full repairing and insuring lease for a term to be agreed.

RENT

Available upon request.

RATEABLE VALUE

Interested parties should satisfy themselves in this regard.

VIEWING

For further information please contact the sole agent:

CHRIS HARRIS

chris.harris@realestate.bnpparibas
07554 644091

JAMES COGGLE

james.coggle@realestate.bnpparibas
07469 403283



Misrepresentation Act 1967 - Whilst all the information in these particulars is believed to be correct, neither the agent nor their Client guarantee its accuracy nor is it intended to form part of any contract. All areas quoted are approximate. May 2023