



**MOVE INN ESTATES**

MAKING THE RIGHT MOVE



**Cobb Close**

Datchet, Slough, SL3 9QZ

Price Guide £450,000





Floor Plan

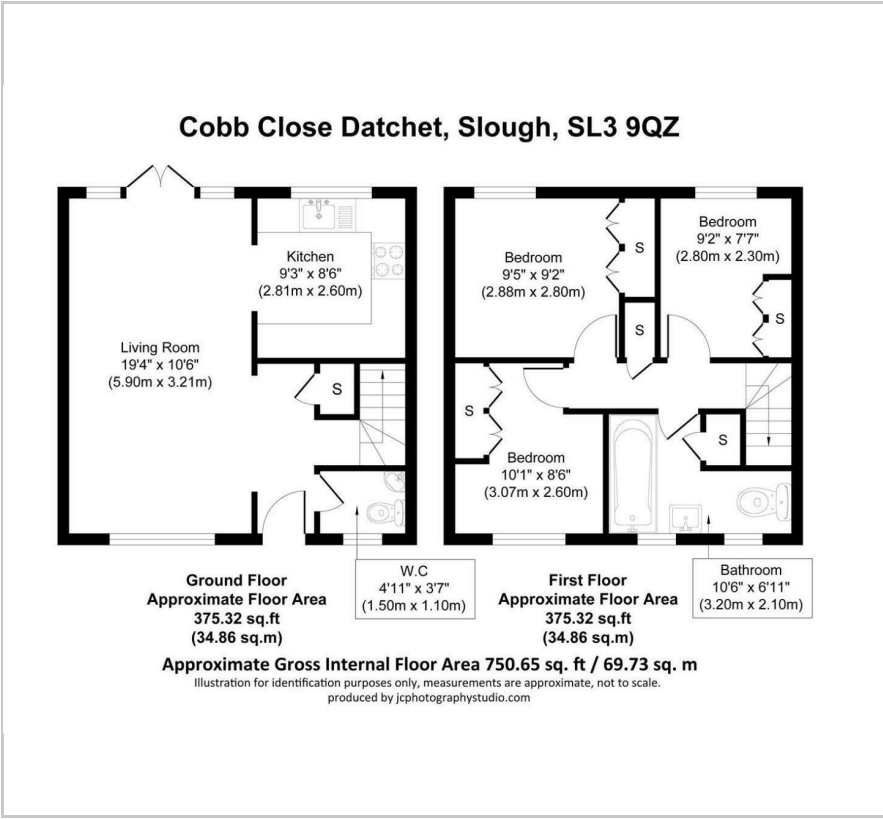

Area Map



Energy Efficiency Graph

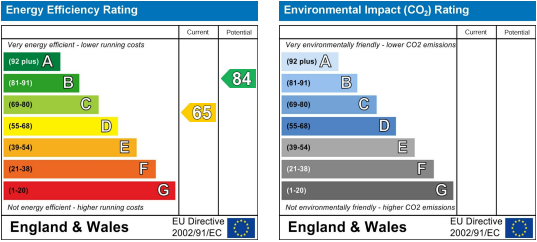

Viewing

Please contact our Move Inn Iver Office on 01753900950 if you wish to arrange a viewing appointment for this property or require further information.

- 3 bedrooms
- Chain Free
- Turn Key
- Datchet Village
- Semi detached
- Recently Renovated
- Great Investment
- Downstairs WC



Welcome to this modernised 3-bedroom semi-detached house located on Cobb Close in the picturesque village of Datchet. This beautifully maintained property comes to the market chain free and in close proximity to local amenities, including the train into Waterloo.



These particulars, whilst believed to be accurate are set out as a general outline only for guidance and do not constitute any part of an offer or contract. Intending purchasers should not rely on them as statements of representation of fact, but must satisfy themselves by inspection or otherwise as to their accuracy. No person in this firms employment has the authority to make or give any representation or warranty in respect of the property.