



MOVE INN ESTATES

MAKING THE RIGHT MOVE



Main Drive

, Iver, SL0 9DP

Price Guide £900,000



Floor Plan

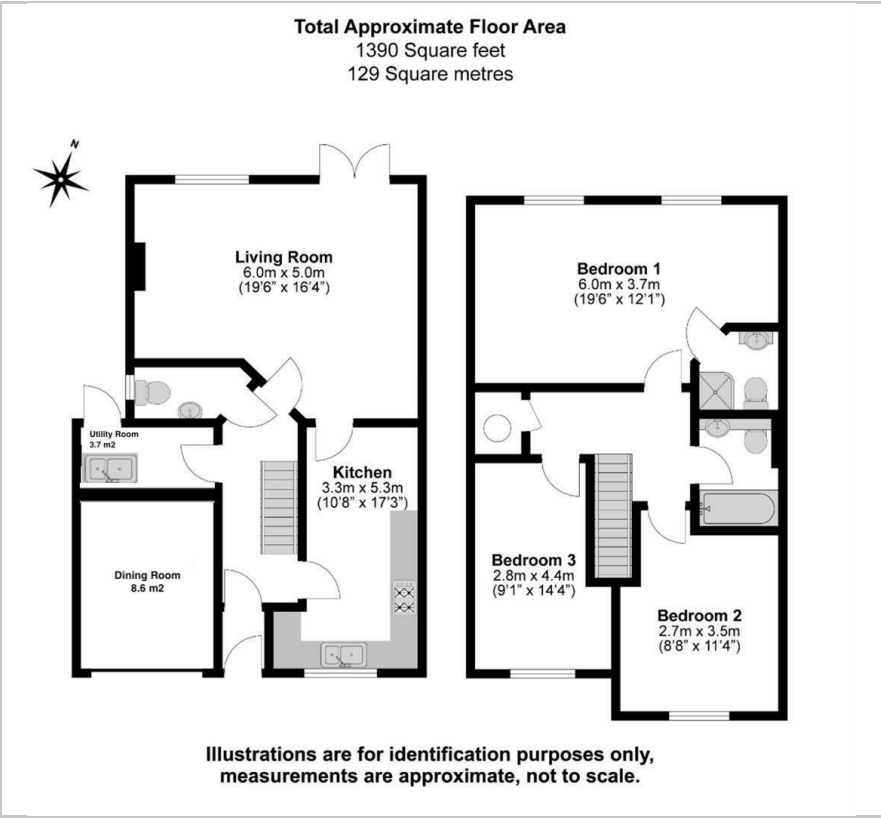

Area Map



Energy Efficiency Graph

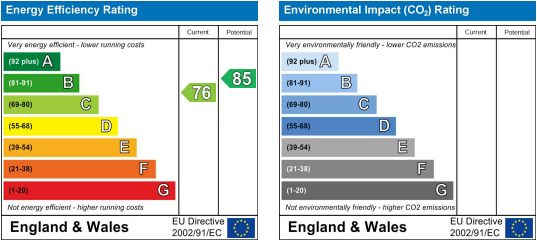

Viewing

Please contact our Move Inn Iver Office on 01753900950 if you wish to arrange a viewing appointment for this property or require further information.

- Three Bedrooms
- Gated Private Road
- Close to Iver Station
- Two Bathrooms
- Driveway
- Sought After Residential Location



Move Inn Estates are delighted to present this beautifully maintained three-bedroom linked semi-detached home, ideally positioned within a gated private road in the ever-popular Richings Park.

This spacious and well-appointed property features three generous bedrooms, two modern bathrooms (including an en-suite), a large 19ft x 16ft living room, a dining room and a separate utility room and a stylish 17ft kitchen/breakfast room—perfect for modern family living.

The home also benefits from approved planning permission for a loft extension, garage conversion, and the addition of bi-fold doors to the rear (Planning Ref: PL/20/3049/FA), offering excellent scope to further enhance the property.

Located in a peaceful yet highly convenient setting, this home is just moments from Richings Park's crosstail station, offering direct services to London Paddington. The area is known for its semi-rural charm while still providing excellent access to local amenities, including golf courses, fitness clubs, and the characterful high street of Iver. Heathrow Airport, Uxbridge town centre, and major motorway links are all within easy reach.

Viewings are highly recommended to appreciate all this wonderful home has to offer.



These particulars, whilst believed to be accurate are set out as a general outline only for guidance and do not constitute any part of an offer or contract. Intending purchasers should not rely on them as statements of representation of fact, but must satisfy themselves by inspection or otherwise as to their accuracy. No person in this firms employment has the authority to make or give any representation or warranty in respect of the property.