



MOVE INN ESTATES

MAKING THE RIGHT MOVE



Maple Crescent

, Slough, SL2 5LR

Price Guide £450,000



Floor Plan

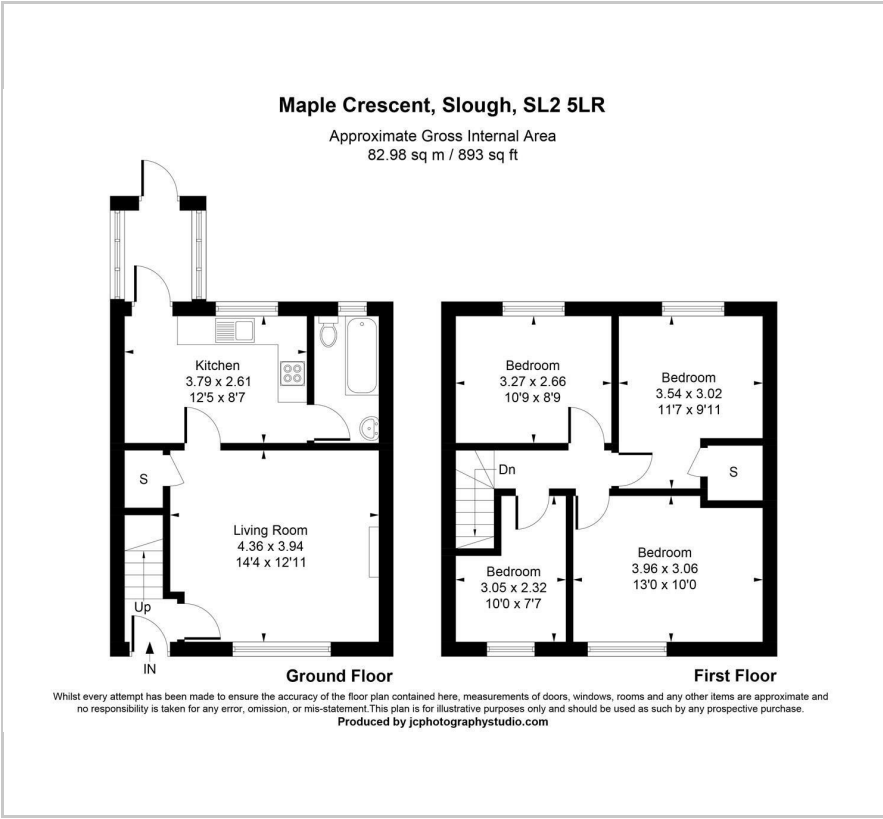

Area Map



Energy Efficiency Graph

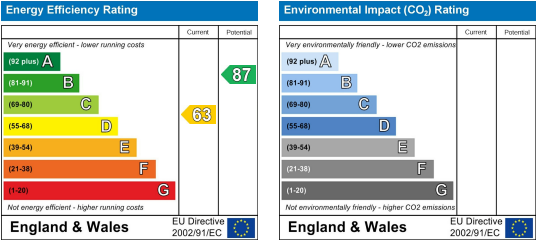

Viewing

Please contact our Move Inn Iver Office on 01753900950 if you wish to arrange a viewing appointment for this property or require further information.

- Chain free
- Four bedroom
- Driveway
- Spacious Garden
- Potential to extend - STPP
- Excellent location



A well-presented four-bedroom mid-terrace house located in the highly sought-after area of Slough, now available chain-free. This property offers a fantastic opportunity for families or investors alike, with the added benefit of potential to extend (subject to planning permission).

Conveniently situated close to local amenities, the property is within easy reach of popular schools, including Iqra, Khalsa, and Wexham Schools. Slough Town Centre, with its mainline railway station and access to the Elizabeth Line, is less than a mile away, offering excellent transport links to Central London and beyond.

The home features a fitted kitchen and bathroom, gas central heating, and double-glazed windows throughout. Externally, the property boasts a driveway providing off-street parking for several vehicles and a generously sized rear garden, perfect for outdoor activities or entertaining.

With its excellent location and scope for further development, this property is highly recommended for viewing.

These particulars, whilst believed to be accurate are set out as a general outline only for guidance and do not constitute any part of an offer or contract. Intending purchasers should not rely on them as statements of representation of fact, but must satisfy themselves by inspection or otherwise as to their accuracy. No person in this firm's employment has the authority to make or give any representation or warranty in respect of the property.