



MOVE INN ESTATES

MAKING THE RIGHT MOVE



Bathurst Walk

, Iver, SL0 9EF

Offers Over £815,000



Floor Plan

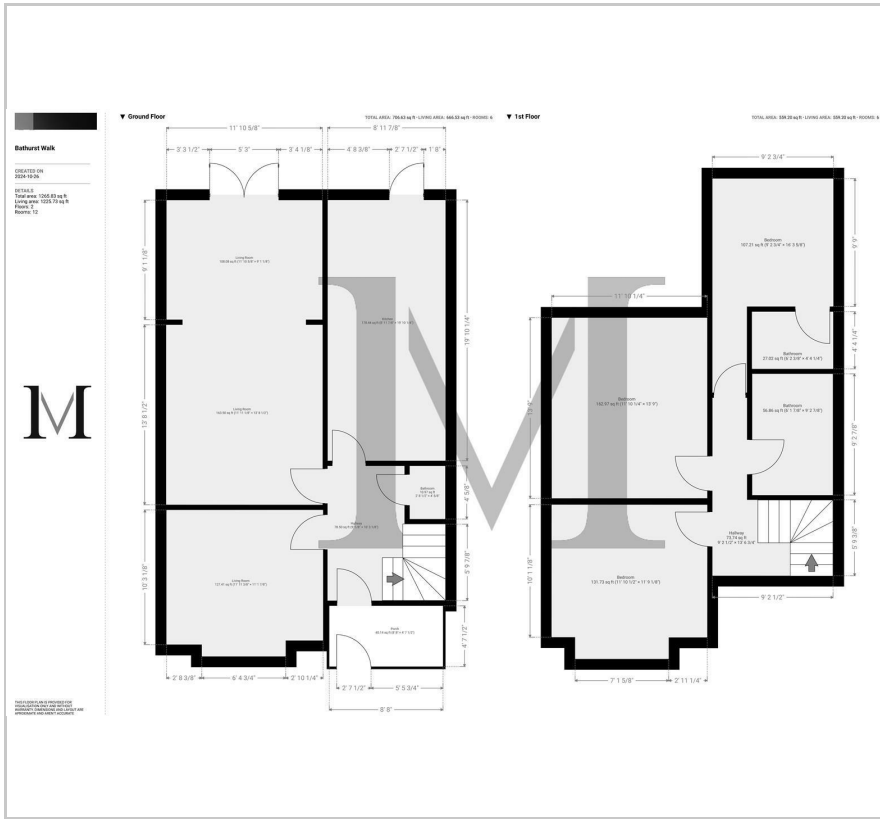

Area Map



Energy Efficiency Graph

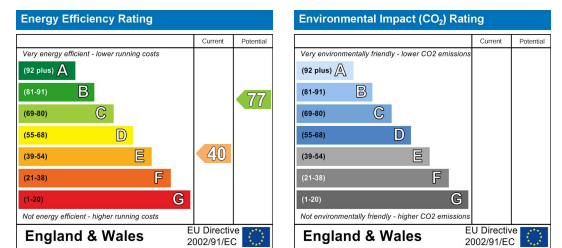

Viewing

Please contact our Move Inn Iver Office on 01753900950 if you wish to arrange a viewing appointment for this property or require further information.

- SEMI DETACHED
- SPACIOUS DRIVEWAY
- WALKING DISTANCE TO IVER STATION
- THREE BEDROOMS
- BEAUTIFUL LARGE GARDEN
- CLOSE TO LOCAL AMENITIES



Move Inn Estates presents this spacious and versatile home on Bathurst Walk, thoughtfully laid out over two floors to accommodate a range of lifestyle needs. Perfectly located in walk distance to Iver Crossrail Station.

The ground floor opens with a welcoming entrance hall that seamlessly connects each main living area. At the front, a bright and airy reception room invites you to relax or entertain, with large windows that flood the space with natural light. Adjoining this is a second reception room, ideal as a family room or dining area, perfectly positioned for easy access to the kitchen and rear garden. The centrally located kitchen serves as the heart of the home, efficiently connecting both the main reception areas and offering convenient access to additional storage and outdoor space. Toward the front of the property, a third reception room provides a flexible space, perfect for a home office, study, or additional lounge.

Situated on Bathurst Walk, this property is conveniently located near Iver's amenities, including local shops, cafes, and well-regarded schools. Iver Station (Crossrail) is just a short walk away, providing excellent transport links into Central London and beyond. The surrounding area is known for its green spaces, including nearby Black Park and Langley Park, which are perfect for outdoor enthusiasts.

This property is ideal for first-time buyers, young families, or investors. Early viewings are highly recommended to appreciate all this home has to offer.



These particulars, whilst believed to be accurate are set out as a general outline only for guidance and do not constitute any part of an offer or contract. Intending purchasers should not rely on them as statements of representation of fact, but must satisfy themselves by inspection or otherwise as to their accuracy. No person in this firm's employment has the authority to make or give any representation or warranty in respect of the property.