



MOVE INN ESTATES
MAKING THE RIGHT MOVE



Tozer Walk

, Windsor, SL4 4NE

£410,000



Floor Plan

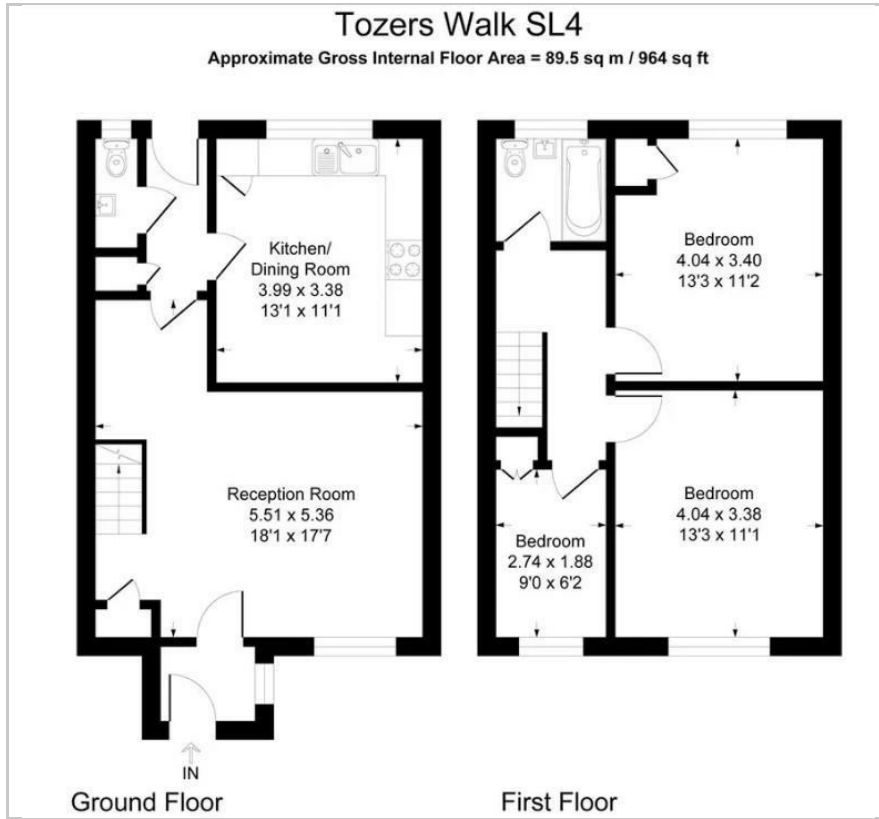

Area Map



Energy Efficiency Graph

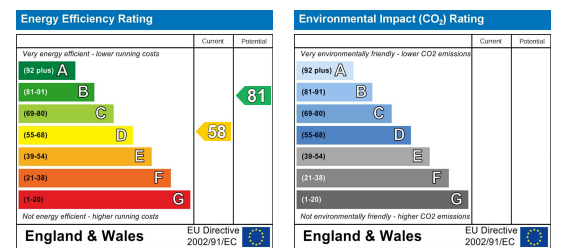

Viewing

Please contact our Move Inn Iver Office on 01753900950 if you wish to arrange a viewing appointment for this property or require further information.



Move Inn Estates present this impeccably maintained semi-detached family home features three spacious double bedrooms, providing ample living space. The ground floor showcases a modern fitted kitchen that opens up to the living and dining areas, creating an ideal setting for entertaining and family gatherings. A cloakroom adds to the convenience.

The property includes a private south-facing garden, perfect for outdoor relaxation and activities. Upstairs, you will find three generously sized double bedrooms and a family bathroom with dual wash hand basins, offering a touch of luxury.

Situated within the catchment area of Windsor's highly regarded Ofsted schools, this home guarantees access to excellent educational opportunities. This property is a must-see for those seeking a blend of modern living, comfort, and prime location.



These particulars, whilst believed to be accurate are set out as a general outline only for guidance and do not constitute any part of an offer or contract. Intending purchasers should not rely on them as statements of representation of fact, but must satisfy themselves by inspection or otherwise as to their accuracy. No person in this firm's employment has the authority to make or give any representation or warranty in respect of the property.