

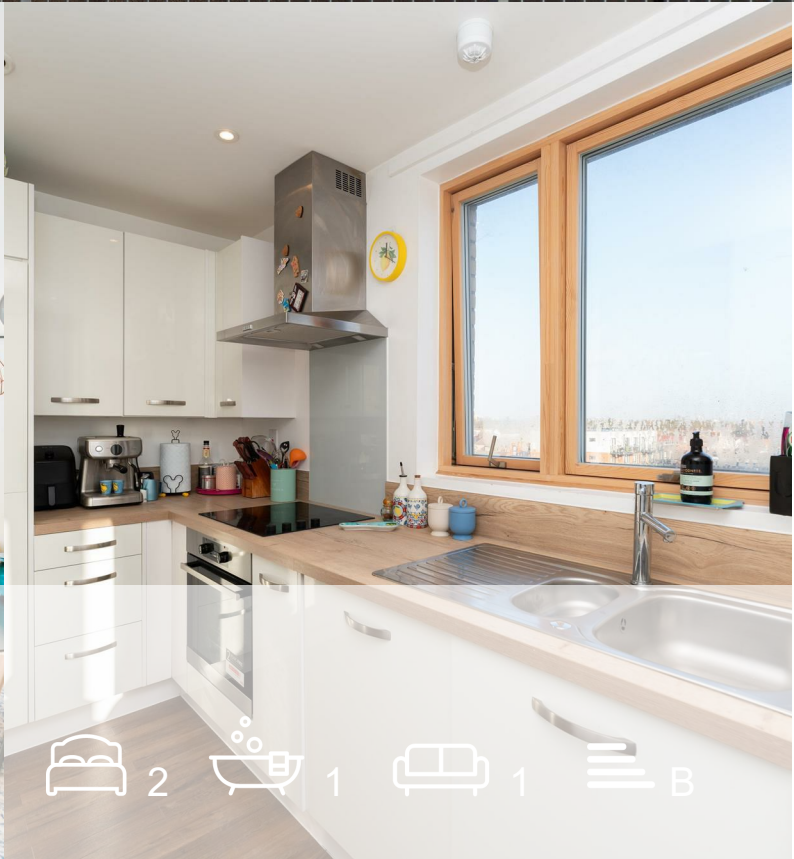

**MOVE INN ESTATES**  
MAKING THE RIGHT MOVE



**Salisbury Road**  
, Southall, UB2 5RD  
Price Guide £335,000

2 1 1 B

## Floor Plan

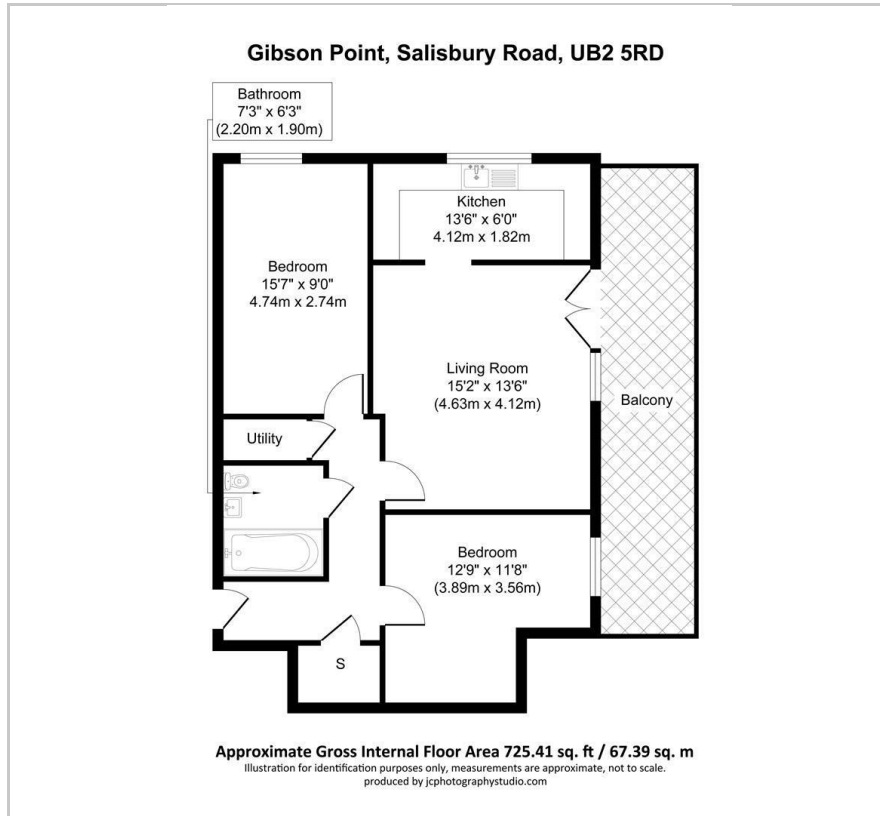

## Area Map



## Energy Efficiency Graph

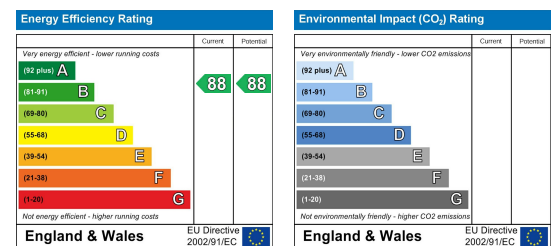

## Viewing

Please contact our Move Inn Iver Office on 01753900950 if you wish to arrange a viewing appointment for this property or require further information.

- Leasehold
- Wheelchair accessible
- Private Balcony
- Lift Access
- Double Glazing
- Service charge and Ground Rent: £165(combined)

Move Inn Estates are delighted to offer to the market this 2bedroom top floor flat on Salisbury Road, Southall. The property offers a well-adapted layout and comfortable accommodation supporting a wide array of individual or collective family activities.

This property has accommodation briefly comprising; There is a living room that draws in an abundance of natural daylight creating a bright and airy feeling throughout. The kitchen is fully equipped with fittings including sleek mounted units and contemporary work surfaces with space for a dining table.

The property is further enhanced by a W/C and a balcony ideal for outdoor seating and entertaining. Externally the property benefits from residents parking.

Located within less than a 1.5-mile drive is Southall Railway Station which provides services to Abbey Wood, Heathrow, Airport and Reading.



These particulars, whilst believed to be accurate are set out as a general outline only for guidance and do not constitute any part of an offer or contract. Intending purchasers should not rely on them as statements of representation of fact, but must satisfy themselves by inspection or otherwise as to their accuracy. No person in this firm's employment has the authority to make or give any representation or warranty in respect of the property.