



LOMBARD STREET

BIRMINGHAM, B12

£850 PER MONTH

Excellent opportunity to rent this 2nd floor one double bedroom apartment in the new Fabrick Square development on Lombard Street. Briefly comprising of entrance hall, open plan lounge and kitchen with built-in appliances, generous size master bedroom and a modern fitted bathroom suite.

PMP | INTERNATIONAL

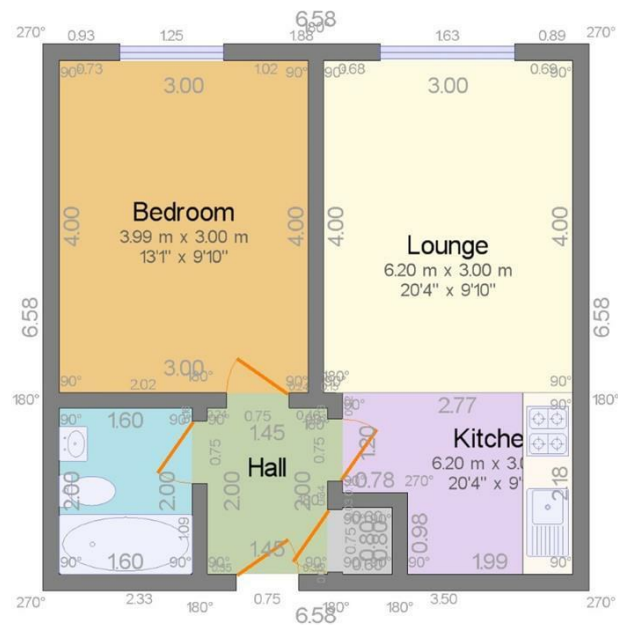

This plan is illustrative only,
its details cannot be relied upon and no liability is taken for any errors.

Floor Plan

Total approx floor area: 38.2 m² (411.1 ft²)
Floor Plan: 38.2 m² (411.1 ft²)



Energy Efficiency Rating		
	Current	Potential
Very energy efficient - lower running costs		
(92 plus) A		
(81-91) B	84	84
(69-80) C		
(55-68) D		
(39-54) E		
(21-38) F		
(1-20) G		
Not energy efficient - higher running costs		
England & Wales	EU Directive 2002/91/EC	

Agents Note: Whilst every care has been taken to prepare these particulars, they are for guidance purposes only. All measurements are approximate and are for general guidance purposes only and whilst every care has been taken to ensure their accuracy, they should not be relied upon and potential buyers/tenants are advised to recheck the measurements

London
PMP International
94 Belsize Lane
Belsize Park
London
NW3 5BE

020 7701 2878
info@pmpi.co.uk
www.pmpi.co.uk

PMP | INTERNATIONAL