



CHAPMAN SQUARE

LONDON, SW19

£640,000
LEASEHOLD

Stylish 2-Bed, 2-Bath Flat with Balcony in Gated Development - SW19

Situated within a well-maintained gated development in the heart of SW19, this beautifully presented two-bedroom, two-bathroom flat offers modern living in a peaceful setting. The property boasts a spacious open-plan living and dining area with direct access to a private balcony.

Both bedrooms are generously sized, with the principal bedroom benefiting from an en-suite bathroom. A second full bathroom serves guests and the second bedroom. The flat is finished to a high standard throughout and offers ample storage space.

PMP | INTERNATIONAL

Chapman Square, SW19 5QU

Approx Gross Internal Area = 74.3 sq m / 800 sq ft

Balcony = 6.55 sq m / 71 sq ft

Total = 80.85 sq m / 871 sq ft

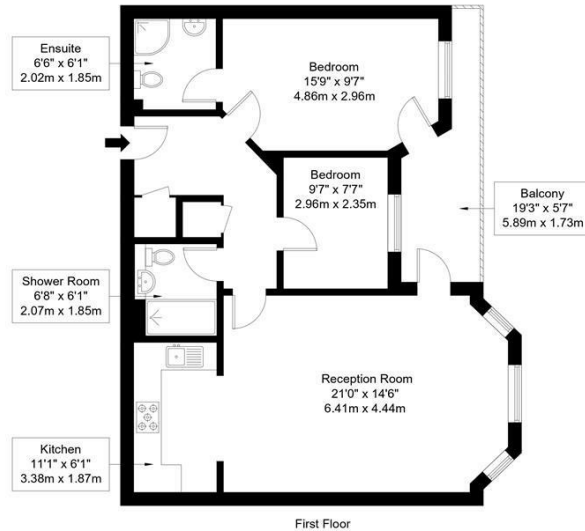

Ref :

Copyright **BLEUPLAN**

The Floor plan is not to scale and measurements and areas shown are approximate and therefore should be used for illustrative purposes only. The plan has been prepared in accordance with the RICS code of Measuring Practice and whilst we have confidence in the information produced it must not be relied on. Maximum lengths and widths are represented on the floor plan. If there is any aspect of particular importance, you should carry out or commission your own inspection of the property.
Copyright @ BLEUPLAN



Energy Efficiency Rating		
	Current	Potential
Very energy efficient - lower running costs		
(92 plus) A		
(81-91) B	84	84
(69-80) C		
(55-68) D		
(39-54) E		
(21-38) F		
(1-20) G		
Not energy efficient - higher running costs		
England & Wales	EU Directive 2002/91/EC	

Agents Note: Whilst every care has been taken to prepare these particulars, they are for guidance purposes only. All measurements are approximate and are for general guidance purposes only and whilst every care has been taken to ensure their accuracy, they should not be relied upon and potential buyers/tenants are advised to recheck the measurements

London
PMP International
94 Belsize Lane
Belsize Park
London
NW3 5BE

020 7701 2878
info@pmpi.co.uk
www.pmpi.co.uk

PMP | INTERNATIONAL