

## FULHAM ROAD

CHELSEA, SW3

£1,050 PER WEEK

A newly redecorated 2 bedroom apartment located on the second floor in a beautiful period mansion block. The apartment comprises two double bedrooms with ample storage, large reception room which is south facing, a good sized kitchen and two bathrooms with an en-suite to the master.

It is located in the heart of Chelsea and has added benefits of an onsite porter, passenger lift and communal gardens. The property is available to rent furnished or unfurnished.

**PMP** | INTERNATIONAL

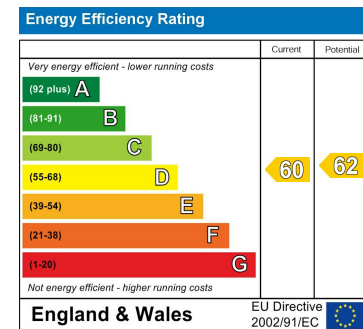
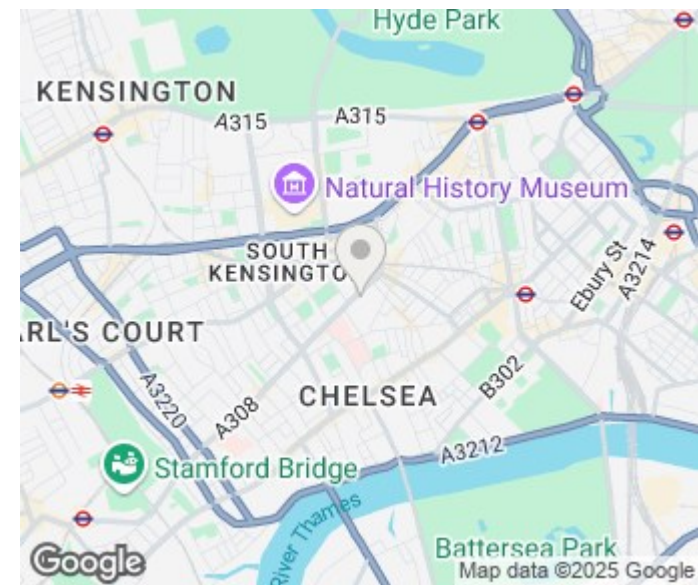
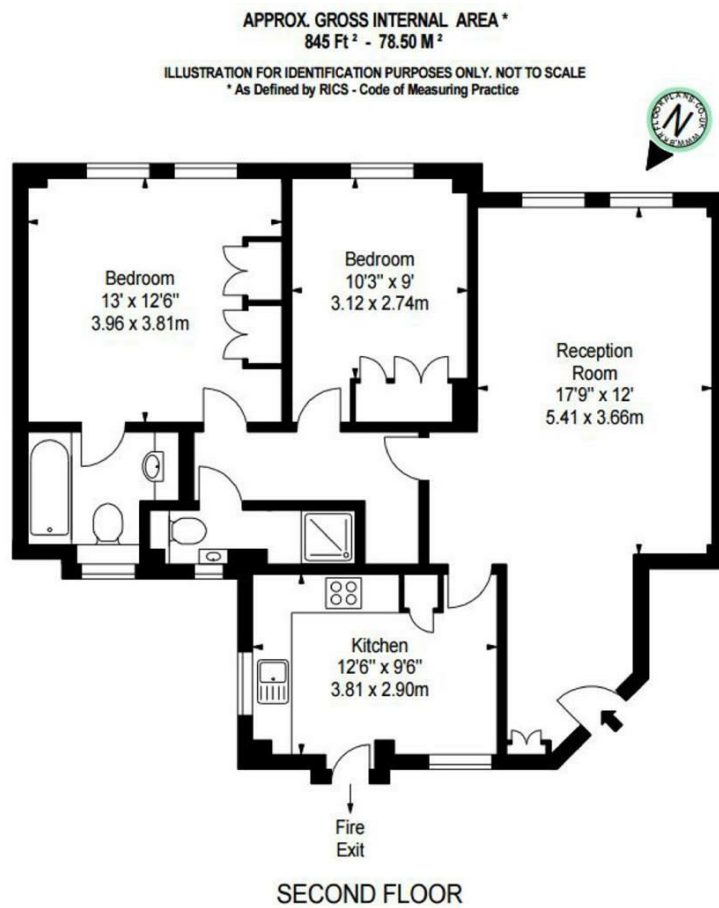

Agents Note: Whilst every care has been taken to prepare these particulars, they are for guidance purposes only. All measurements are approximate and are for general guidance purposes only and whilst every care has been taken to ensure their accuracy, they should not be relied upon and potential buyers/tenants are advised to recheck the measurements

London  
PMP International  
94 Belsize Lane  
Belsize Park  
London  
NW3 5BE

020 7701 2878  
info@pmpi.co.uk  
www.pmpi.co.uk

PMP INTERNATIONAL