

PARKLAND WALK

LONDON, SW6

£4,600

A modern light and spacious two-bedroom apartment in the sought after Kings Road Park development. This beautiful apartment benefits from loads of built-in storage, a state-of-the-art kitchen and a spacious balcony overlooking the communal courtyard.

Residents benefit from onsite facilities including swimming pool, games room, gym and more along with 24 hour concierge.

Situated a stones throw from the King's Road and close to the River Thames, King's Road Park is in one of London's most desirable locations. Perfectly located in Zone 2 and only a 10 minute walk from both an Underground and Overground station.

PMP | INTERNATIONAL

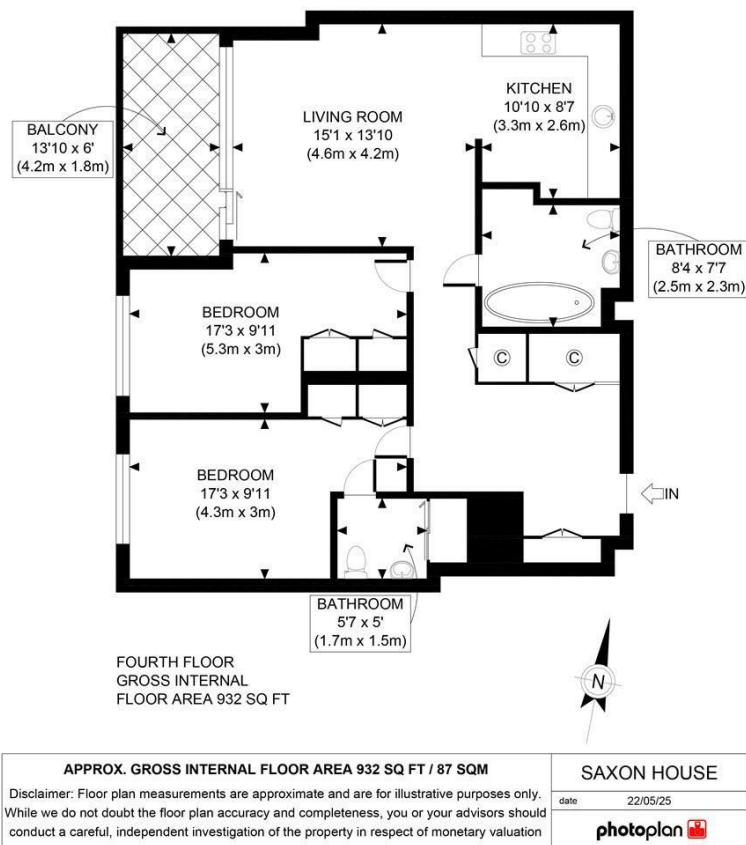

Energy Efficiency Rating		
	Current	Potential
Very energy efficient - lower running costs		
(92 plus) A		
(81-91) B		
(69-80) C		
(55-68) D		
(39-54) E		
(21-38) F		
(1-20) G		
Not energy efficient - higher running costs		
England & Wales	EU Directive 2002/91/EC	

Agents Note: Whilst every care has been taken to prepare these particulars, they are for guidance purposes only. All measurements are approximate and are for general guidance purposes only and whilst every care has been taken to ensure their accuracy, they should not be relied upon and potential buyers/tenants are advised to recheck the measurements

London
PMP International
94 Belsize Lane
Belsize Park
London
NW3 5BE

020 7701 2878
info@pmpi.co.uk
www.pmpi.co.uk

PMP | INTERNATIONAL