

FINCHLEY ROAD

LONDON, NW3

£3,300

Available now is this spacious 3 bed flat situated in the great area of Finchley Road in a portered block next to Finchley Road Tube Station. The property benefits from 3 good sized bedrooms, spacious reception room and fully fitted kitchen, three piece bathroom and ensuite, and wrap around balcony. Offered in great condition and part furnished.

PMP | INTERNATIONAL

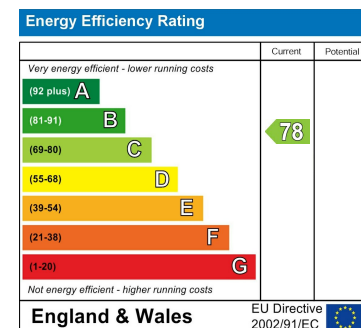
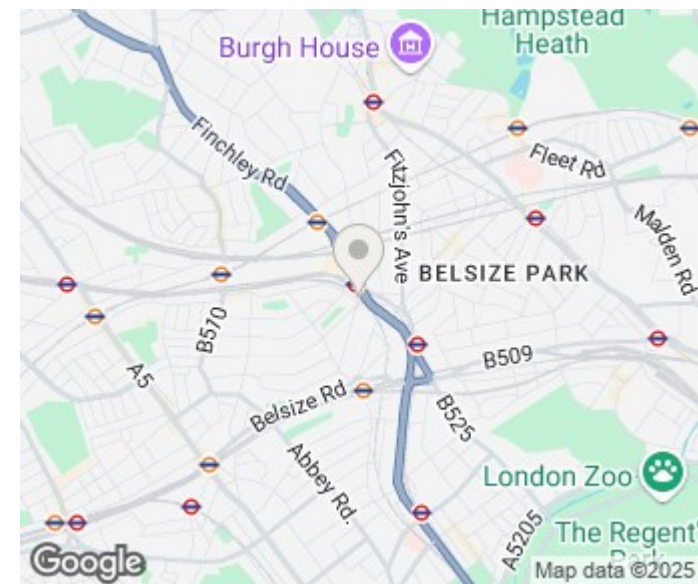
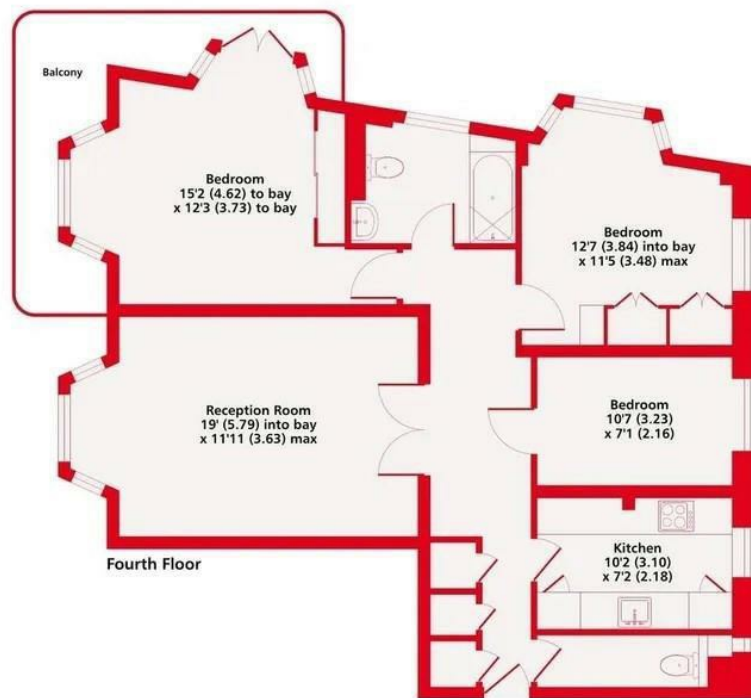

Agents Note: Whilst every care has been taken to prepare these particulars, they are for guidance purposes only. All measurements are approximate and are for general guidance purposes only and whilst every care has been taken to ensure their accuracy, they should not be relied upon and potential buyers/tenants are advised to recheck the measurements

London
PMP International
94 Belsize Lane
Belsize Park
London
NW3 5BE

020 7701 2878
info@pmpi.co.uk
www.pmpi.co.uk

PMP | INTERNATIONAL