

## SKINNER LANE

LEEDS, LS7

£115,000  
LEASEHOLD

Well proportioned 1 bedroom apartment in a recently built block. Located in the Leeds Northern Quarter, close to the centre of Leeds, moments from local amenities and easy access to St James' Hospital. The property is an excellent first home, "lock up and leave" or investment property.

Enquire promptly as these properties are in huge demand.

**PMP** | INTERNATIONAL

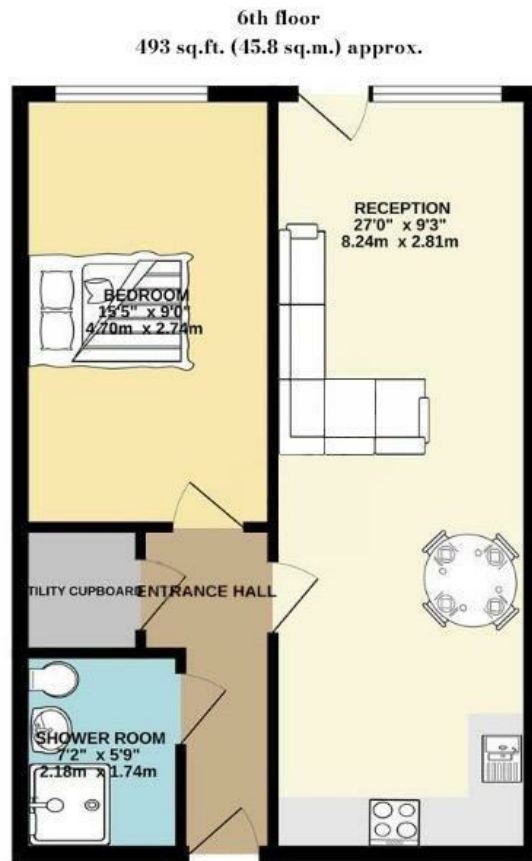

Energy Efficiency Rating		
	Current	Potential
Very energy efficient - lower running costs		
(92 plus) <b>A</b>		
(81-91) <b>B</b>	87	87
(69-80) <b>C</b>		
(55-68) <b>D</b>		
(39-54) <b>E</b>		
(21-38) <b>F</b>		
(1-20) <b>G</b>		
Not energy efficient - higher running costs		
<b>England &amp; Wales</b>	EU Directive 2002/91/EC	

Agents Note: Whilst every care has been taken to prepare these particulars, they are for guidance purposes only. All measurements are approximate and are for general guidance purposes only and whilst every care has been taken to ensure their accuracy, they should not be relied upon and potential buyers/tenants are advised to recheck the measurements

London  
PMP International  
94 Belsize Lane  
Belsize Park  
London  
NW3 5BE

020 7701 2878  
info@pmpi.co.uk  
www.pmpi.co.uk

**PMP** | INTERNATIONAL