



PORTMAN SQUARE MARYLEBONE, W1H

£1,000 PER WEEK

**VIDEO VIEWINGS AVAILABLE FROM THE COMFORT OF YOUR OWN HOME* *Please enquire for further details.

A very well presented 2 bedroom flat located in Portman Square seconds to Selfridges, Oxford Street and Marylebone Village.

The flat is located on the 7th floor of this portered block and benefits from lots of natural light and is spacious throughout. The flat comprises of a large reception, separate modern kitchen, solid oak floor, large bathroom with modern fixtures and fittings. Available now and viewings are highly recommended.

PMP | INTERNATIONAL

Portman Square, W1H
 Approx. Gross Internal Area
 666 Sq Ft - 61.87 Sq M

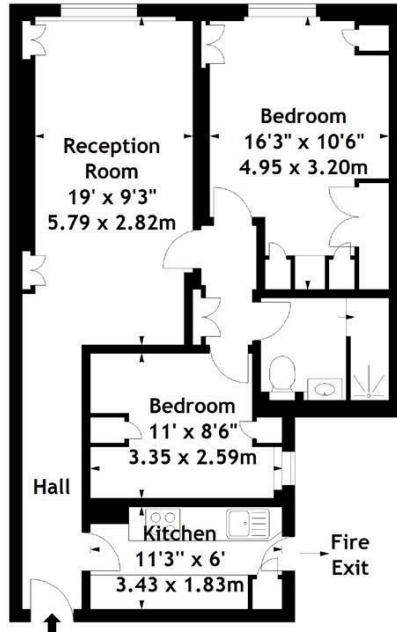

Seventh Floor

Measured in accordance with RICS guidelines. Every attempt is made to ensure accuracy, however all measurements are approximate. This floor plan is for illustrative purposes only and is not to scale.
 © Datography Ltd 2016
 Photographs * Floorplans * Virtual Tours
 Tel: 0845 643 4401 www.datography.com



| Energy Efficiency Rating | | |
|---|-------------------------|-----------|
| | Current | Potential |
| Very energy efficient - lower running costs | | |
| (92 plus) A | | |
| (81-91) B | | |
| (69-80) C | 74 | 80 |
| (55-68) D | | |
| (39-54) E | | |
| (21-38) F | | |
| (1-20) G | | |
| Not energy efficient - higher running costs | | |
| England & Wales | EU Directive 2002/91/EC | |

Agents Note: Whilst every care has been taken to prepare these particulars, they are for guidance purposes only. All measurements are approximate and are for general guidance purposes only and whilst every care has been taken to ensure their accuracy, they should not be relied upon and potential buyers/tenants are advised to recheck the measurements

London
 PMP International
 1 Northway's Parade Finchley Road
 London
 NW3 5EN

020 7701 2878
 info@pmpi.co.uk
 www.pmpi.co.uk

PMP | INTERNATIONAL