



## TOWNSHEND COURT

ST JOHNS WOOD, NW8

£3,200

Newly refurbished 3 bedroom property situated in a beautiful purpose built block in the very central location of St Johns Wood. Townshend Court is ideally located within moments of Regents Park, St Johns Wood High Street and transport links. This bright 2 bed boasts stunning parquet flooring and comprises of 2 double bedrooms, reception room, fitted kitchen and bathroom suite with shower. Viewings are highly recommended. \*Awaiting updated photographs\*

**PMP** | INTERNATIONAL

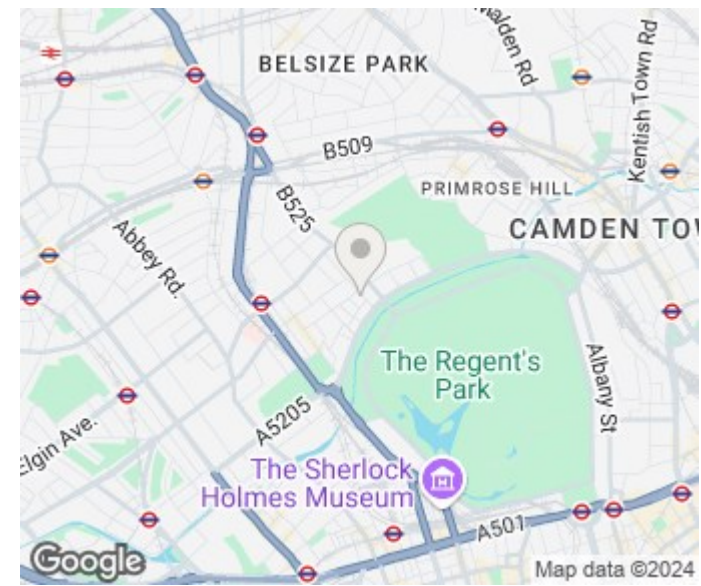
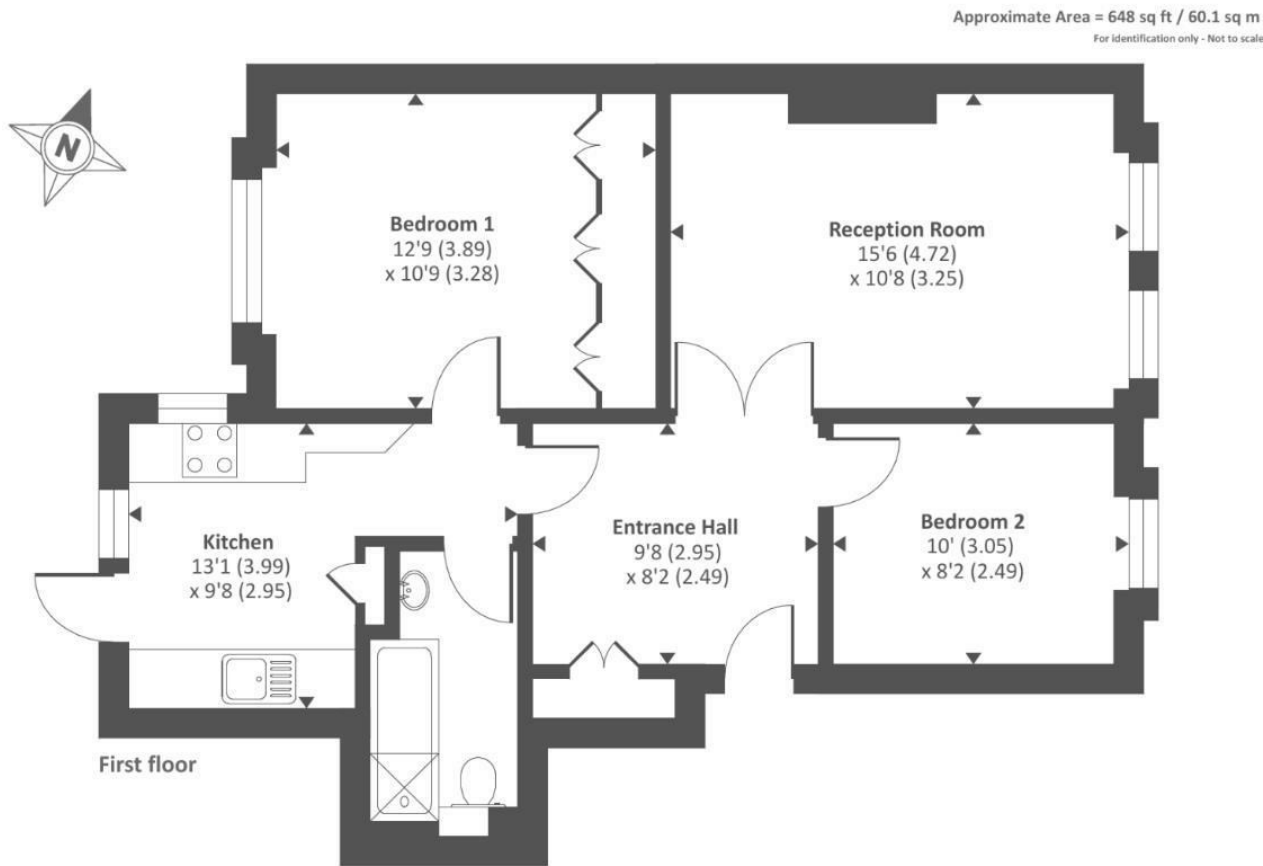

| Energy Efficiency Rating                    |                            |           |
|---|----------------------------|-----------|
|   | Current                    | Potential |
| Very energy efficient - lower running costs |                            |           |
| (92 plus) <b>A</b>                          |                            |           |
| (81-91) <b>B</b>                            |                            |           |
| (69-80) <b>C</b>                            |                            |           |
| (55-68) <b>D</b>                            |                            |           |
| (39-54) <b>E</b>                            |                            |           |
| (21-38) <b>F</b>                            |                            |           |
| (1-20) <b>G</b>                             | <b>1</b>                   | <b>1</b>  |
| Not energy efficient - higher running costs |                            |           |
| <b>England &amp; Wales</b>                  | EU Directive<br>2002/91/EC |           |

Agents Note: Whilst every care has been taken to prepare these particulars, they are for guidance purposes only. All measurements are approximate and are for general guidance purposes only and whilst every care has been taken to ensure their accuracy, they should not be relied upon and potential buyers/tenants are advised to recheck the measurements

London  
PMP International  
1 Northway's Parade Finchley Road  
London  
NW3 5EN

020 7701 2878  
info@pmpi.co.uk  
www.pmpi.co.uk

**PMP** | INTERNATIONAL