

RADLEY HOUSE GLOUCESTER PLACE

MARYLEBONE, NW1 6DP

£760 PER WEEK

OPPOSITE THE LONDON BUSINESS SCHOOL Centrally located on Gloucester Place is this generously sized 2 bedroom apartment in Radley House, a purpose built block with caretaker. The property comprises of a reception room, fully fitted kitchen, 2 double bedrooms and a bathroom suite.

Gloucester Place is ideally situated within a 5 minute walk of Baker Street amenities and transport links. Viewings are highly recommended.

PMP | INTERNATIONAL

Radley House, NW1 6DP

Approx. Gross Internal Area = 64.8 sq m / 697 sq ft

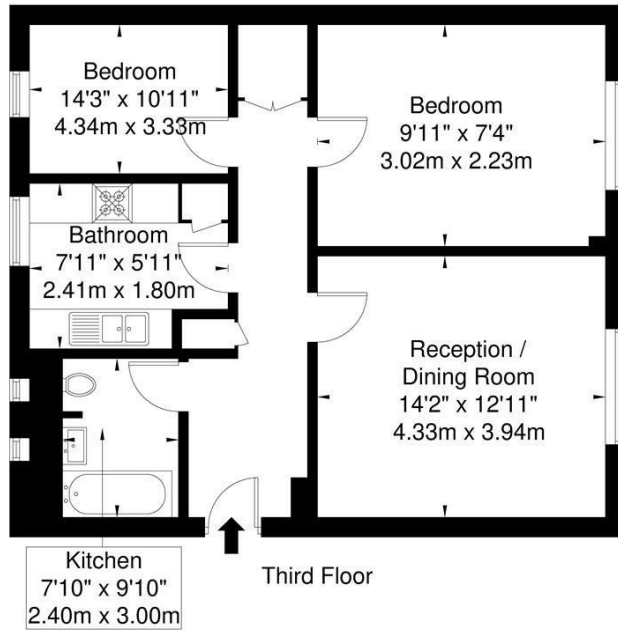

Ref _____ Copyright THEBLÉUPLAN
 Disclaimer : Floor plan measurements are approximate and are for illustrative purposes only
 While we do not doubt the floor plan accuracy and completeness, you or your advisors should
 conduct a careful, independent investigation of the property in respect of monetary valuation

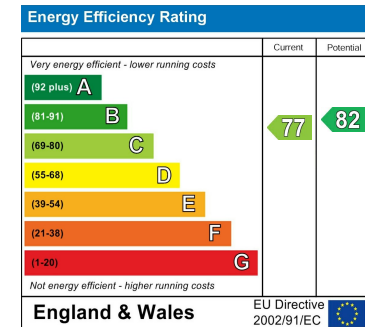

Agents Note: Whilst every care has been taken to prepare these particulars, they are for guidance purposes only. All measurements are approximate and are for general guidance purposes only and whilst every care has been taken to ensure their accuracy, they should not be relied upon and potential buyers/tenants are advised to recheck the measurements

London
 PMP International
 1 Northway's Parade Finchley Road
 London
 NW3 5EN

020 7701 2878
 info@pmpi.co.uk
 www.pmpi.co.uk

PMP | INTERNATIONAL