



## FLAT 4, 101, JEYGROVE COURT HATTON GARDEN

LONDON, EC1N 8LB

£595,000  
LEASEHOLD

Exceptional well proportioned property in the heart of London's iconic Hatton Garden, moments from Farringdon tube station and Farringdon Thameslink. Currently rented until September 2024 this property generates an excellent return. With scope for refurbishment the property would make an excellent city "pad" for young professionals or a high end investment property.

Enquire promptly to avoid disappointment.

**PMP** | INTERNATIONAL

**JEYGROVE COURT, HATTON GARDENS  
LONDON EC1N**

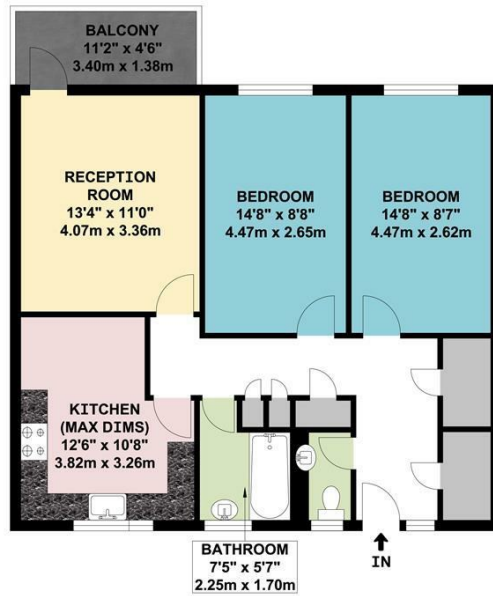

**FOURTH FLOOR FLAT**

APPROX. GROSS INTERNAL FLOOR AREA 757.67 SQ. FT / 70.39 SQ. M  
 APPROX. GROSS INTERNAL FLOOR AREA INCLUDING BALCONY 808.15 SQ. FT / 75.08 SQ. M  
 WHILST EVERY ATTEMPT HAS BEEN MADE TO ENSURE THE ACCURACY OF THE FLOOR PLAN CONTAINED HERE,  
 MEASUREMENTS OF DOORS, WINDOWS, ROOMS AND ANY OTHER ITEMS ARE APPROXIMATE AND NO RESPONSIBILITY  
 IS TAKEN FOR ANY ERROR, OMISSION, OR MIS-STATEMENT. THIS PLAN IS FOR ILLUSTRATIVE PURPOSES ONLY  
 AND SHOULD BE USED AS SUCH, BY ANY PROSPECTIVE PURCHASER.  
 FLOOR PLANS ARE NOT DONE TO "SCALE".

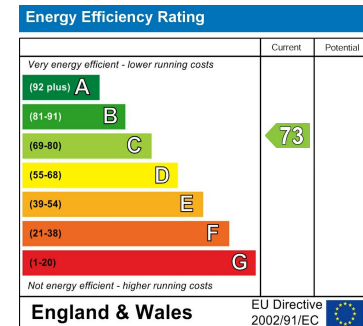

Agents Note: Whilst every care has been taken to prepare these particulars, they are for guidance purposes only. All measurements are approximate and are for general guidance purposes only and whilst every care has been taken to ensure their accuracy, they should not be relied upon and potential buyers/tenants are advised to recheck the measurements

London  
 PMP International  
 1 Northway's Parade Finchley Road  
 London  
 NW3 5EN

020 7701 2878  
 info@pmpi.co.uk  
 www.pmpi.co.uk

**PMP** | INTERNATIONAL