



LORNE CLOSE

LONDON, NW8

£465,000
LEASEHOLD

Welcome to this charming apartment located in Lorne Close, London. This purpose-built property boasts a delightful reception room, perfect for entertaining guests or simply relaxing after a long day. With one spacious bedroom, this apartment offers a cosy retreat from the hustle and bustle of the city.

Built in 2000, this modern apartment features a well-designed layout spanning 538 sq ft, providing ample space for comfortable living. The highlight of this property is the lovely balcony, where you can enjoy your morning coffee or unwind in the evening while taking in the views of the surrounding area.

Don't miss out on the chance to own a piece of London living at its finest. Contact us today to arrange a viewing and experience the charm of this wonderful property for yourself.

PCM SERVICE CHARGE £207.18 PCM

PMP | INTERNATIONAL

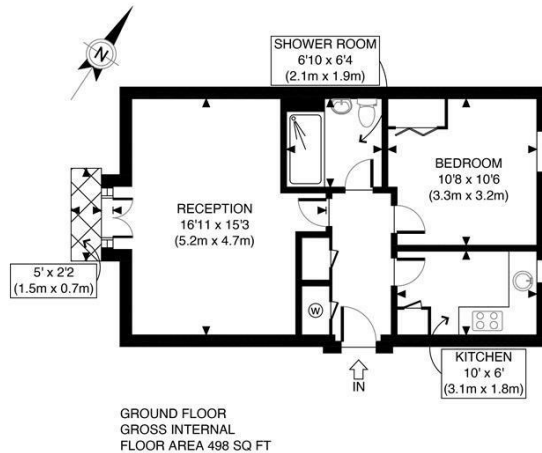

APPROX. GROSS INTERNAL FLOOR AREA 498 SQ FT / 46 SQM	Monroe House
Disclaimer: Floor plan measurements are approximate and are for illustrative purposes only. While we do not doubt the floor plan accuracy and completeness, you or your advisors should conduct a careful, independent investigation of the property in respect of monetary valuation	date 30/04/24
	photoplan

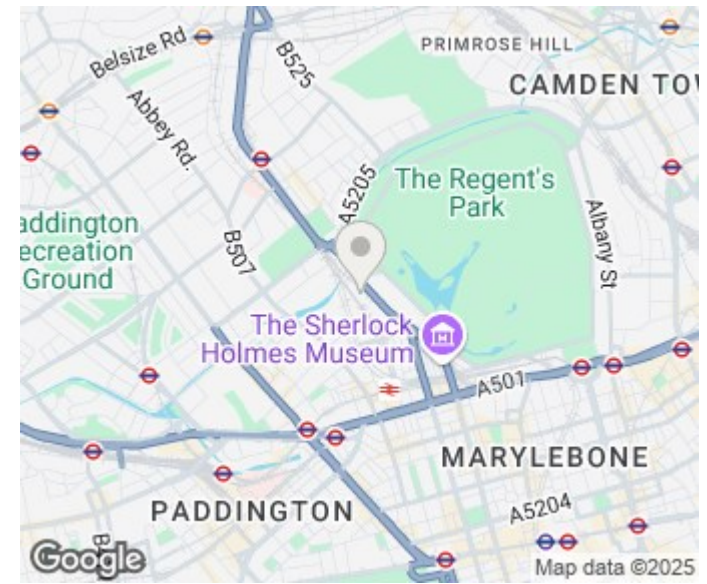

Energy Efficiency Rating		
	Current	Potential
Very energy efficient - lower running costs		
(92 plus) A		
(81-91) B		
(69-80) C	71	71
(55-68) D		
(39-54) E		
(21-38) F		
(1-20) G		
Not energy efficient - higher running costs		
England & Wales	EU Directive 2002/91/EC	

Agents Note: Whilst every care has been taken to prepare these particulars, they are for guidance purposes only. All measurements are approximate and are for general guidance purposes only and whilst every care has been taken to ensure their accuracy, they should not be relied upon and potential buyers/tenants are advised to recheck the measurements

London
PMP International
94 Belsize Lane
Belsize Park
London
NW3 5BE

020 7701 2878
info@pmpi.co.uk
www.pmpi.co.uk

PMP | INTERNATIONAL