



BEAUFORT SQUARE

LONDON, NW9

£595,000
LEASEHOLD

Stunning 2 bedroom apartment with modern features and neutral colours, offering ample storage and natural daylight which shines through the glass doors in the reception room.

This apartment is equipped with integrated audio sound systems, along with a custom designed kitchen and luxury bathrooms.

Closest to Colindale Station which is only a short walk away.

PMP | INTERNATIONAL

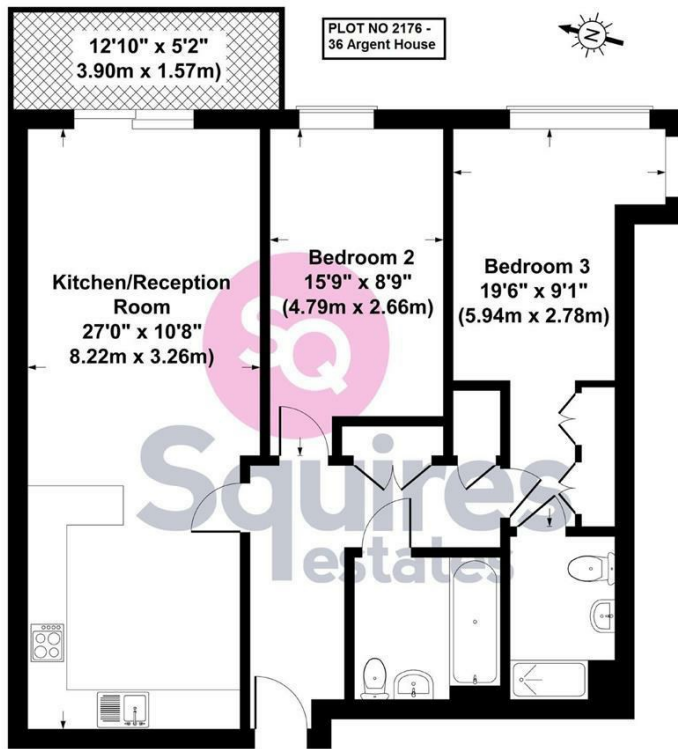

Fourth Floor
Argent House, London, NW9
Gross internal area 879 sq ft/82 sq metres
 Not to Scale. Produced by The Plan Portal 2018
For Illustrative Purposes Only.



Energy Efficiency Rating		
	Current	Potential
Very energy efficient - lower running costs		
(92 plus) A		
(81-91) B		
(69-80) C		
(55-68) D		
(39-54) E		
(21-38) F		
(1-20) G		
Not energy efficient - higher running costs		
England & Wales	EU Directive 2002/91/EC	

Agents Note: Whilst every care has been taken to prepare these particulars, they are for guidance purposes only. All measurements are approximate and are for general guidance purposes only and whilst every care has been taken to ensure their accuracy, they should not be relied upon and potential buyers/tenants are advised to recheck the measurements

London
 PMP International
 1 Northway's Parade Finchley Road
 London
 NW3 5EN

020 7701 2878
 info@pmpi.co.uk
 www.pmpi.co.uk

PMP | INTERNATIONAL