

oakheart



£115,000

By Auction
The Street, Brent Eleigh

Situated in the charming village of Brent Eleigh, this well-presented one-bedroom first-floor apartment offers surprisingly spacious accommodation, a generous private garden, and is offered with no onward chain.

Tucked away in a quiet residential setting, the property is accessed via a shared entrance hall and opens into a private hallway leading to all rooms. The kitchen is finished in a sleek contemporary style, featuring white wall and base units,

stone-effect worktops, an inset sink with bronze mixer tap, and space for appliances. The bright and airy living room offers ample space for furniture and benefits from a front-facing window and spot lighting.

The double bedroom overlooks the rear garden and includes a built-in storage cupboard. A well-sized bathroom completes the accommodation, comprising a panelled bath with shower over, wash hand basin, and low-level WC.

Outside, the property boasts a larger-than-average rear garden, mainly laid to lawn, along with a secure brick-built storage shed—perfect for outdoor storage.

Ideal for first-time buyers, investors or those looking for a peaceful village retreat.

Contact Oakheart today to arrange your viewing.









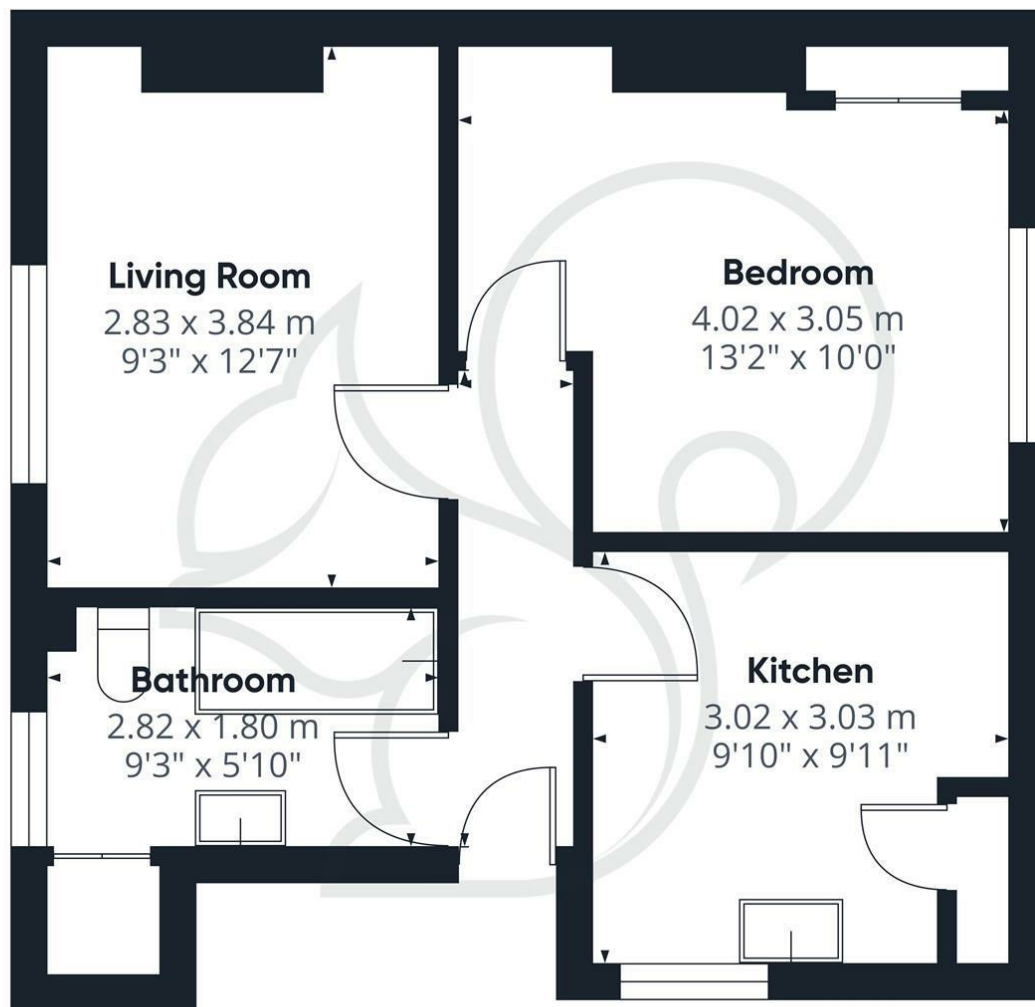

oakheart

Approximate total area⁽¹⁾

41.4 m²
445 ft²

(1) Excluding balconies and terraces

Calculations reference the RICS IPMS 3C standard. Measurements are approximate and not to scale. This floor plan is intended for illustration only.

GIRAFFE360

Local Authority:

Tenure:
Leasehold

Council Tax Band:

Energy Efficiency Rating

	Current	Potential
Very energy efficient - lower running costs		
(92 plus) A		
(81-91) B		
(69-80) C		
(55-68) D		
(39-54) E		
(21-38) F		
(1-20) G		
Not energy efficient - higher running costs		
England & Wales	EU Directive 2002/91/EC 	

Agents Note: Whilst every care has been taken to prepare these particulars, they are for guidance purposes only. All measurements are approximate and are for general guidance purposes only and whilst every care has been taken to ensure their accuracy, they should not be relied upon.

Oakheart Sudbury
01787 322 322
sudbury@oakheart.co.uk
18 Market Hill, Sudbury, Suffolk, CO10 2EA

oakheart